

nVent LENTON Form Saver Anchor



The nVent LENTON Form Saver Anchor mechanical reinforcing bar splicing system provides a method of splicing reinforcing bar in segmental concrete construction applications that have limited space or are severely congested. The coupler is friction forged to the headed anchor/shear stud.

Typically used in wall applications, the nVent LENTON Form Saver Anchor easily attaches to the front wall form panel and fits into the wall reinforcement mat more easily than a hooked reinforcing bar. When the form is stripped, the protected threaded end of the coupler is exposed on the wall face. Simply remove the protective cap, install the nVent LENTON taper threaded dowel bar. This system eliminates hooked bar congestion, protruding dowels and the need to drill holes in expensive formwork.

功能

The headed anchor/shear stud is C-1010/C-1020 AWS D1.1 and ASTM®-A108 compliant

Durable mounting plates allow for easy attachment to forms

Built-in thread cover or screw-in plug protects internal threads from concrete paste contamination

技术参数

完成: 普通

材料: 钢

Table 1/2

物料号	钢筋尺寸, 公制	钢筋尺寸, 美国	钢筋尺寸, 加拿大	六角宽度 (W)	直径 1 (Ø1)	直径 2 (Ø2)
EP4X6	12 mm	#4	10M	22 mm	16 mm	32 mm
EP4X7	12 mm	#4	10M	22 mm	16 mm	32 mm

物料号	钢筋尺寸, 公制	钢筋尺寸, 美国	钢筋尺寸, 加拿大	六角宽度 (W)	直径 1 (Ø1)	直径 2 (Ø2)
EP4X8	12 mm	#4	10M	22 mm	16 mm	32 mm
EP5X6	16 mm	#5	15M	22 mm	19 mm	32 mm
EP5X7	16 mm	#5	15M	22 mm	19 mm	32 mm

Table 2/2					
物料号	高度 (H)	长度 (L)	杆深 (BD)	联轴器主体 (CB)	单位重量
EP4X6	57 mm	146mm	21mm	43mm	0.36 kg
EP4X7	57 mm	172mm	21mm	43mm	0.41 kg
EP4X8	57 mm	206mm	21mm	43mm	0.45 kg
EP5X6	57 mm	156mm	29mm	49mm	0.45 kg
EP5X7	57 mm	181mm	29mm	49mm	0.51 kg

其他产品详情

Bar dimensions and weights listed may vary by region. Coupler sizes not shown may be available by special order. Contact your nVent LENTON representative for more information.

Minimum embedment length required to develop 125% of minimum specified yield on ASTM® A-615 Grade 60 reinforcing steel in 3000–5000 psi (20-30 MPa) concrete (based on ASME/ACI codes).

图

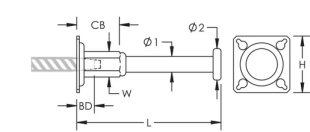

警告

应仅根据 nVent 的产品说明书与培训材料安装并使用 nVent 的产品。可访问 www.nvent.com 获取说明书，或者向您的 nVent 客服代表索取。错误安装、使用不当、滥用或未能完全遵守 nVent 的说明与警告，可能会造成产品故障、财产损失、严重的人身伤害及死亡和/或使得保修服务无效。

北美	欧洲	欧洲	亚太地区
+1.800.753.9221	荷兰：	德国：	上海：
，按 1 转客户服务	+31 800-0200135	800 1890272	+ 86 21 2412 1618/19
，按 2 转技术支持	法国：	其他国家/地区：	悉尼：
	+33 800 901 793	+31 13 5835404	+61 2 9751 8500



我们强大的品牌组合：

CADDY ERICO HOFFMAN ILSCO SCHROFF TRACHTE