

EAT300 Assembly Table

Panel Shop Automation | Ergonomic Material Handling Line

Installation and Operating Instructions



TABLE OF CONTENTS

Symbols used	3
Important safety information	3
Receiving the EAT300 Assembly table.....	4
Technical information	4
Description	4
Operation	5
Before you start – control box RESET	5
Height and tilt adjustment	5
Adjusting the work surface	6
Adjusting the width – Mounting plate on the lower extension piece	6
Adjusting the width – Mounting plate on the upper extension piece	6
Removing the mounting plate (regular operation)	6
Optional assembly table clamping system EATCS01, EATCS02	7
Optional assembly table clamping system EATST03/MTS09W	9
Optional assembly table extension, width – EATEK00	12
Optional assembly table extension, height – EATEK01.....	13
Maintenance	16
Safety and maintenance remarks.....	16
Troubleshooting	16
CE Declaration of Conformity	17
Notes	19

The nVent HOFFMAN EAT300 Assembly table is used for assembling and wiring mounting plates up to a maximum size of 1950 (H) x 1250 mm (W).

This manual is intended to familiarize users with the safe operation and maintenance for the EAT300 Assembly table. It is recommended to keep all the supplied documents in a safe place for future use.

Compliance with all instructions and observance of the prescribed operating conditions constitute part of proper use.

DISCLAIMERS:

READ AND UNDERSTAND ALL OF THE INSTRUCTIONS AND SAFETY INFORMATION IN THIS MANUAL BEFORE OPERATING OR SERVICING THIS EQUIPMENT.

NVENT ELECTRIC PLC SHALL NOT BE LIABLE FOR DAMAGES RESULTING FROM MISAPPLICATION OR MISUSE OF ANY PRODUCTS.

WE RESERVE THE RIGHT TO MAKE UNANNOUNCED TECHNICAL CHANGES TO THIS PRODUCT AS PART OF OUR CONTINUOUS IMPROVEMENT PROCESS.

SYMBOLS USED



This symbol is used to call your attention to hazards or unsafe practices which could result in an injury or property damage. The signal word, defined below, indicates the severity of the hazard. The message after the signal word provides information for preventing or avoiding the hazard.

IMPORTANT SAFETY INFORMATION



Do not OVERLOAD the assembly table.
Maximum allowed load weight is 350 kg or 772 lbs.



Do not sit or stand on the assembly table.



Ensure all the table wheels are locked or otherwise unable to rotate before mounting any object on the table.



Ensure all parts and components on the table are secured before operating the table.



Ensure that the load is evenly distributed over the entire work surface of the assembly table.



Only use the assembly table on a flat, level surface that can withstand the weight of the table, including the maximum load.



Loading and unloading must be carried out only with the table in the horizontal position.



The assembly table was designed for indoor use only. It should not be used outdoors.



The assembly table is not intended for use:

- in an environment where flammable or explosive gases or vapors are likely to occur
- by children or the infirm
- in the immediate vicinity of children



The assembly table may be operated at its rated load for a maximum of two minutes, followed by a pause of 18 minutes. Otherwise, functional failures may occur.



Do not rock, shake, bounce or otherwise agitate the table or the workpiece while the table is in use.



Do not reach or otherwise climb underneath the table while the table is in use.



Read and understand all the instructions and safety information in this manual before operating or servicing the Assembly table.



Use this product for the manufacturer's intended purpose only. Use other than which is described in this manual may result in injury or property damage.



Do not modify the product without written consent from the equipment manufacturer.

Receiving the EAT300 Assembly table

Inspect the Assembly table. Check for concealed damage that may have occurred during shipment. Look for dents, loose assemblies, etc. Damage evident upon receipt should be noted on the freight bill. Damage should be brought to the attention of the delivering carrier – not to nVent – within 15 days of delivery. Save the carton and packing material and request an inspection. Then file a claim with the delivering carrier.

nVent cannot accept responsibility for freight damages; however, we will assist you in any way possible.

Use gloves and two people to unbox the Assembly table.

Tilt down the table carefully from the transportation pallet.

Read all the instructions before using the table.

Connect the power cord to 230 VAC 50 Hz.

Reset the table. (see page 5)

Packaging

Please reuse or recycle any included packaging materials.

TECHNICAL INFORMATION

Item number		EAT300
Operational parameters		
Dimensions	Height (mm)	777
	Stroke (mm)	500
	Width (mm)	1200
	Depth (mm)	1530
Working surface	Height (mm)	1492–2150
	Width (mm)	1200
*With the assembly frame extension, a maximum working width of 21500 mm can be achieved.		
Tilt adjustment approx. degree		0–90°
Loading capacity (kg)		350
Actuator specifications		
Rated voltage (Volt)		230
Nominal load power consumption		Max. 16 A DC
Max. push force		4000 N
Duty cycle		High power cycle: 20s up, 20s down, pause 9 min. Normal power cycle: 1/9: 30s up, 30s down, pause 9 min. Normal power cycle 2/18: 2 min. move, pause 18 min.
No-load actuator speed		0 to 90° on 52s (5.8 mm/s) Bottom to top on 25s (20 mm/s)
Unit dimensions		
Footprint		W1200 D1530
Max. tabletop dimensions retracted		1485 mm (+500)
Max. tabletop dimensions extended		2145 mm (+500)
Shipping weight		
Base unit shipping weight (kg):		260

DESCRIPTION

The nVent HOFFMAN EAT300 Assembly table, with adjustable height and multi-angle tilting, makes it easier and more comfortable for workers to assemble and wire electric panels. The ergonomic design reduces unnecessary body movements, minimizes exertion and lifting, and makes it easier to reach components.

OPERATION

ALWAYS CHECK BEFORE OPERATING THE TABLE

- ✓ EAT300 parts should not be bent or twisted.
- ✓ Test the caster brakes and check the wheels for abnormal wear.
- ✓ Wipe down all moving parts weekly with a lint-free cloth to reduce dirt and debris buildup.
- ✓ Ensure the safety pin is secured, and all extensions are tightened in place.
- ✓ If there are defects, contact nVent for troubleshooting assistance.

Before you start – control box RESET

1. Ensure the table is in down position for both height and angle.
2. Press the height down button for approximately 10 seconds to lower the pillars into position.
3. If the table changes height or angle frequently within a short period, the control box may shut off. If this happens, reset the table to ensure it's ready for use again.
4. Reset the table regularly (once a week or once a month) depending on how often it's used.

Before using the table, verify the surface is free of foreign material and that the EAT300 felt surface has no rips, tears or other damage to prevent scratches or scuffing on your workpiece.

Always secure all table extensions, accessories, wires and movable parts before operating the EAT300 Assembly table.

Height and tilt adjustment

To adjust the table height and angle use the included keypad.

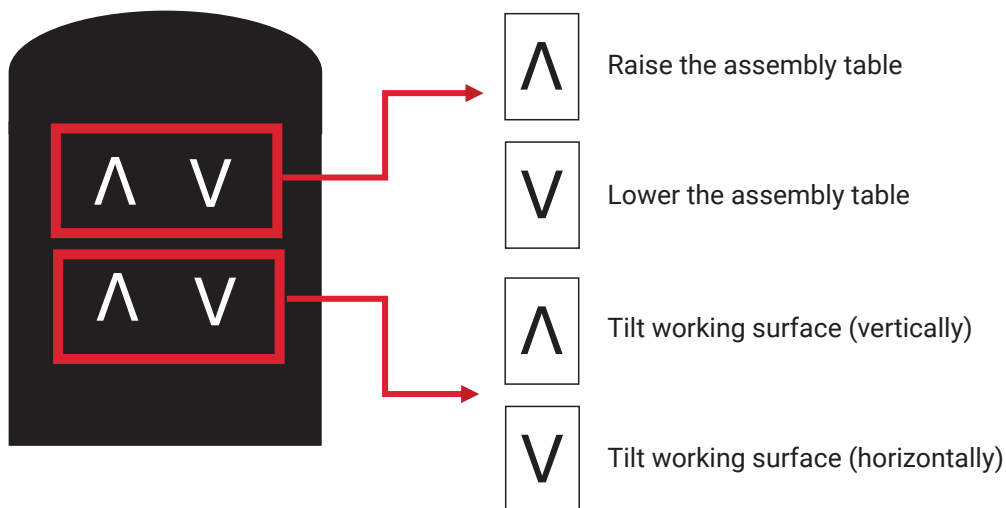

Adjusting the work surface

Adjusting the length – mounting plate

To adjust the assembly frame to fit the length of the mounting plate, follow these steps:

1. Move the work surface into the horizontal position.
2. Loosen handles of top slider on both sides and adjust to the approximate required length.
3. Place the mounting plate on the assembly table and adjust the top slider (with the holder accessory) into the desired position, ensuring the top and bottom holders securely grasp the mounting panel.
4. Retighten handles of the top slider.

The mounting panel is now secured and ready for use. (Please note: Instructions may vary slightly for different holder accessories.)

Adjusting the width – Mounting plate on the lower extension piece

To adjust the lower extension piece to fit the width of the mounting plate, follow these steps:

1. Move the work surface into the horizontal position.
2. Loosen the clamping lever and adjust the adapter plates to the required width.
3. Ensure the adapter plates are positioned so the inserted knurled screw contacts the inside of the mounting plate's U-profile.
4. After adjusting the width, retighten the clamping lever.
5. Finally, screw the knurled screws into position.

Adjusting the width – Mounting plate on the upper extension piece

To adjust the upper extension piece to fit the width of the mounting plate, follow these steps:

1. Move the work surface into the horizontal position.
2. Loosen the clamping lever and adjust the adapter plates to the required width.
3. Position the adapter plates so the inserted locking bolts contact the inside of the mounting plate's U-profile.
4. After adjusting the width, retighten the clamping lever.
5. To secure the mounting plate, pull the locking bolts back and twist the lever to the left to retract the locking bolt.
6. Insert the mounting plate and screw the locking bolt back into position.
7. Ensure the locking bolts are extended to secure the mounting plate.
8. Finally, adjust the work surface to the desired position.

Removing the mounting plate (regular operation)

To remove the finished mounting plate, follow these steps:

1. Bring the work surface to the horizontal position.
2. Release the side handles on the top slider and relieve pressure on the mounting plate by sliding it upward.
The mounting plate can now be removed.
3. Next, loosen the knurled screws on the lower extension piece.
4. Pull back and rotate the locking bolts on the upper extension piece until they remain retracted.
5. The mounting plate can now be removed.

Optional assembly table clamping system EATCS01, EATCS02

The table can be fitted with extensions to further enhance worker safety when handling heavy loads. Its versatile clamping system includes top and bottom clamps for securely attaching the mounting plate to the assembly table.

EATCS01

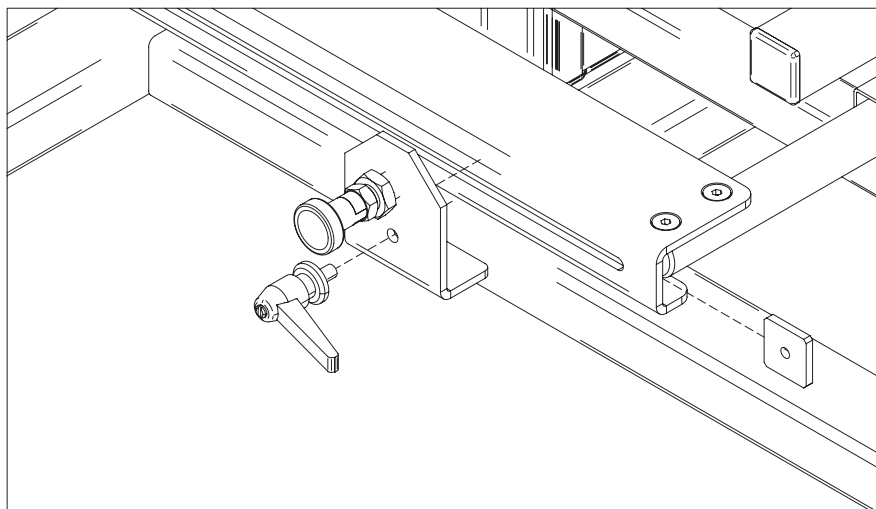
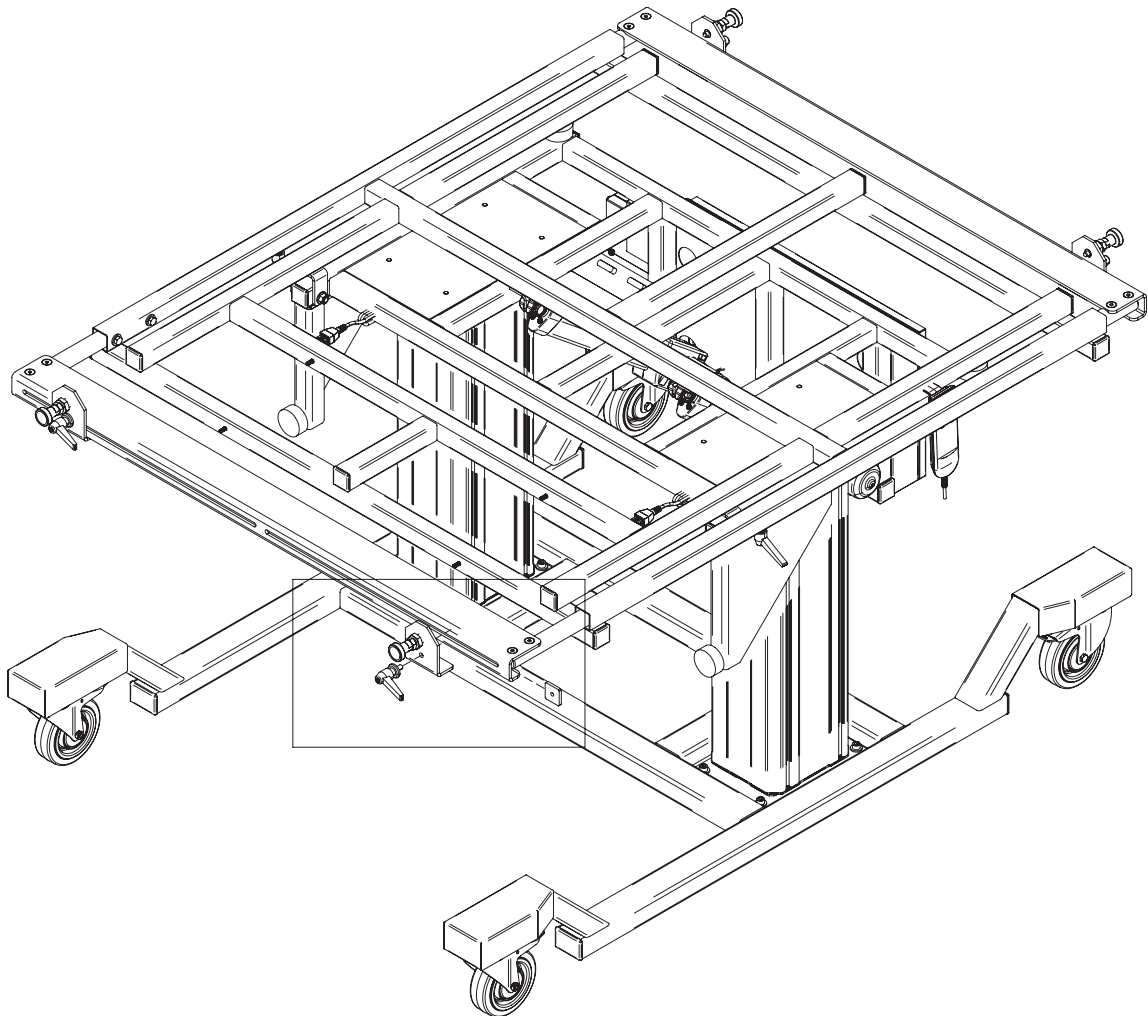

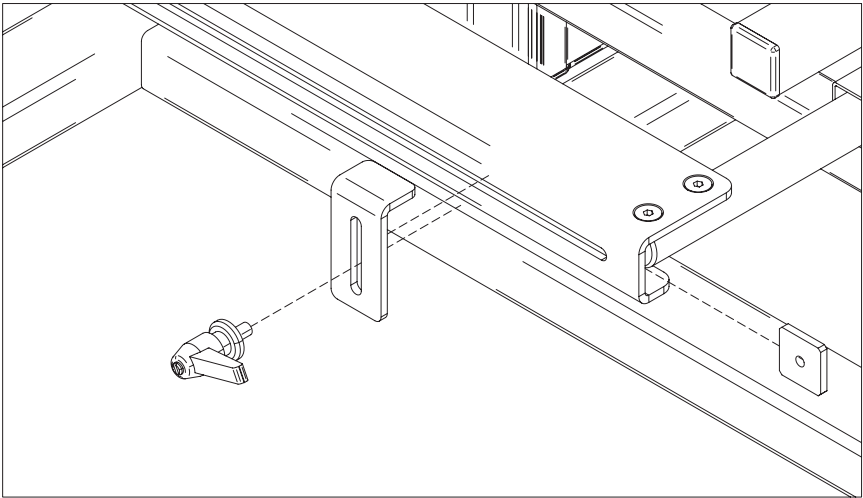
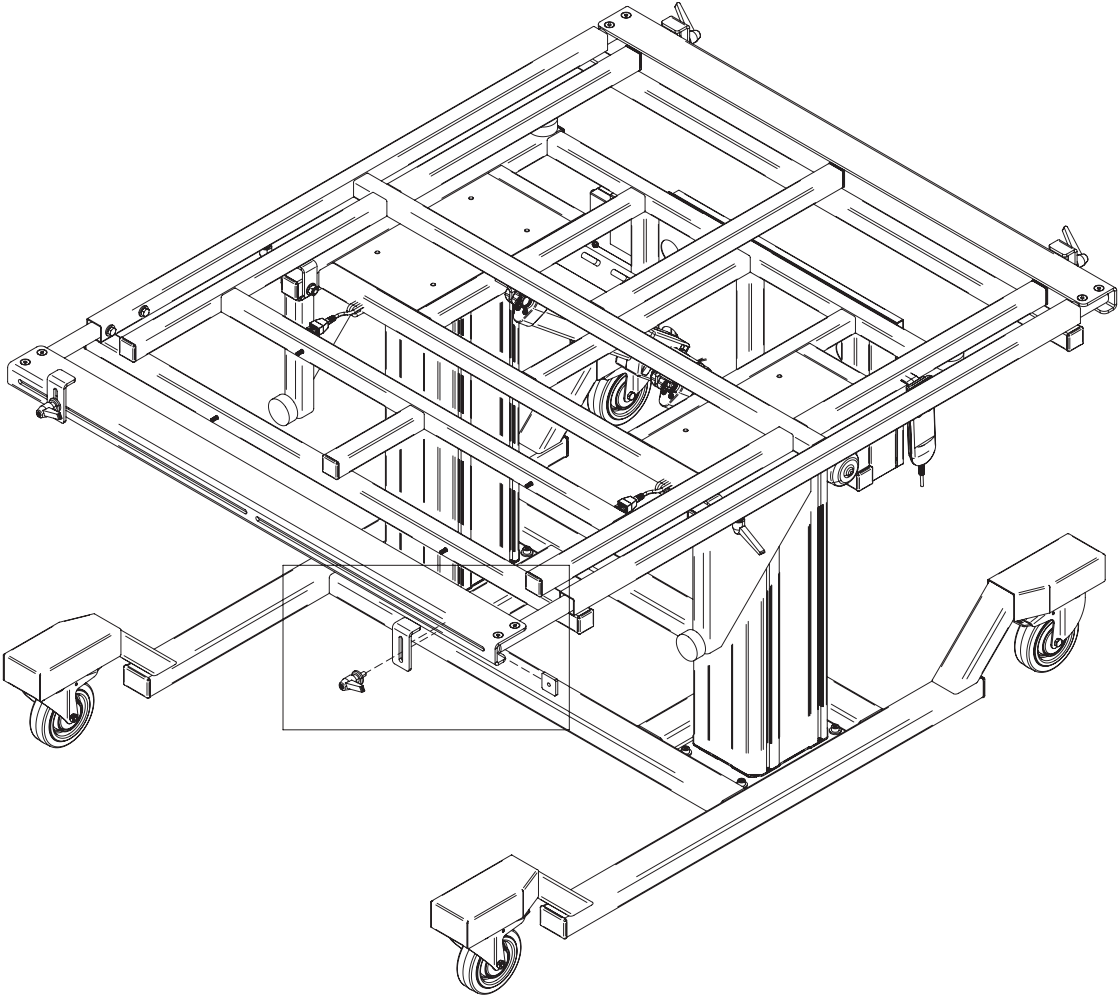

Optional assembly table clamping system EATST03/MTS09W

This option allows for securely attaching a mounting plate to the assembly table. In addition, slider profiles equipped with special rollers MTS09W make it easy to slide the assembled mounting plate sideways into the enclosure, providing extra support for heavier loads (see page 11).



EATST03

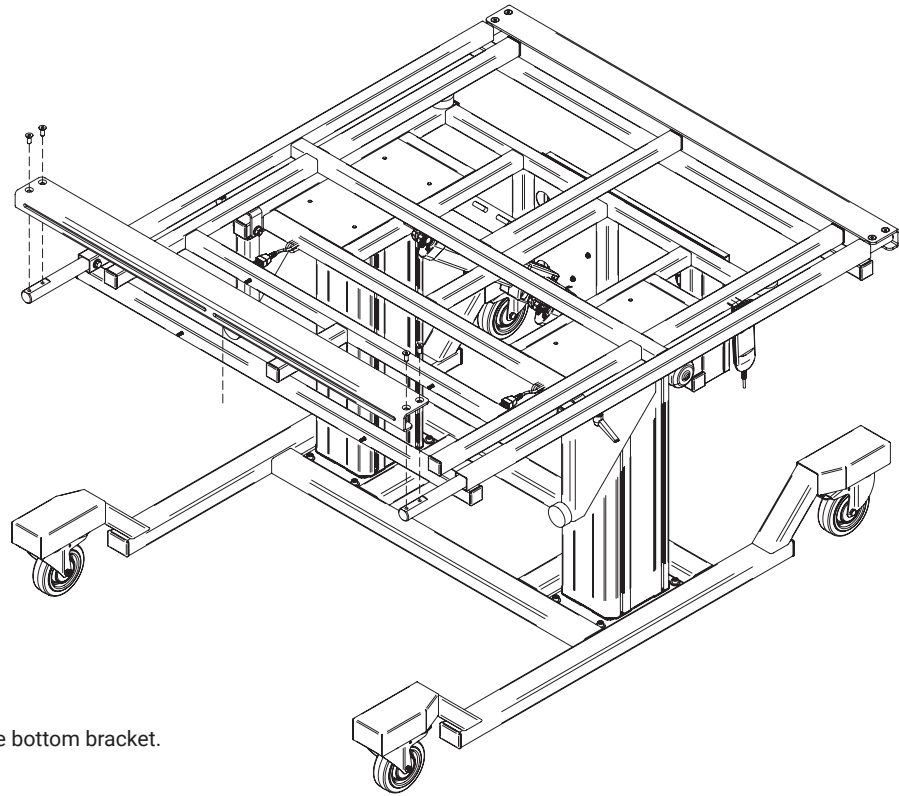

1 Remove bottom bracket.

Torque
10 Nm

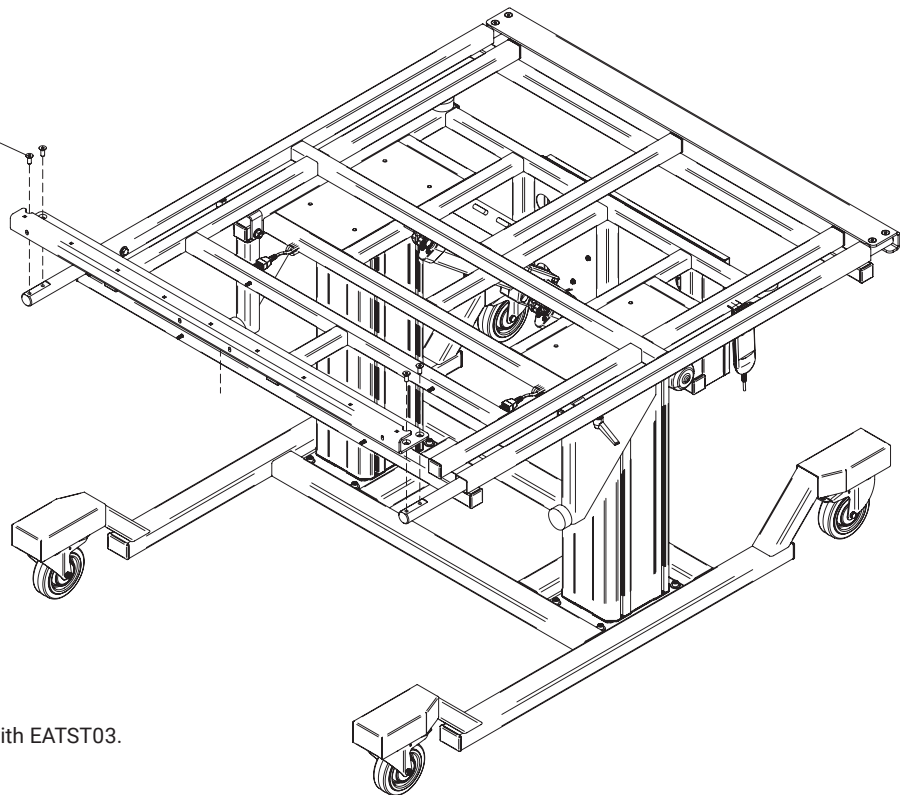

2 Replace with EATST03.

MTS09W

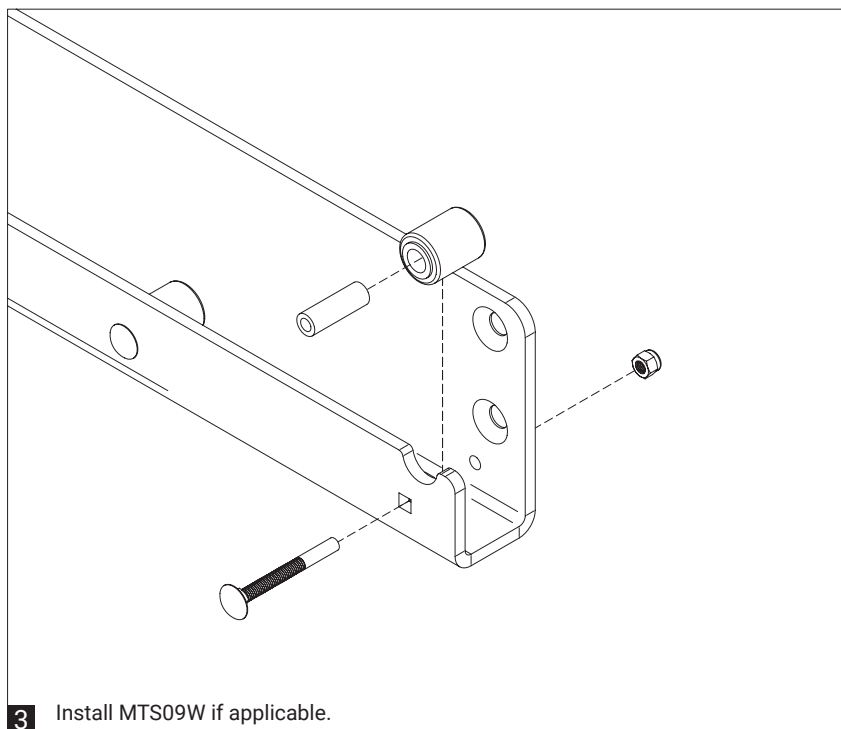
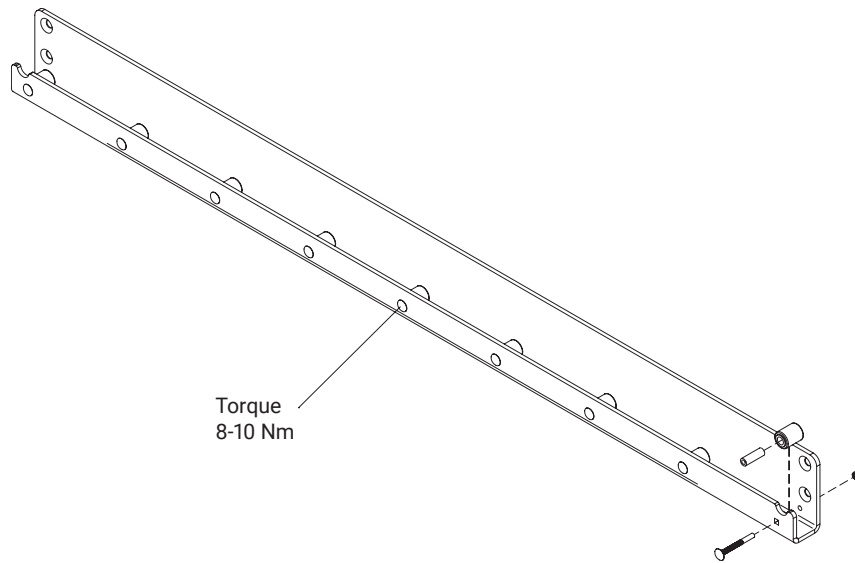

- The work surface must remain in the horizontal position until the panel is safely mounted and secured using clamps and/or other accessories.
- All load-bearing mounting hardware must be used with provided M10 mounting hardware in slotted rail extensions only. DO NOT USE any mounting hardware in standard accessory channels.
- Certain accessory mounting points may create pinch and or collision points during operation. Use common sense when mounting accessories to avoid collisions.

Optional assembly table extension, width – EATEK00

This option allows the assembly table to be widened to a maximum width of 2150 mm, enabling even very large mounting plates to be wired while seated.

The frame extension consists of left-hand and right-hand C-shaped extension pieces, which are inserted into top and bottom uprights of the EAT300 Assembly table frame. They are secured to the assembly frame with the handles included in the EATK00 accessory.

EATEK00

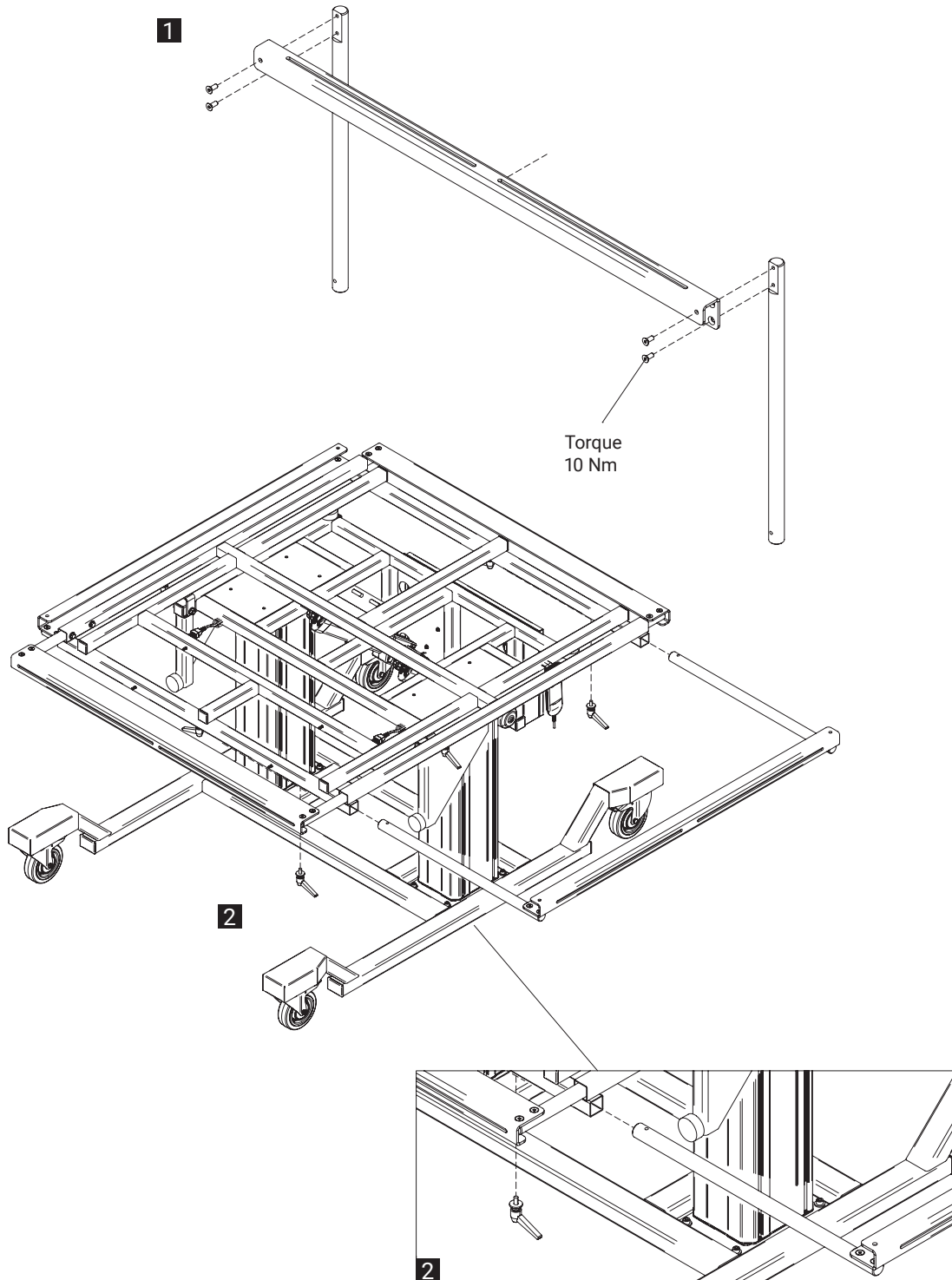

Optional assembly table extension, height – EATEK01

Designed to increase the working surface for mounting plates (under 1,600 mm in height) or provide additional support for larger panels (2,000 mm or taller), preventing bending during assembly.

EATEK01

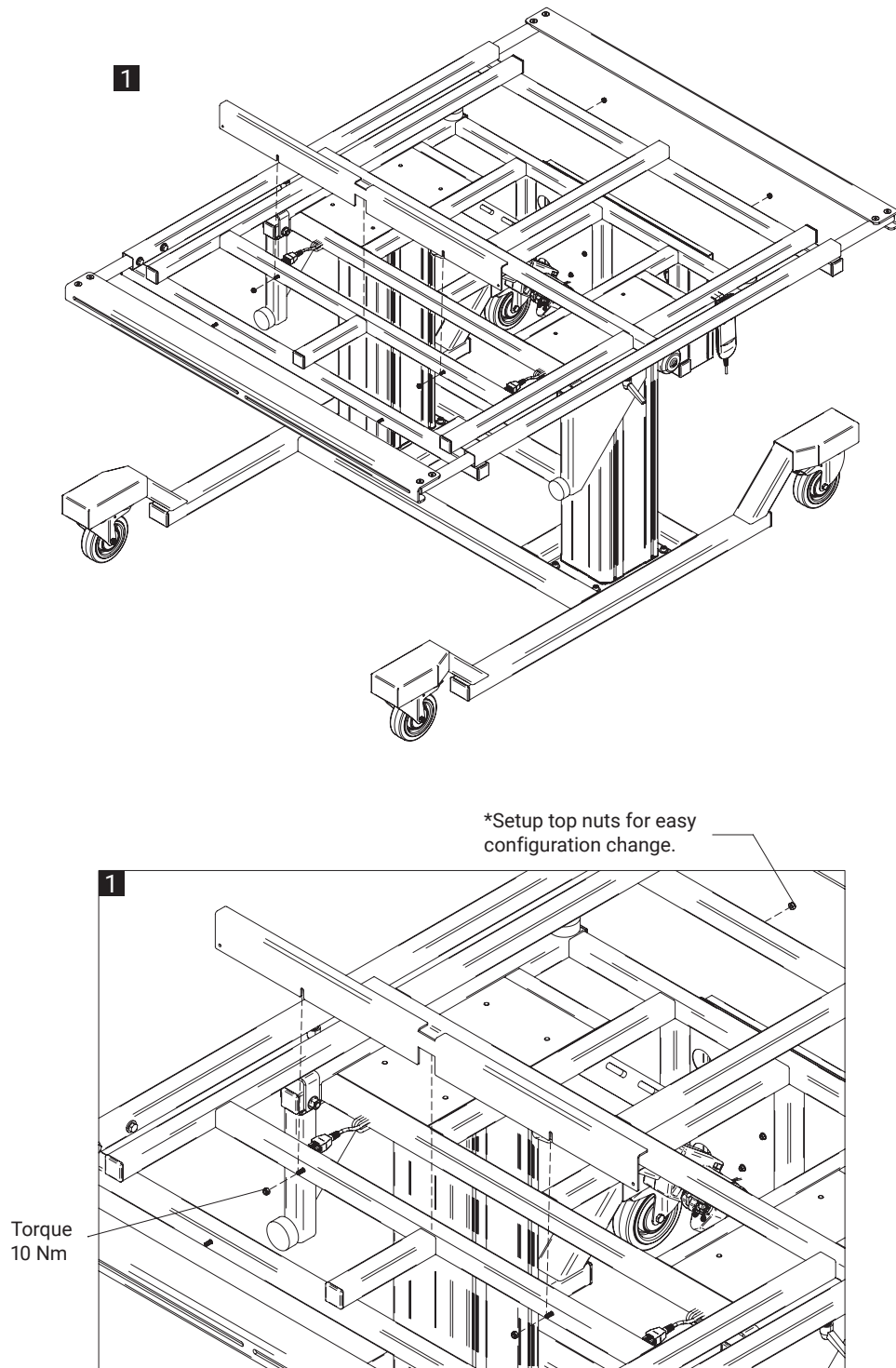

***Note:** This kit has two configurations:

1. Mounting Plate Extension for MP < 1400 mm Height.
2. Stabilizer for MP > 2000 mm Height.

EATEK01

1
MP < 1400 mm H

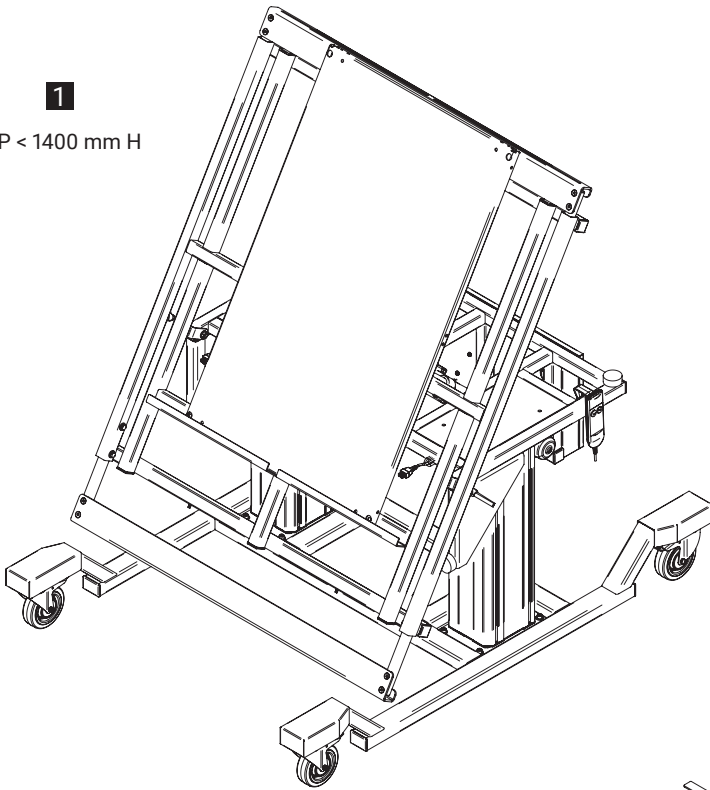

2

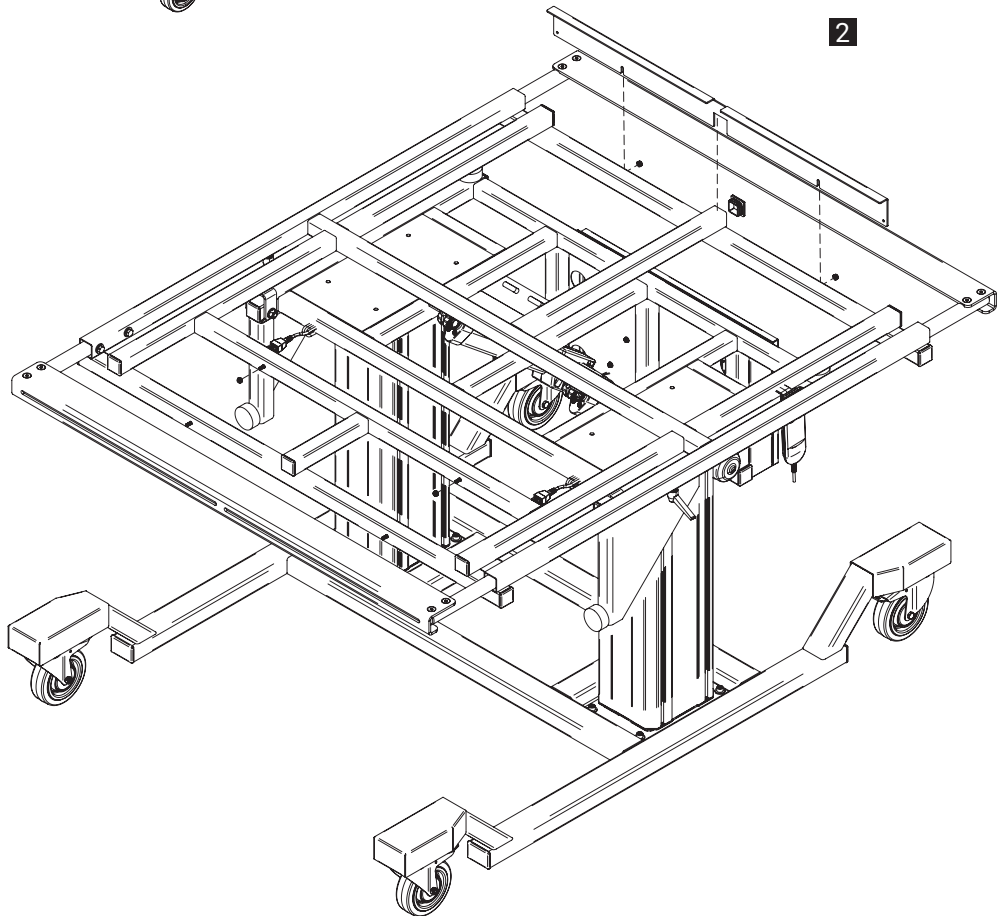

***Note:** This kit has two configurations:

1. Mounting Plate Extension for MP < 1400 mm Height.
2. Stabilizer for MP > 2000 mm Height.

EATEK01

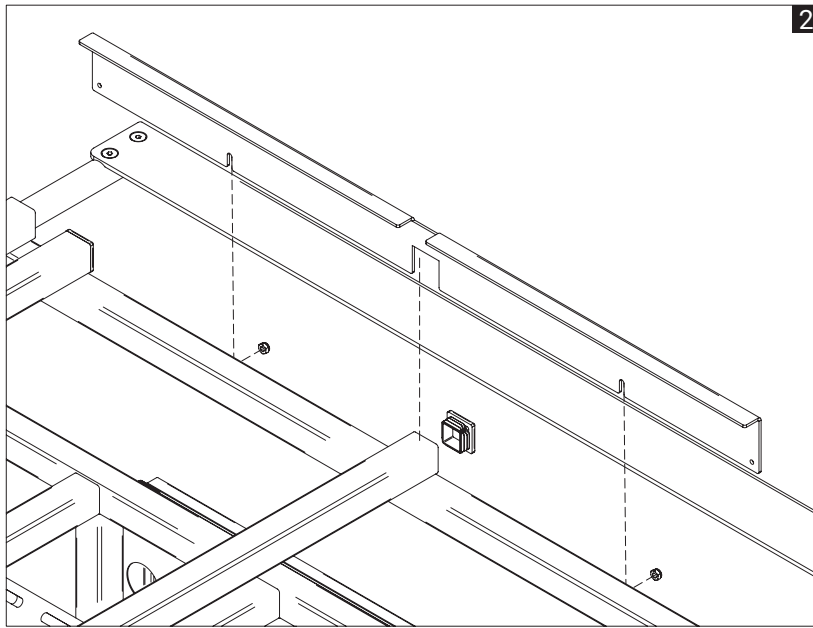

***Note:** This kit has two configurations:

1. Mounting Plate Extension for MP < 1400 mm Height.
2. Stabilizer for MP > 2000 mm Height.

MAINTENANCE

Safety and maintenance remarks

Regular repairs and maintenance are essential to prolong the service life of the assembly frame.

- Conduct regular visual inspections to check for all types of damage. Look for damaged wires, loose fittings, as well as any cracks or deformities in plastic components.
- Full inspections should be performed every six months by a qualified electrician or electrical engineer. The EAT300 Assembly table is designed to be mostly maintenance free. This six-month verification includes an in-depth visual inspection and testing both actuators to their limits under average load.
- Inspect all moving parts weekly and keep them free of debris using a dry, lint-free cloth.
- Ensure that the various parts of the assembly frame are never be bent or twisted.
- Check the brakes for proper functioning and examine the wheels for signs of wear.
- Lubricate movable, wearing parts before use, and lubricate tubing once a month.
- In the event of defects, repairs must be carried out promptly.
- Inspect the housing for cracks and breaks. Check the connection cable for crushing and shearing, and examine the strain relief with kink protector, especially after any mechanical pressure incident. For safety, any damaged connection cables must be replaced by the manufacturer or qualified experts.
- Keep all original documentation in case of future questions.

TROUBLESHOOTING

The below table identifies common faults and their solutions. For faults not listed, please contact your supplier. Troubleshooting should only be performed by a qualified engineer.

PROBLEM	POSSIBLE CAUSE	SOLUTION
Manual switch or drive system is not working. The assembly frame does not move.	<ul style="list-style-type: none">• Manual switch or drive system issue• Cable disconnected or damaged	<ul style="list-style-type: none">• Contact your supplier• Check cables and reconnect if necessary
Incorrect axis moves when correct button is activated.	<ul style="list-style-type: none">• Cables seated incorrectly• Defective keypad or control actuator	<ul style="list-style-type: none">• Check for pinched cable or other shorts• Unplug and reinsert all cables• Contact your supplier
Drives suddenly stop working.	<ul style="list-style-type: none">• Defective device fuse• Faulty controller• Disconnected or damaged cable (drives/manual switch)	<ul style="list-style-type: none">• Contact your supplier• Check cables and reconnect where necessary



Steinhauer GmbH
St. Jobser Straße 47a; D-52146 Würselen
Amtsgericht Aachen, HRB 19738

EU Declaration of Conformity

Issued by Hoffman Enclosures, Inc.
declare at our sole responsibility, that these devices are designed and constructed according
to the Essential Health & Safety requirements of the relevant European directives.

Equipment Description: EAT300, EATEK00, EATEK01, EATCS01, EATCS02, EATCS03, MTS09W

Product Name: Mounting Table

Business Trade Mark/Brand Name: Hoffman

Applicable Directives: 2023/1230/EU Machinery Directive
2014/30/EU Electromagnetic Compatibility Directive

Applicable Standards: UNI EN ISO 12100 Safety of machinery, basic concepts,
general design principles
EN 60204-1 Safety of machinery, electrical equipment
of machines Part 1: General requirements
DIN EN ISO 13850 Emergency stop function

Authorized by:

A handwritten signature in black ink, appearing to read "Tom Hurney".

Tom Hurney

Technology Mgr., Product Approvals, Compliance

3/11/2025

Date

Subject to Change Without Notice

DOC: CE-UKCA-DoC-EN_EATx Rev A



Steinhauer GmbH
St. Jobber Straße 47a; D-52146 Würselen
Amtsgericht Aachen, HRB 19738

UK Declaration of Conformity

Issued by Hoffman Enclosures, Inc.
declare at our sole responsibility, that these devices are designed and constructed according
to the Essential Health & Safety requirements of the relevant UK regulations.

Equipment Description: EAT300, EATEK00, EATEK01, EATCS01, EATCS02, EATCS03, MTS09W

Product Name: Mounting Table

Business Trade Mark/Brand Name: Hoffman

Applicable Regulations: Supply of Machinery (Safety) Regulations 2008

Electromagnetic Compatibility Regulations 2016

UK Designated Standards:

UNI EN ISO 12100	Safety of machinery, basic concepts, general design principles
EN 60204-1	Safety of machinery, electrical equipment of machines Part 1: General requirements
DIN EN ISO 13850	Emergency stop function

Authorized by:

Tom Hurney

Technology Mgr., Product Approvals, Compliance

3/11/2025

Date

Subject to Change Without Notice

DOC: CE-UKCA-DoC-EN_EATx Rev A



Our powerful portfolio of brands:

CADDY ERICO HOFFMAN ILSCO SCHROFF TRACHTE