

Sun Shade

Installation Instructions

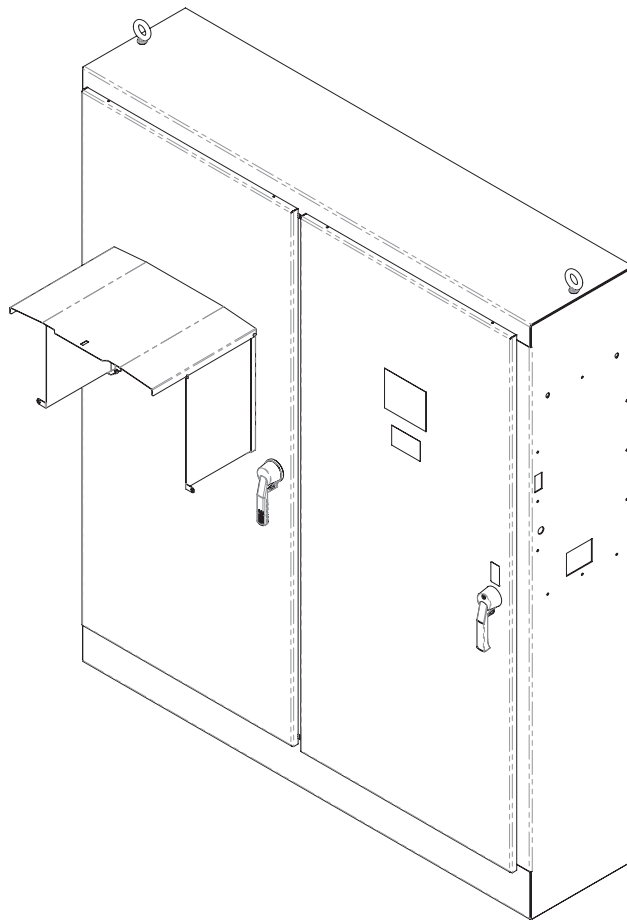

STEP 1: DRILLING THE ENCLOSURE PANEL

- 1. **Prepare the Panel:** Begin by preparing the enclosure panel for drilling. Ensure that the panel is clean and free from any obstructions.
- 2. **Mark the Drill Holes:** Refer to the provided drawing, where all dimensions are in inches, to determine the positions for the drill holes. The drawing includes the configuration dimensions, the mounting hole positions (X and Y), and the work area of the sun shade (A and B).
Note: Ensure that dimensions A and B are larger than the display size to properly accommodate the sun shade.
- 3. **Drill the Holes:** Using the marked positions, drill the holes in the enclosure panel as specified in the mounting hole positions (X and Y).

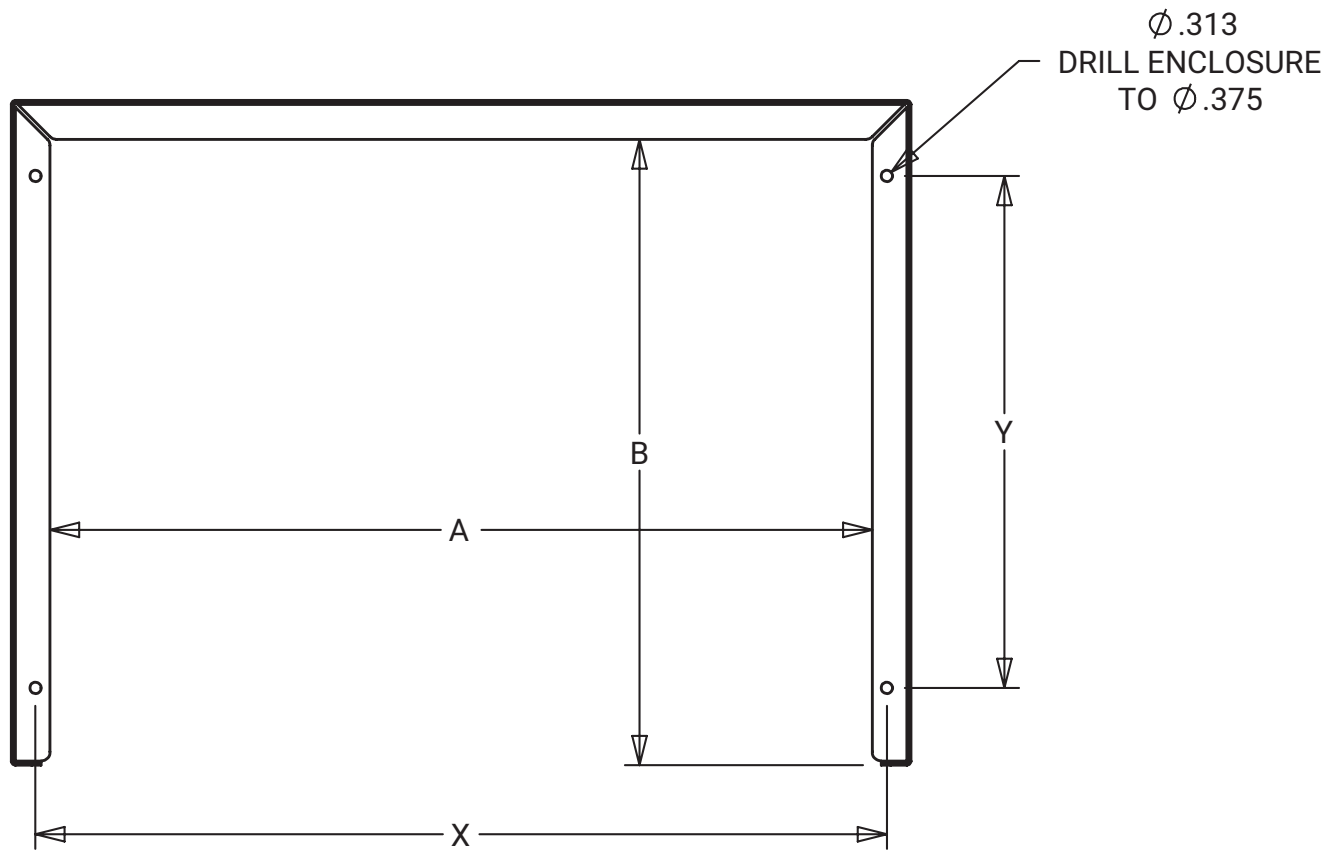

Model	A	B	X	Y
SSW08X10	10.4	8.1	11.28	5.0
SSW12X16	16.4	12.5	17.28	9.5
SSW17X22	22.4	17.1	23.28	14.0

All dimensions are in inches.

STEP 2: MOUNTING THE SUN SHADE

1. **Position the Sun Shade:** Align the sun shade (item 1) with the drilled holes on the enclosure panel.
2. **Insert Screws and Washers:** Insert the screws (item 4) and washers (item 5) through the holes in the sun shade.
3. **Insert the Spacer Washer:** Place the spacer washers (item 2) between the sun shade and the enclosure panel, ensuring they are aligned with the screws (item 4).
4. **Tighten the Nuts:** Secure the assembly by tightening the nuts (item 3) on the inside of the panel.

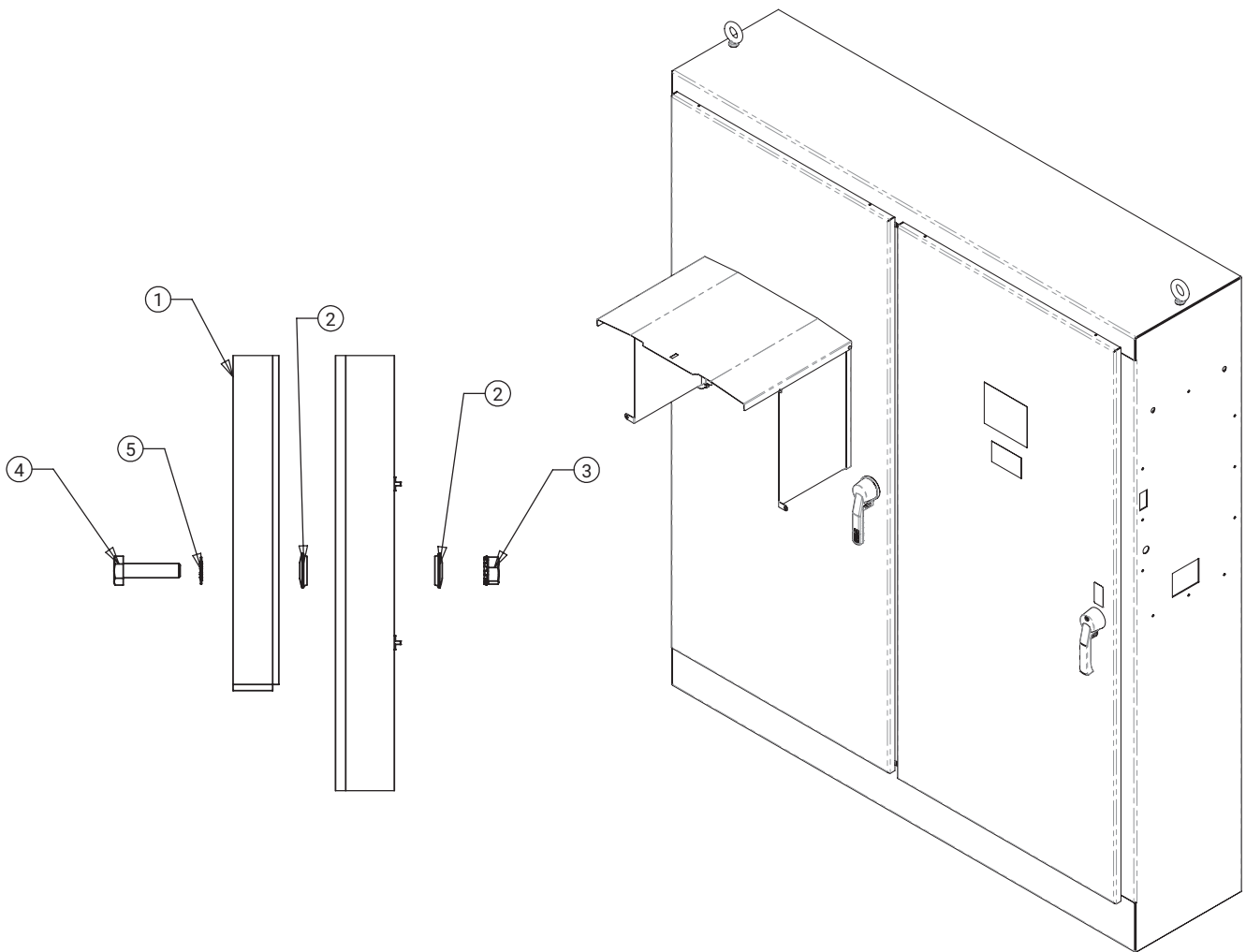
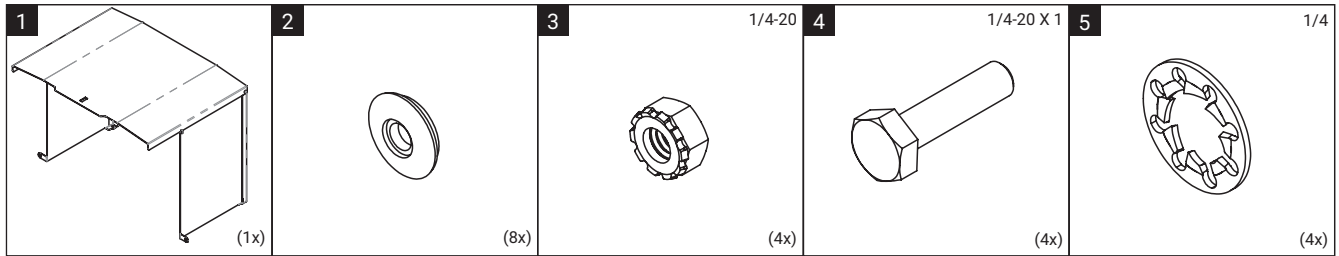

nVent
2100 Hoffman Way
Anoka, MN 55303-1745
Tel 763.422.2211



Our powerful portfolio of brands:

CADDY ERICO HOFFMAN ILSCO SCHROFF TRACHTE