

nVent ERICO PermaGround Compression Connector, Figure 6-Crimps

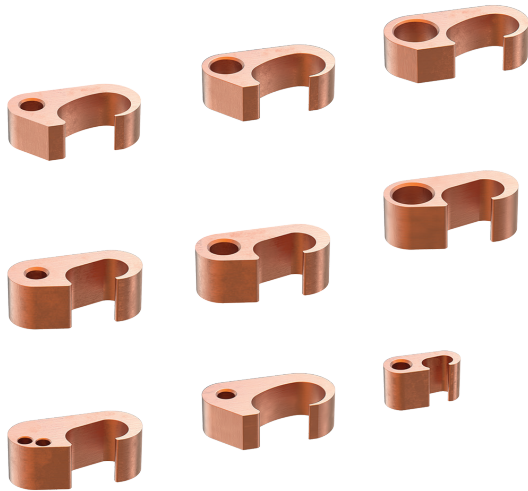

The nVent ERICO PermaGround Compression Connectors, Figure 6-Crimps, are designed to join two grounding conductors or connect a grounding conductor to a grounding rod within a grounding system using a compression tool. Made from high-strength conductive copper, they provide a low-resistance connection that prevents corrosion, ensuring durability. With their range-taking capabilities, the Figure 6-Crimps are compatible with various conductors and ground rods. To guard against oxidation, the inner surface of the Figure 6-Crimps is prefilled with an oxide inhibitor that creates an airtight seal around the conductors once the connection is made. This feature makes the Figure 6-Crimp connector suitable for a wide range of applications.

FEATURES

- Made from high-strength conductive copper for durability and maximum conductivity
- Prefilled with an oxide inhibitor to prevent oxidation and ensure a long-lasting connection
- Compatible with various conductors and ground rods, offering versatile application options
- Can be installed in all weather conditions, making it suitable for diverse environments

Material: Copper
Direct Burial: Yes



Part Number	Conductor Type	Main/Run Conductor Range	Tap Conductor Range	Main Ground Rod	Connection Type	Die Index	Length L	Width W	Height H	Unit Weight
GGC-1	Solid, Stranded	2 – 6 AWG	2 – 6 AWG	–	Conductor to Conductor	0	0.63"	0.75"	1.4"	0.119 lb
GGC-2	Solid, Stranded	250 kcmil – 1/0 AWG	2 – 4 AWG	½" – ⅝"	Conductor to Conductor, Conductor to Ground Rod	997	0.93"	0.75"	2.1"	0.273 lb
GGC-3	Solid, Stranded	250 kcmil – 1/0 AWG	2/0 – 1/0 AWG	½" – ⅝"	Conductor to Conductor, Conductor to Ground Rod	997	0.93"	0.75"	2.1"	0.256 lb
GGC-4	Stranded	250 kcmil – 1/0 AWG	250 kcmil – 3/0 AWG	½" – ⅝"	Conductor to Conductor, Conductor to Ground Rod	997	0.93"	0.75"	2.1"	0.22 lb
GGC-5	Solid, Stranded	500 – 250 kcmil	2 – 4 AWG	⅝" – ¾"	Conductor to Conductor, Conductor to Ground Rod	998	1.36"	0.75"	2.57"	0.428 lb
GGC-6	Stranded	500 – 250 kcmil	2/0 – 1/0 AWG	⅝" – ¾"	Conductor to Conductor, Conductor to Ground Rod	998	1.36"	0.75"	2.57"	0.412 lb

Part Number	Conductor Type	Main/Run Conductor Range	Tap Conductor Range	Main Ground Rod	Connection Type	Die Index	Length L	Width W	Height H	Unit Weight
GGC-7	Stranded	500 – 250 kcmil	250 kcmil – 3/0 AWG	5/8" – 3/4"	Conductor to Conductor, Conductor to Ground Rod	998	1.36"	0.75"	2.57"	0.38 lb
GGC-8	Stranded	500 – 250 kcmil	500 – 350 kcmil	5/8" – 3/4"	Conductor to Conductor, Conductor to Ground Rod	1011	1.36"	0.75"	2.89"	0.432 lb
GGC-9	Solid, Stranded	250 kcmil – 1/0 AWG	6 – 6 AWG	1/2" – 5/8"	Conductor to Conductor, Conductor to Ground Rod	997	0.94"	0.75"	2.1"	0.273 lb

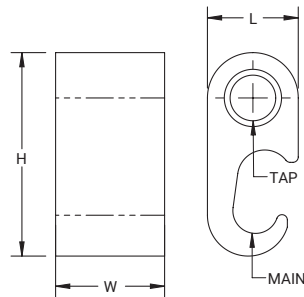

Our powerful portfolio of brands:

CADDY ERICO HOFFMAN ILSCO SCHROFF TRACHTE