

NOTES:  
1. INSTALLATION SHALL COMPLY WITH ALL APPLICABLE NATIONAL, STATE AND LOCAL CODES.  
2. PRIMARY DIMENSIONS ARE IN MILLIMETERS. SECONDARY DIMENSIONS ARE IN [INCHES]  
3. UNIVERSAL MOUNTING BRACKET IS AN ALTERNATIVE MOUNTING METHOD TO THE TOOLLESS MOUNT FOR 3RD PARTY ENCLOSURES. BRACKET IS PROVIDED WITH THE UNIT.  
4. DETAILED INSTALLATION INSTRUCTIONS CAN BE FOUND IN THE QUICK START GUIDE  
5. CONNECT EXTERNAL EARTH GROUND TOTHE 10-32 SIZE THREADED NUT  
6. SEE PRODUCT DOCUMENTATION FOR FURTHER INFORMATION  
7. INPUT PLUG CONFIGURATION (SEE IDENTIFICATION TABLE) FOR DUAL-RATED UNITS, NEMA PLUGS ARE NAM RATED ONLY AND CAPTIVE AUS/NZ PLUGS ARE EMEA RATED ONLY

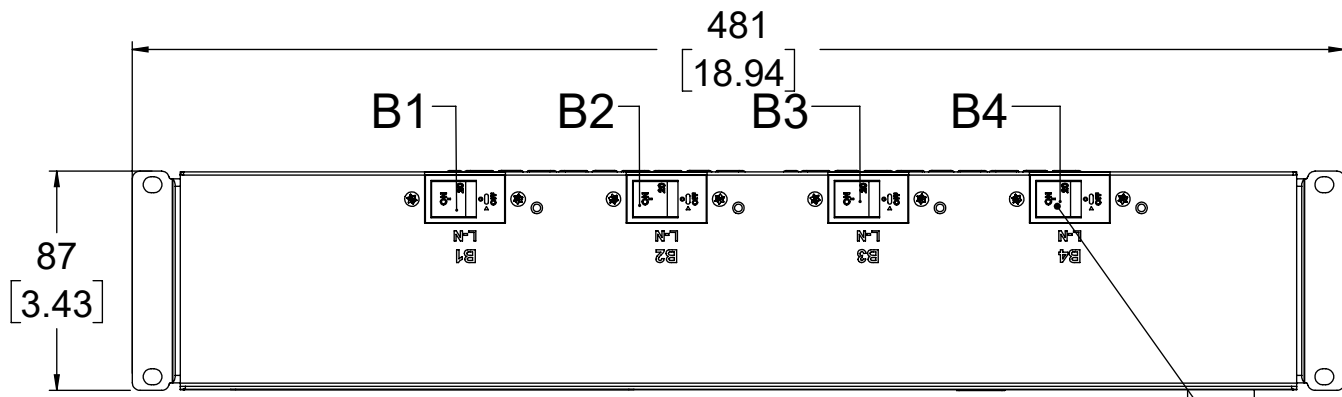

MAC LABEL DETAIL



REAR VIEW

20AMP, SINGLE-POLE, 5kAIC  
ELECTRO-MAGNETIC SWITCH/ BREAKER (4)PL

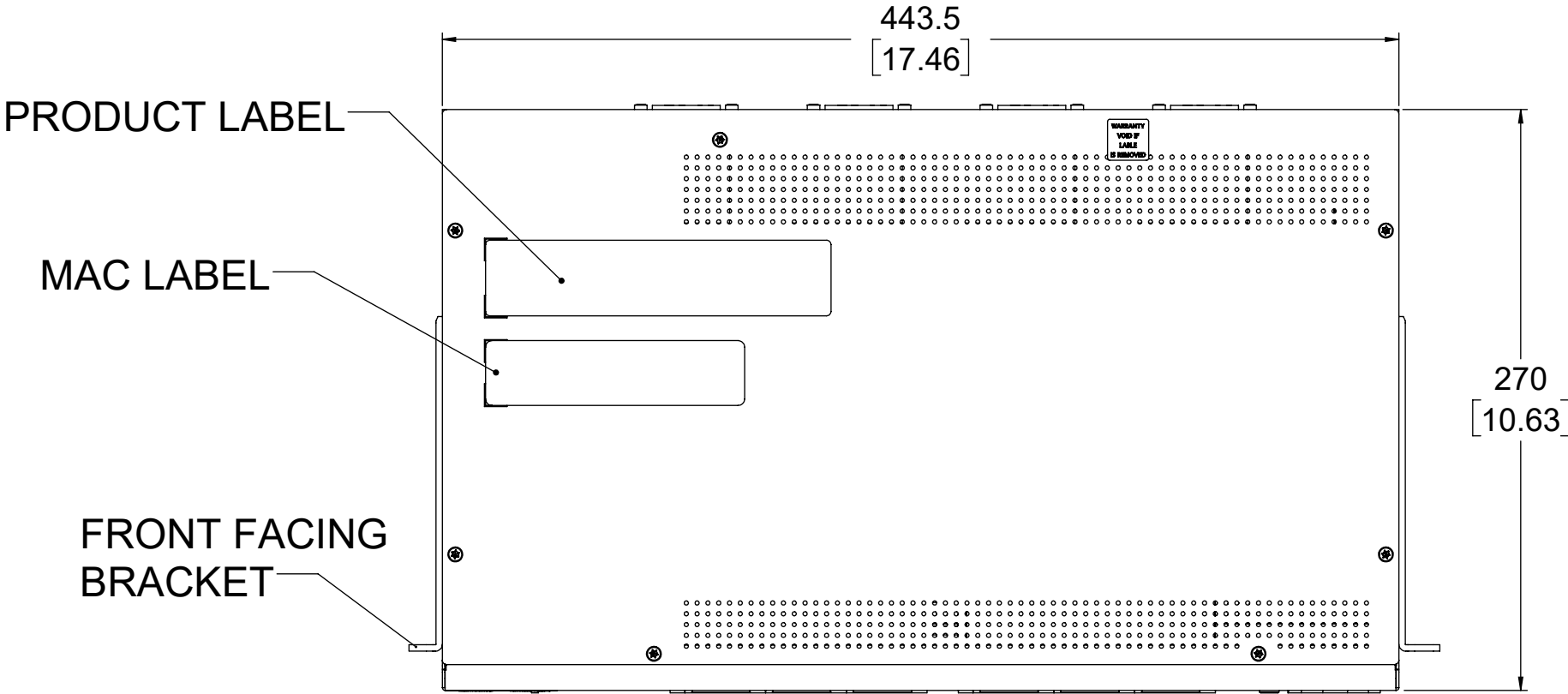

TOP VIEW

SEE SHEET 2 FOR LOAD BANK CALLOUTS

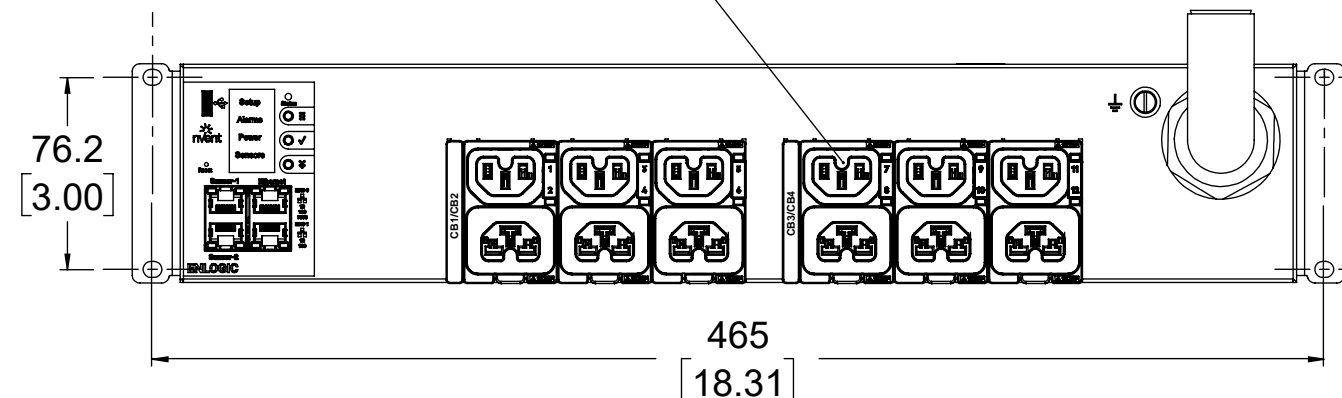

FRONT VIEW

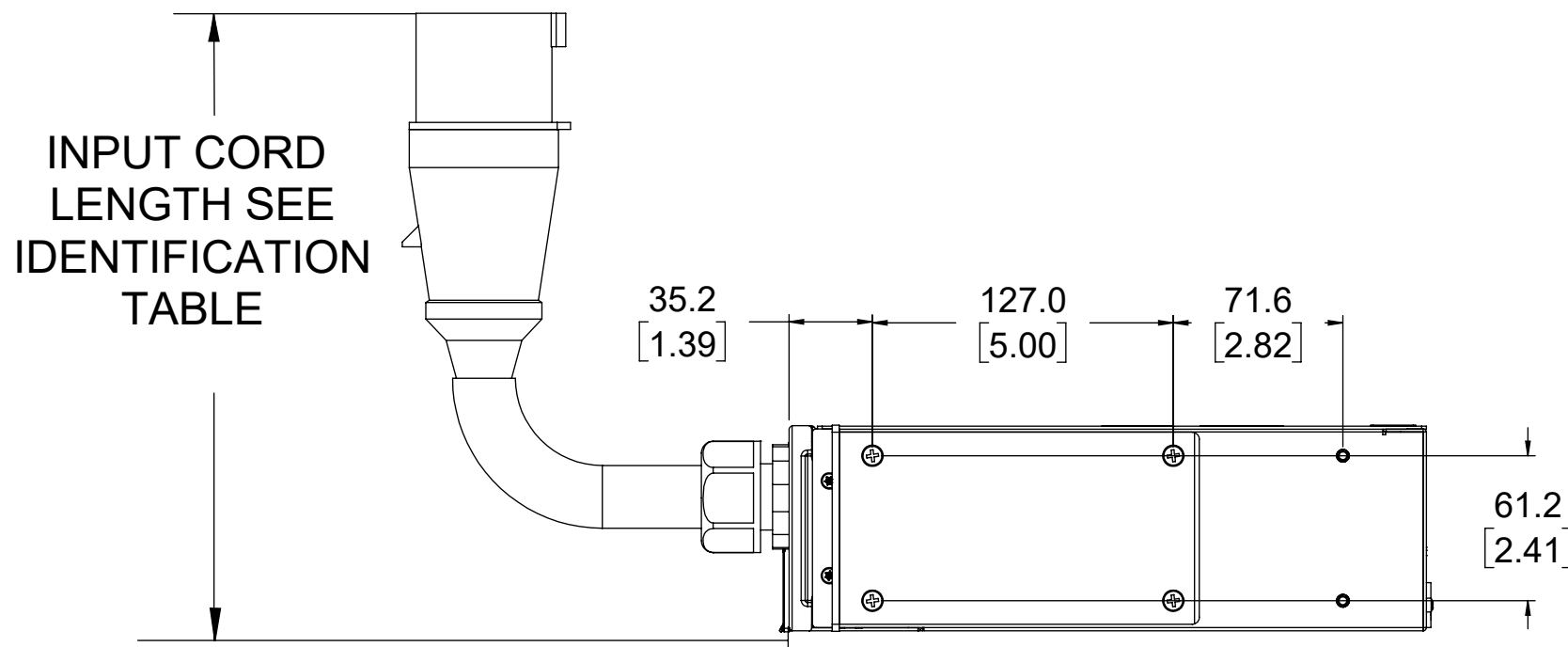

SIDE VIEW

TECHNICAL SPECIFICATIONS

UNIT TYPE:	MONITORED SWITCHED
ORIENTATION:	HORIZONTAL,2U
OUTLET QTY & TYPE:	(6)C13/C15 , (6)C13/C15/C19
INPUT VOLTAGE:	200-240VAC
INPUT CURRENT:	60A(48A DERATED)(NA)/63A(EU)
BREAKER QTY & TYPE:	(4) 20AMP, SINGLE-POLE,5kAIC
INPUT PHASE:	SINGLE-PHASE(WYE)
RATED POWER:	DUAL-RATED 11.5KVA(NA)/14.5 KVA(EU)
INPUT PLUG:	SEE IDENTIFICATION TABLE
INPUT POWER CORD:	SEE IDENTIFICATION TABLE

FEATURES

METERING ATTRIBUTES VOLTAGE(V), CURRENT(A), APPARENT POWER(kVA), REAL POWER(kW), POWER FACTOR, ENERGY(kWh)

METERED COMPONENTS	INPUT (PHASE), BREAKERS
REMOTE OUTLET SWITCHING	YES

ENVIRONMENTAL CONDITIONS

OPERATING TEMPERATURE	-5 TO 60 C (23 TO 140 F)
STORAGE TEMPERATURE	-20 TO 60 C (-4 TO 140 F)
HUMIDITY (OPERATING/STORAGE)	5-90% RH / 5-95% RH; NON-CONDENSING
MAX OPERATING ELEVATION, ABOVE MSL	3000M (9840 FT)

COMPLIANCE

SAFETY & ENVIRONMENTAL	IEC 62368-1 LISTED, FCC,CSA CE,UKCA,RoHS COMPLIANT
------------------------	--

IDENTIFICATION TABLE	EN2355 -	* INPUT PLUG	* CHASSIS COLOR	* CORD OPTION	* ORIENTATION
MODEL IS SHOWN IN DEFAULT CONFIGURATION. FOR OPTIONAL CONFIGURATIONS, USE ITEM IDENTIFIER CODE IN PLACE OF EACH ASTERISK. ORDERABLE BASED ON FORMAT: SKU NUMBER - ****		(DEFAULT) 360P6/363P6(IP44) =0 (OPTIONAL) 363P6W(IP67)=M	(DEFAULT) BLACK = 0	(DEFAULT) 3m [10'] = 0 1m [3.2'] = 1 2m [6.6'] = 2	(DEFAULT) FRONT FACING BRKT & INPUT = 0
OPTIONS LISTED ON THIS ROW ARE NON STANDARD, CONTACT SALES FOR ADDITIONAL INFORMATION			BLUE = B    RED = R WHITE = W    GREEN = G YELLOW = Y    ORANGE = A	0.5m [1.6'] = A    4.5m [14.7'] = E 1.5m [4.9'] = B    1.2m [4'] = G 2.5m [8.2'] = C    3.65m [12'] = H 3.5m [11.5'] = D    1.8m [6'] = F	



THIS DRAWING AND SPECIFICATIONS HEREIN ARE THE PROPERTY OF NVENT AND SHALL NOT BE COPIED, REPRODUCED OR USED IN WHOLE OR IN PART, AS THE BASIS FOR THE MANUFACTURE OR SALE OF ITEMS WITHOUT WRITTEN PERMISSION FROM NVENT. THIS DRAWING IS BASED UPON LATEST AVAILABLE INFORMATION AND IS SUBJECT TO CHANGE WITHOUT NOTICE

TITLE:  
ADVANTAGE SERIES  
METERED SWITCHED

PROJECT:  
ENLOGIC

UNLESS NOTED, DIMENSIONS ARE IN MILLIMETERS & TOLERANCES ARE:  
X. ±1 MM    X° ±1°  
X.X ±0.5 MM    X.X° ±0.5°  
X.XX ±0.20 MM  
ØX.X ±0.3 MM  
ØX.XX ±0.10 MM  
BRACKETED DIMENSIONS ARE IN INCHES FOR REFERENCE ONLY  
⊙--- THRID ANGLE PROJECTION  
INTERPRET PER ASME Y14.5M-1994

PART NO:	EN2355-WXYZ	REV.	E1
DRAWN BY:	Rongfeng Lu	2024-10-08	
ENGINEER:	Yuzhou Feng	2024-10-09	
APPROVED BY:	Jingbo Luo	2024-10-09	
SCALE:2:5 (DO NOT SCALE DRAWING)		SHEET 1 OF 3 A1	

DESIGN(PDU)  
ENGINEERING

	E1	INITIAL RELEASE	2024/10/08	LRF
ECN/ECO	REV.	DESCRIPTION	DATE	DRAWING BY
REVISIONS				



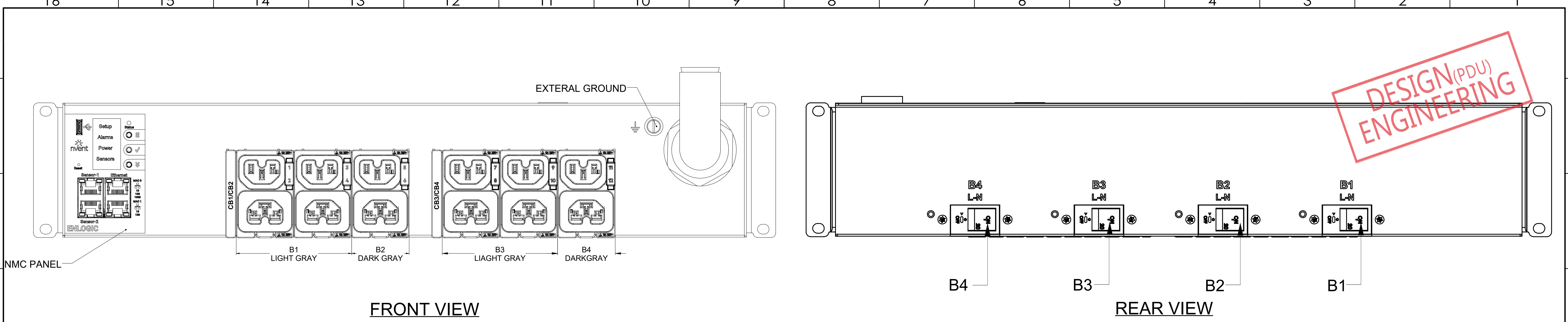

STANDARD RECEPTACLES

RECEPTACLE

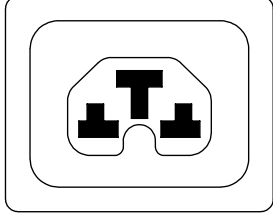
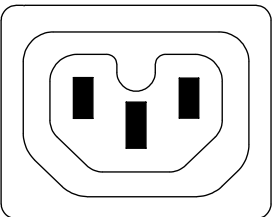

COMBO C13/C15  
10A, 250V, MAX  
RATED OUTPUT

COMBO C13/C15/C19  
16A, 250V, MAX  
RATED OUTPUT

INPUT PLUG

(DEFAULT)

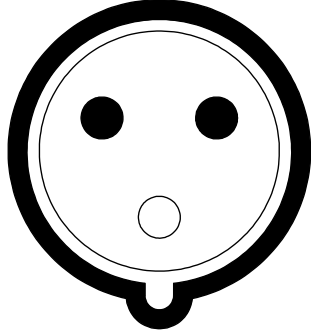

IEC 60309, 2P 3W 6H  
IP44 (SPLASHPROOF)  
250V MAX RATED INPUT  
60A(48A DERATED)/63A

OPTION



IEC 60309, 2P 3W 6H  
IP67 (WATERTIGHT)  
250V MAX RATED INPUT  
60A(48A DERATED)/63A

**NOTES:**

1. INSTALLATION SHALL COMPLY WITH ALL APPLICABLE NATIONAL, STATE AND LOCAL CODES.
2. SEE PRODUCT DOCUMENTATION FOR FURTHER INFORMATION

	THIS DRAWING AND SPECIFICATIONS HEREIN ARE THE PROPERTY OF NVENT AND SHALL NOT BE COPIED, REPRODUCED OR USED IN WHOLE OR IN PART, AS THE BASIS FOR THE MANUFACTURE OR SALE OF ITEMS WITHOUT WRITTEN PERMISSION FROM NVENT. THIS DRAWING IS BASED UPON LATEST AVAILABLE INFORMATION AND IS SUBJECT TO CHANGE WITHOUT NOTICE	TITLE:  ADVANTAGE SERIES METERED SWITCHED	UNLESS NOTED, DIMENSIONS ARE IN MILLIMETERS & TOLERANCES ARE:  X.    ±1    MM                      X°    ±1° X.X   ±0.5   MM                    X.X° ±0.5° X.XX ±0.20 MM Ø X.X   ±0.3   MM Ø X.XX ±0.10 MM  BRACKETED DIMENSIONS ARE IN INCHES FOR REFERENCE ONLY  ⊕    THRID ANGLE PROJECTION  INTERPRET PER ASME Y14.5M-1994	PART NO: EN2355-WXYZ	REV. E1
		PROJECT:  ENLOGIC		DRAWN BY:    Rongfeng Lu	2024-10-08
				ENGINEER:    Yuzhou Feng	2024-10-09
				APPROVED BY: Jingbo Luo	2024-10-09
				SCALE:2:5 (DO NOT SCALE DRAWING)	SHEET 2 OF 3 SIZE: A1

ENLOGIC

RACK Power Distribution Unit  
Metered Switched



Made In XXXXX

SKU #: EN2355-WXYZ

Model#: EP121248-0068-C(NA)/EP121263-0068-C(EU)  
INPUT: 200-240VAC,1-PHASE, WYE, 50/60Hz, 48A(NA), OR  
200-240VAC,1-PHASE, WYE, 50/60Hz, 63A(EU)  
OUTPUT: C13/C15 COMBO; 200-240VAC, 10A per outlet  
C13/C15/C19 COMBO; 200-240VAC, 16A max per outlet  
48A Total(NA) OR 63A Total(EU)

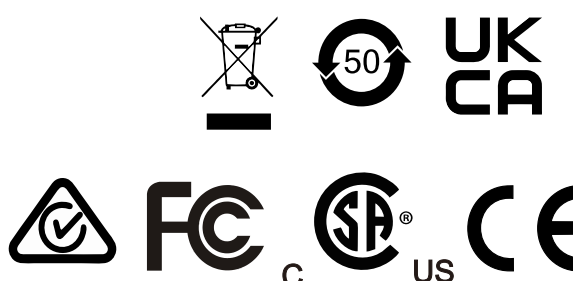
MAC0 Address:XX-XX-XX-XX-XX-XX  
MAC1 Address:XX-XX-XX-XX-XX-XX

  
THIS DEVICE COMPLIES WITH PART 15 OF THE FCC RULES.  
OPERATION IS SUBJECT TO THE FOLLOWING TWO CONDITIONS:  
(1) THIS DEVICE MAY NOT CAUSE HARMFUL INTERFERENCE,  
AND (2) THIS DEVICE MUST ACCEPT ANY INTERFERENCE RECEIVED,  
INCLUDING INTERFERENCE THAT MAY CAUSE UNDESIRED OPERATION.  
CAN ICES-003(A)/NMB-003(A)

SKU#:  
  
E N 2 3 5 5 -W X Y Z  
Serial Number  
  
XXXXXXXXXX

NOTES:

1. INTERNAL WIRING

WIRE TYPE:

LINE 1/R/X COLOR:

EARTH GROUND COLOR:

NEUTRAL COLOR:

UL AWM 1015,10 & 12 & 18 AWG

BROWN

GREEN STRIPE

BLUE

2. FOR FINISHED GOOD PART NUMBER SEE IDENTIFICATION

COMPLIANCE LABEL

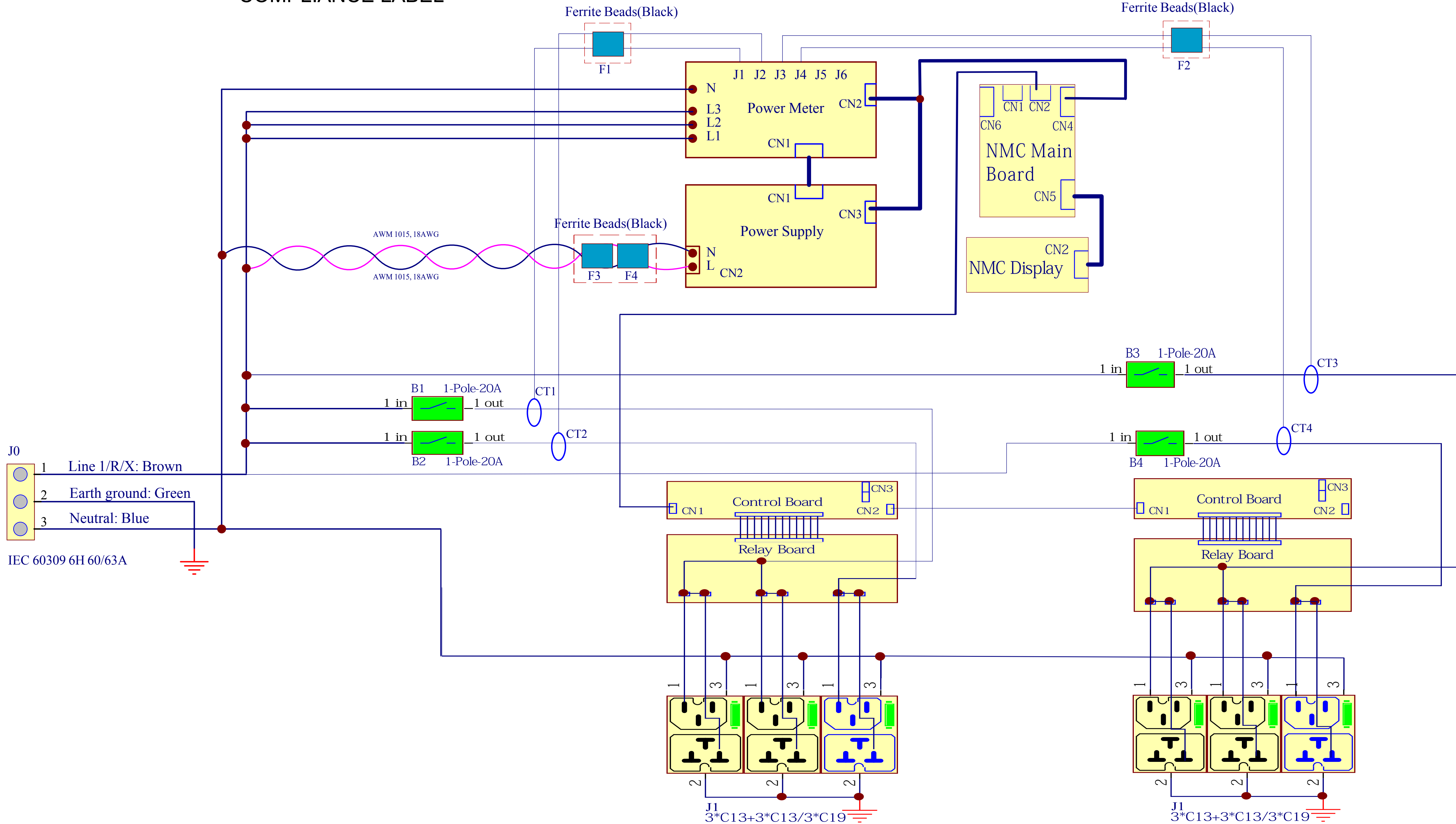

INTERNAL WIRING SCHEMATIC

- NOTES:
1. INSTALLATION SHALL COMPLY WITH ALL APPLICABLE NATIONAL, STATE AND LOCAL CODES.
  2. SEE PRODUCT DOCUMENTATION FOR FURTHER INFORMATION
  3. THIS DRAWING DEPICTS THE POWER SYSTEM CONNECTIONS AND IS NOT REPRESENTATIVE OF THE PHYSICAL LAYOUT. PLEASE REFER TO MECHANICAL DRAWINGS FOR PHYSICAL LAYOUT



THIS DRAWING AND SPECIFICATIONS HEREIN ARE THE PROPERTY OF NVENT AND SHALL NOT BE COPIED, REPRODUCED OR USED IN WHOLE OR IN PART, AS THE BASIS FOR THE MANUFACTURE OR SALE OF ITEMS WITHOUT WRITTEN PERMISSION FROM NVENT. THIS DRAWING IS BASED UPON LATEST AVAILABLE INFORMATION AND IS SUBJECT TO CHANGE WITHOUT NOTICE

TITLE:

ADVANTAGE SERIES  
METERED SWITCHED

PROJECT:

ENLOGIC

UNLESS NOTED, DIMENSIONS ARE IN MILLIMETERS & TOLERANCES ARE:

X. ±1 MM X° ±1°  
X.X ±0.5 MM X.X° ±0.5°  
X.XX ±0.20 MM  
ØX.X ±0.3 MM  
ØX.XX ±0.10 MM

BRACKETED DIMENSIONS ARE IN INCHES FOR REFERENCE ONLY

THRID ANGLE PROJECTION  
INTERPRET PER ASME Y14.5M-1994

PART NO:	EN2355-WXYZ	REV.	E1
DRAWN BY:	Rongfeng Lu	2024-10-08	
ENGINEER:	Yuzhou Feng	2024-10-09	
APPROVED BY:	Jingbo Luo	2024-10-09	
SCALE:	2:5	SHEET	3 OF 3
(DO NOT SCALE DRAWING)		SIZE:	A1