

# CFFP Tapered Plastic Screw-In Plug for A12, A22 and A32K Couplers



## FEATURES

Designed for use with the A12, A22 and A32K coupler families

Designed to keep dirt, water and concrete slurry out of the coupler during the concrete pour

Durable mounting plates allow for easy attachment to forms

Color coded for the appropriate coupler size

## SPECIFICATIONS

**Material:** Polyethylene

Table 1/2

Catalog Number	Article Number	Rebar Size, Metric	Rebar Size, US	Rebar Size, Canada	Diameter (Ø)	Height (H)
EL28CFFP	156070	28 mm	#9	30M	59 mm	23 mm
EL12CFFP	156010	12 mm	#4	10M	59 mm	23 mm
EL25CFFP	156060	25 mm	#8	25M	59 mm	23 mm
EL20CFFP	156050	20 mm	#6	20M	59 mm	23 mm

CatalogNumber	Article Number	Rebar Size, Metric	Rebar Size, US	Rebar Size, Canada	Diameter (Ø)	Height (H)
EL16CFFP	156030	16 mm	#5	15M	59 mm	23 mm
EL14CFFP	156020	14 mm			59 mm	23 mm

Table 2/2

Catalog Number	Article Number	Color
EL28CFFP	156070	Черный
EL12CFFP	156010	Красный
EL25CFFP	156060	Красный
EL20CFFP	156050	Yellow
EL16CFFP	156030	Черный
EL14CFFP	156020	Зеленый

## ADDITIONAL PRODUCT DETAILS

EL12CFFP and EL16CFFP can also be used on the A2 coupler families.

## DIAGRAMS

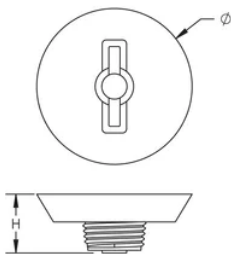

## WARNING

nVent products shall be installed and used only as indicated in nVent's product instruction sheets and training materials. Instruction sheets are available at [www.nvent.com](http://www.nvent.com) and from your nVent customer service representative. Improper installation, misuse, misapplication or other failure to completely follow nVent's instructions and warnings may cause product malfunction, property damage, serious bodily injury and death and/or void your warranty.

#### North America

+1.800.753.9221

Option 1 – Customer Care

Option 2 – Technical

Support

#### Europe

Netherlands:

+31 800-0200135

France:

+33 800 901 793

#### Europe

Germany:

800 1890272

Other Countries:

+31 13 5835404

#### APAC

Shanghai:

+ 86 21 2412 1618/19

Sydney:

+61 2 9751 8500



Our powerful portfolio of brands:

**CADDY**

**ERICO**

**HOFFMAN**

**ILSCO**

**SCHROFF**

**TRACHTE**