

CPPS Tapered Plastic Screw-In Plug with Steel Cap for A12



FEATURES

Designed for use with the A12 coupler families

Designed to keep dirt, water and concrete slurry out of the coupler during the concrete pour

Steel cap provides added protection from damage

Color coded for the appropriate coupler size

SPECIFICATIONS

Table 1/2

Catalog Number	Article Number	Material	Rebar Size, Metric	Rebar Size, US	Rebar Size, Canada	Diameter (Ø)
EL10CPPS	153600	High Density Polyethylene (HDPE), Сталь	10 mm	#3		17 mm
EL12CPPS	153610	High Density Polyethylene (HDPE), Сталь	12 mm	#4	10M	17 mm
EL14CPPS	153620	High Density Polyethylene (HDPE), Сталь	14 mm			22 mm
EL16CPPS	153630	High Density Polyethylene (HDPE), Сталь	16 mm	#5	15M	22 mm

CatalogNumber	Article Number	Material	Rebar Size, Metric	Rebar Size, US	Rebar Size, Canada	Diameter (Ø)
EL18CPPS	153640	High Density Polyethylene (HDPE), Сталь	18 mm			27 mm
EL20CPPS	153650	High Density Polyethylene (HDPE), Сталь	20 mm	#6	20M	27 mm
EL22CPPS	153660	High Density Polyethylene (HDPE), Сталь	22 mm	#7		33 mm
EL25CPPS	153670	High Density Polyethylene (HDPE), Сталь	25 mm	#8	25M	33 mm
EL28CPPS	153680	High Density Polyethylene (HDPE), Сталь	28 mm	#9	30M	37 mm
EL30CPPS	153690	High Density Polyethylene (HDPE), Сталь	30 mm			37 mm
EL32CPPS	153700	High Density Polyethylene (HDPE), Сталь	32 mm	#10		42 mm
EL40CPPS	153710	High Density Polyethylene (HDPE), Сталь	40 mm			52 mm
EL50TCPPS	154970	High Density Polyethylene (HDPE), Сталь	50 mm			64 mm

Table 2/2

Catalog Number	Article Number	Height (H)	Color
EL10CPPS	153600	15 mm	Yellow
EL12CPPS	153610	15 mm	Красный
EL14CPPS	153620	15 mm	Зеленый
EL16CPPS	153630	15 mm	Черный
EL18CPPS	153640	15 mm	White

Catalog Number	Article Number	Height (H)	Color
EL20CPPS	153650	15 mm	Yellow
EL22CPPS	153660	18 mm	Blue
EL25CPPS	153670	18 mm	Красный
EL28CPPS	153680	18 mm	Черный
EL30CPPS	153690	18 mm	White
EL32CPPS	153700	18 mm	Yellow
EL40CPPS	153710	18 mm	Зеленый
EL50TCPPS	154970	18 mm	Черный

DIAGRAMS

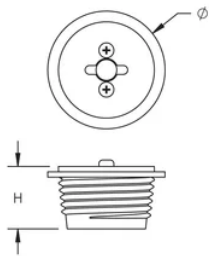

WARNING

nVent products shall be installed and used only as indicated in nVent's product instruction sheets and training materials. Instruction sheets are available at www.nvent.com and from your nVent customer service representative. Improper installation, misuse, misapplication or other failure to completely follow nVent's instructions and warnings may cause product malfunction, property damage, serious bodily injury and death and/or void your warranty.

North America

+1.800.753.9221

Option 1 – Customer Care

Option 2 – Technical

Support

Europe

Netherlands:

+31 800-0200135

France:

+33 800 901 793

Europe

Germany:

800 1890272

Other Countries:

+31 13 5835404

APAC

Shanghai:

+ 86 21 2412 1618/19

Sydney:

+61 2 9751 8500



Our powerful portfolio of brands:

CADDY

ERICO

HOFFMAN

ILSCO

SCHROFF

TRACHTE