

# Cable to Web of Rail TB5 Complete Welder, Signal

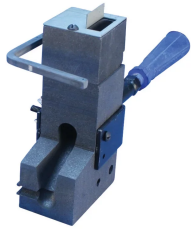

## FEATURES

Complete right hand or left hand web welder assembly designed for the installation of track circuits and jumper bonds to the neutral axis of 85 to 141 lb. rail

## SPECIFICATIONS

- Bond Terminal Style:** 1" Tab
- Rail Type:** 85 lb to 141 lb T-Rail Sections
- Material:** Graphite;Steel;Thermoplastic

Table 1/1

Catalog Number	Conductor Size	Conductor Outer Diameter, Nominal	Welder Style	Orientation
SBWRTB5ALH	3/16" Bondstrand	4.76mm	TB5	Left Hand
SBWRTB5ARH	3/16" Bondstrand	4.76mm	TB5	Right Hand

## WARNING

nVent products shall be installed and used only as indicated in nVent's product instruction sheets and training materials. Instruction sheets are available at [www.nvent.com](http://www.nvent.com) and from your nVent customer service representative. Improper installation, misuse, misapplication or other failure to completely follow nVent's instructions and warnings may cause product malfunction, property damage, serious bodily injury and death and/or void your warranty.

**North America**

+1.800.753.9221

Option 1 – Customer Care

Option 2 – Technical

Support

**Europe**

Netherlands:

+31 800-0200135

France:

+33 800 901 793

**Europe**

Germany:

800 1890272

Other Countries:

+31 13 5835404

**APAC**

Shanghai:

+ 86 21 2412 1618/19

Sydney:

+61 2 9751 8500



Our powerful portfolio of brands:

**CADDY**

**ERICO**

**HOFFMAN**

**ILSCO**

**SCHROFF**

**TRACHTE**