

P8 Position Coupler for Nuclear Applications



The nuclear industry demands scrutiny throughout the entire product life-cycle. nVent LENTON products produced under nVent's nuclear quality systems receive the utmost attention to detail and can meet the high demands of the nuclear industry. These quality systems are designed to include compliance to ASME NCA-3800 (ERICO - QSC 595), NQA-1, 10CFR50 Appendix B, 10CFR 50.55(e), 10CFR Part 21 and USNRC Regulatory Guide 1.28. nVent LENTON products produced for nuclear applications are assigned unique part numbers to ensure detailed product documentation and full product traceability in accordance with demanding industry expectations.

FEATURES

Designed to splice the same diameter bars

Designed to splice two curved, bent or straight bars, when neither bar can be rotated and where the ongoing bar is NOT free to move in its axial direction

Adjustability in the female end of the coupler allows the coupler to extend out to meet the taper-threaded reinforcing bar

SPECIFICATIONS

Finish:	Plain
Material:	Steel
100% U.S. Domestic Content:	Yes

Table 1/2

Catalog Number	Coupler Adjustment	Rebar Size, US	Rebar Size, Canada	Diameter (Ø)	Length 1 (L1)	Length 2 (L2)
EL16P8Q	Standard	#5	15M	1.81"	5.11"	6.69"
EL20P8Q	Standard	#6	20M	1.81"	5.84"	7.82"
EL22P8Q	Standard	#7		1.81"	6.3"	8.45"
EL25P8Q	Standard	#8	25M	1.81"	6.73"	8.97"

CatalogNumber	Coupler Adjustment	Rebar Size, US	Rebar Size, Canada	Diameter (Ø)	Length 1 (L1)	Length 2 (L2)
EL28P8Q	Standard	#9	30M	2.5"	6.88"	9.26"
EL32P8Q	Standard	#10		2.5"	7.31"	9.78"
EL36P8Q	Standard	#11	35M	2.5"	7.82"	10.39"
EL43TP8Q	Standard	#14	45M	3"	11.4"	15.1"
EL43TP8QX6	Extended	#14	45M	3"	16.7"	23.9"
EL57TP8Q	Standard	#18	55M	4"	13.68"	17.99"

Table 2/2

Catalog Number	Bar Depth (BD)	Bar Gap 1 (BG1)	Bar Gap 2 (BG2)	Coupler Body (CB)	Unit Weight
EL16P8Q	0.86"	3.39"	4.97"	3.52"	3.4 lb
EL20P8Q	1.09"	3.66"	5.64"	4.25"	3.8 lb
EL22P8Q	1.26"	3.78"	5.93"	4.71"	4 lb
EL25P8Q	1.36"	4.01"	6.25"	5.14"	4.2 lb
EL28P8Q	1.49"	3.9"	6.28"	5.29"	8.5 lb
EL32P8Q	1.58"	4.15"	6.62"	5.72"	8.7 lb
EL36P8Q	1.68"	4.46"	7.03"	6.23"	9.1 lb
EL43TP8Q	2.2"	7"	10.7"	7.8"	18 lb
EL43TP8QX6	2.2"	12.28"	19.5"	12.8"	28 lb
EL57TP8Q	2.81"	8.06"	12.37"	9.52"	37.9 lb

Designed to Meet:

AASHTO;ABNT NBR 8548:1984;ACI 318 Type 1 (125% Specified Yield);ACI 318 Type 2 (Specified Tensile);ACI 349;ACI 359;AS3600

ADDITIONAL PRODUCT DETAILS

Bar dimensions and weights listed may vary by region. Coupler sizes not shown may be available by special order. Contact your nVent LENTON representative for more information.

DIAGRAMS

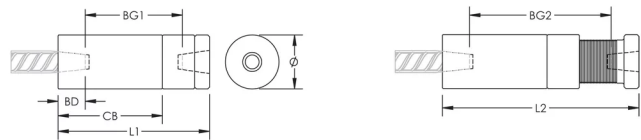

WARNING

nVent products shall be installed and used only as indicated in nVent's product instruction sheets and training materials. Instruction sheets are available at www.nvent.com and from your nVent customer service representative. Improper installation, misuse, misapplication or other failure to completely follow nVent's instructions and warnings may cause product malfunction, property damage, serious bodily injury and death and/or void your warranty.

North America

+1.800.753.9221
Option 1 – Customer Care
Option 2 – Technical
Support

Europe

Netherlands:
+31 800-0200135
France:
+33 800 901 793

Europe

Germany:
800 1890272
Other Countries:
+31 13 5835404

APAC

Shanghai:
+ 86 21 2412 1618/19
Sydney:
+61 2 9751 8500



Our powerful portfolio of brands:

CADDY ERICO HOFFMAN ILSCO SCHROFF TRACHTE