

# nVent LENTON Interlok Standard Grout-Fill Coupler, Plain



## CERTIFICATIONS



## FEATURES

Designed to splice the same diameter bars

Smaller bars can be installed into the over-sized cavity end if required

Over-sized cavity allows for greater field tolerance

Taper-threaded end helps prevent movement of the reinforcing bars and eliminate misalignment

Requires less grout than most competitive systems

## SPECIFICATIONS

**Material:** Cast Iron

**Finish:** Plain

Table 1/2

Catalog Number	Packaging	Rebar Size, US	Rebar Size, Canada	Diameter 1 (Ø1)	Diameter 2 (Ø2)	Length 1 (L1)
LK5	Standard	#5	15M	2.56"	1.88"	7.88"

CatalogNumber	Packaging	Rebar Size, US	Rebar Size, Canada	Diameter 1(Ø1)	Diameter 2(Ø2)	Length 1 (L1)
LK5PKG	Bulk	#5	15M	2.56"	1.88"	7.88"
LK16D	Standard	#5	15M	2.31"	1.63"	7.91"
LK6	Standard	#6	20M	2.56"	1.88"	7.88"
LK6PKG	Bulk	#6	20M	2.56"	1.88"	7.88"
LK7	Standard	#7		2.56"	1.88"	7.88"
LK7PKG	Bulk	#7		2.56"	1.88"	7.88"
LK8PKG	Bulk	#8	25M	2.69"	2"	8.62"
LK8	Standard	#8	25M	2.69"	2"	8.62"
LK20D	Standard	#6	20M	2.44"	1.75"	8.89"
LK9	Standard	#9	30M	2.81"	2.13"	9.75"
LK9PKG	Bulk	#9	30M	2.81"	2.13"	9.75"
LK25D	Standard	#8	25M	2.69"	2"	8.98"
LK10	Standard	#10		3"	2.31"	10.81"
LK10PKG	Bulk	#10		3"	2.31"	10.81"
LK11	Standard	#11	35M	3.13"	2.44"	12"
LK11PKG	Bulk	#11	35M	3.13"	2.44"	12"
LK12	Standard			3.69"	2.75"	15.19"
LK36D	Standard	#11	35M	3.19"	2.44"	12.34"

CatalogNumber	Packaging	Rebar Size, US	Rebar Size, Canada	Diameter 1(Ø1)	Diameter 2(Ø2)	Length 1 (L1)
LKT14	Standard	#14	45M	3.69"	2.75"	15.19"
LKT14PKG	Bulk	#14	45M	3.69"	2.75"	15.19"
LK40	Standard			3.69"	2.75"	15.19"

Table 2/2				
Catalog Number	Length 2 (L2)	Bar Depth (BD)	Unit Weight	Certifications
LK5	6.13"	0.86"	4.4 lb	
LK5PKG	6.13"	0.86"	4.4 lb	
LK16D	6.62"	0.96"	3.7 lb	
LK6	6.13"	1.09"	4.3 lb	IAPMO®-UES, LA City Approval
LK6PKG	6.13"	1.09"	4.3 lb	
LK7	6.13"	1.26"	4.3 lb	IAPMO®-UES, LA City Approval
LK7PKG	6.13"	1.26"	4.3 lb	
LK8PKG	7"	1.26"	4.7 lb	
LK8	7"	1.36"	4.7 lb	LA City Approval, IAPMO®-UES
LK20D	7"	1.37"	4.4 lb	
LK9	8"	1.49"	5.4 lb	IAPMO®-UES, LA City Approval
LK9PKG	8"	1.49"	5.4 lb	
LK25D	7"	1.57"	4.99 lb	
LK10	9"	1.58"	6.3 lb	IAPMO®-UES, LA City Approval

Catalog Number	Length 2 (L2)	Bar Depth (BD)	Unit Weight	Certifications
LK10PKG	9"	1.58"	6.3 lb	
LK11	9.88"	1.68"	8 lb	LA City Approval, IAPMO®-UES
LK11PKG	9.88"	1.68"	8 lb	
LK12	12.75"	1.75"	15.7 lb	
LK36D	9.88"	2.04"	8.91 lb	
LKT14	12.75"	2.2"	16 lb	IAPMO®-UES, LA City Approval
LKT14PKG	12.75"	2.2"	16 lb	
LK40	12.75"	2.25"	14 lb	

## ADDITIONAL PRODUCT DETAILS

Bar dimensions and weights listed may vary by region. Coupler sizes not shown may be available by special order. Contact your nVent LENTON representative for more information.

Prior to installation, please read and understand the detailed instructions and safety notices provided in the nVent LENTON Interlok Instruction Manual.

## DIAGRAMS

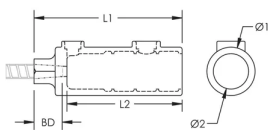

## WARNING

nVent products shall be installed and used only as indicated in nVent's product instruction sheets and training materials. Instruction sheets are available at [www.nvent.com](http://www.nvent.com) and from your nVent customer service representative. Improper installation, misuse, misapplication or other failure to completely follow nVent's instructions and warnings may cause product malfunction, property damage, serious bodily injury and death and/or void your warranty.

#### North America

+1.800.753.9221

Option 1 – Customer Care

Option 2 – Technical

Support

#### Europe

Netherlands:

+31 800-0200135

France:

+33 800 901 793

#### Europe

Germany:

800 1890272

Other Countries:

+31 13 5835404

#### APAC

Shanghai:

+ 86 21 2412 1618/19

Sydney:

+61 2 9751 8500



Our powerful portfolio of brands:

**CADDY**

**ERICO**

**HOFFMAN**

**ILSCO**

**SCHROFF**

**TRACHTE**