

FT12 Female Standard Coupler



The LENTON ULTIMATE FT12 Female Standard Coupler is designed for high performance applications, efficiently creating mechanical reinforcing bar connections where the second bar can be rotated and is not restricted in its axial direction. The LENTON self-aligning, taper-thread reduces misalignment issues and helps eliminate cross-threading during installation. The FT12 Female Standard Coupler is used in conjunction with the nVent LENTON Ultimate MT12 Male Taper Stud for bar-to-bar connections.

Additionally, the FT12 Female Standard Coupler can be used in conjunction with standard legacy LENTON Taper-Threaded bars produced on LENTON threaders. However, when using in conjunction with other legacy LENTON Taper-Threaded products the performance of the connection may be reduced. Contact your LENTON representative for more information.

Ultimate mechanical splices are pre-qualified for use for both Caltrans Ultimate and Caltrans Service applications. Additionally, they meet ACI® 318 Type 1 and Type 2 mechanical splice performance with ASTM® A615 and A706 grades 60 through 80 rebar.

Typical applications include column bar splicing (shearwalls, corewalls), beam bar splicing, future extension and segmental pours.

CERTIFICATIONS



FEATURES

Slim design maintains concrete cover

Installs quickly and easily

Utilizes the standard nVent LENTON taper profile

No special tools or skills required

Designed to splice the same diameter bars where the second bar can be rotated and is not restricted in its axial direction

SPECIFICATIONS

Finish: Plain
Material: Steel
100% U.S. Domestic Content: Yes

Table 1/2

Catalog Number	Rebar Size, US	Rebar Size, Canada	Hex Width (W)	Diameter (Ø)	Length (L)	Bar Depth (BD)
LU12FT12D	#4	10M	0.69"		1.54"	0.84"
LU16FT12D	#5	15M	0.88"		1.82"	1.06"
LU20FT12D	#6	20M	1.06"		2.48"	1.54"
LU22FT12D	#7		1.19"		2.6"	1.63"
LU25FT12D	#8	25M		1.38"	2.77"	1.73"
LU28FT12D	#9	30M		1 1/2"	2.87"	1.82"
LU32FT12D	#10			1 3/4"	3.04"	1.95"
LU36FT12D	#11	35M		1.88"	3.37"	2.21"
LU43TFT12D	#14	45M		2 1/4"	4.39"	2.9"
LU57TFT12D	#18	55M		3"	5.23"	3.57"

Table 2/2

Catalog Number	Unit Weight
LU12FT12D	0.1 lb
LU16FT12D	0.2 lb
LU20FT12D	0.5 lb
LU22FT12D	0.6 lb

Catalog Number	Unit Weight
LU25FT12D	0.8 lb
LU28FT12D	0.9 lb
LU32FT12D	1.3 lb
LU36FT12D	1.6 lb
LU43TFT12D	3 lb
LU57TFT12D	6.4 lb

Designed to Meet:

AASHTO;ABNT NBR 8548:1984;ACI 318 Type 1 (125% Specified Yield);ACI 318 Type 2 (Specified Tensile);ACI 349;ACI 359;AS3600

ADDITIONAL PRODUCT DETAILS

Bar dimensions and weights listed may vary by region. Coupler sizes not shown may be available by special order. Contact your nVent LENTON representative for more information.

DIAGRAMS

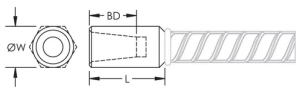

WARNING

nVent products shall be installed and used only as indicated in nVent's product instruction sheets and training materials. Instruction sheets are available at www.nvent.com and from your nVent customer service representative. Improper installation, misuse, misapplication or other failure to completely follow nVent's instructions and warnings may cause product malfunction, property damage, serious bodily injury and death and/or void your warranty.

North America

+1.800.753.9221

Option 1 – Customer Care

Option 2 – Technical

Support

Europe

Netherlands:

+31 800-0200135

France:

+33 800 901 793

Europe

Germany:

800 1890272

Other Countries:

+31 13 5835404

APAC

Shanghai:

+ 86 21 2412 1618/19

Sydney:

+61 2 9751 8500



Our powerful portfolio of brands:

CADDY

ERICO

HOFFMAN

ILSCO

SCHROFF

TRACHTE