

# DR14 Ultimate Terminator



The nVent LENTON DR14 Ultimate Terminator is designed to eliminate reinforcing bar hooks and simplify bar placement. The Terminator head area exceeds 10x bar area (net 9x) and maintains greater design flexibility than hooked bars. The system is designed to meet Caltrans Ultimate performance with A706 grade 60 rebar, ASTM A970 Classes A, HA, and B performance with A706 and A615 grade 60 and grade 80 rebar.

## CERTIFICATIONS



## FEATURES

Minimizes embedment lengths and reduces congestion

Simplifies concrete placement

Permanently fastened to the bar for secure transportation

Fast installation makes them ideal for high-volume shear ties

## SPECIFICATIONS

<b>Finish:</b>	Plain
<b>Material:</b>	Steel
<b>100% U.S. Domestic Content:</b>	Yes

Table 1/2

Catalog Number	Rebar Size, US	Rebar Size, Canada	Diameter 1 (Ø1)	Diameter 2 (Ø2)	Length 1 (L1)	Length 2 (L2)
LU12DR14D	#4	10M	1.75"	0.51"	0.79"	0.59"
LU16DR14D	#5	15M	2"	0.67"	0.79"	0.59"

CatalogNumber	Rebar Size, US	Rebar Size, Canada	Diameter 1(Ø1)	Diameter 2(Ø2)	Length 1 (L1)	Length 2 (L2)
LU20DR14D	#6	20M	2.5"	0.83"	0.79"	0.59"
LU22DR14D	#7		2.75"	0.91"	0.83"	0.63"
LU28TDR14D	#9	30M	4"	1.5"	1.14"	0.67"
LU25DR14D	#8	25M	3.25"	1.02"	0.98"	0.78"
LU32TDR14D	#10		4"	1.75"	1.32"	0.79"
LU36TDR14D	#11	35M	5.13"	1.88"	1.48"	0.87"
LU43TDR14D	#14	45M	5.5"	2.25"	1.75"	1.04"
LU57TDR14D	#18	55M	7.25"	3"	2.4"	1.44"

Table 2/2

Catalog Number	Unit Weight
LU12DR14D	0.4 lb
LU16DR14D	0.5 lb
LU20DR14D	0.9 lb
LU22DR14D	1 lb
LU28TDR14D	2.7 lb
LU25DR14D	1.9 lb
LU32TDR14D	3.2 lb
LU36TDR14D	5.7 lb
LU43TDR14D	8 lb

Catalog Number	Unit Weight
LU57TDR14D	19.2 lb

**Designed to Meet:** ACI 318;AS3600;ASTM A970

## ADDITIONAL PRODUCT DETAILS

Anchor sizes not shown can be produced by combining the nVent LENTON Ultimate MT12 with the D14 family of nVent LENTON Terminator.

## DIAGRAMS

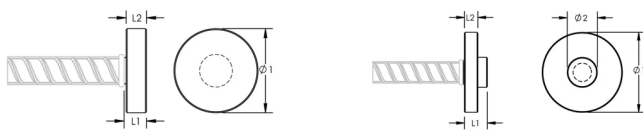

## WARNING

nVent products shall be installed and used only as indicated in nVent's product instruction sheets and training materials. Instruction sheets are available at [www.nvent.com](http://www.nvent.com) and from your nVent customer service representative. Improper installation, misuse, misapplication or other failure to completely follow nVent's instructions and warnings may cause product malfunction, property damage, serious bodily injury and death and/or void your warranty.

### North America

+1.800.753.9221

Option 1 – Customer Care

Option 2 – Technical

Support

### Europe

Netherlands:

+31 800-0200135

France:

+33 800 901 793

### Europe

Germany:

800 1890272

Other Countries:

+31 13 5835404

### APAC

Shanghai:

+ 86 21 2412 1618/19

Sydney:

+61 2 9751 8500



Our powerful portfolio of brands:

CADDY

ERICO

HOFFMAN

ILSCO

SCHROFF

TRACHTE