

# CFFPW Tapered Plastic Screw-In Plug for A2 Couplers



## FEATURES

Designed for use with the A2 coupler families

Designed to keep dirt, water and concrete slurry out of the coupler during the concrete pour

Durable mounting plates allow for easy attachment to forms

Color coded for the appropriate coupler size

## SPECIFICATIONS

**Material:** Polyethylene

Table 1/2

| Catalog Number | Rebar Size, US | Rebar Size, Canada | Diameter 1 (Ø1) | Diameter 2 (Ø2) | Height (H) | Thickness (T) |
|----------------|----------------|--------------------|-----------------|-----------------|------------|---------------|
| EL28CFFPW      | #9             | 30M                | 2.32"           | 1.95"           | 0.89"      | 0.13"         |
| EL16CFFPW      | #5             | 15M                | 2.32"           | 1.14"           | 0.89"      | 0.13"         |
| EL25CFFPW      | #8             | 25M                | 2.32"           | 1.82"           | 0.89"      | 0.13"         |
| EL12CFFPW      | #4             | 10M                | 2.32"           | 1 1/4"          | 0.89"      | 0.13"         |

| CatalogNumber | Rebar Size, US | Rebar Size, Canada | Diameter 1(Ø1) | Diameter 2(Ø2) | Height (H) | Thickness (T) |
|---------------|----------------|--------------------|----------------|----------------|------------|---------------|
| EL20CFFPW     | #6             | 20M                | 2.32"          | 1.62"          | 0.89"      | 0.13"         |

| Table 2/2      |        |
|----------------|--------|
| Catalog Number | Color  |
| EL28CFFPW      | Black  |
| EL16CFFPW      | Black  |
| EL25CFFPW      | Red    |
| EL12CFFPW      | Red    |
| EL20CFFPW      | Yellow |

### DIAGRAMS

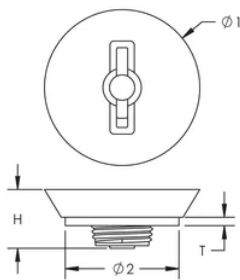

### WARNING

nVent products shall be installed and used only as indicated in nVent's product instruction sheets and training materials. Instruction sheets are available at [www.nvent.com](http://www.nvent.com) and from your nVent customer service representative. Improper installation, misuse, misapplication or other failure to completely follow nVent's instructions and warnings may cause product malfunction, property damage, serious bodily injury and death and/or void your warranty.

#### North America

+1.800.753.9221

Option 1 – Customer Care

Option 2 – Technical

Support

#### Europe

Netherlands:

+31 800-0200135

France:

+33 800 901 793

#### Europe

Germany:

800 1890272

Other Countries:

+31 13 5835404

#### APAC

Shanghai:

+ 86 21 2412 1618/19

Sydney:

+61 2 9751 8500



Our powerful portfolio of brands:

**CADDY**

**ERICO**

**HOFFMAN**

**ILSCO**

**SCHROFF**

**TRACHTE**