

C2/C3J Weldable Half-Coupler for Nuclear Applications



The nVent LENTON C2/C3J Weldable Half-Coupler for Nuclear Applications is designed for quick and easy connections of reinforcing steel bar to structural steel sections and plates. The nuclear construction industry demands scrutiny throughout the entire product life-cycle and nVent LENTON is here to be your technical expert. All weldable couplers are assigned unique part numbers to ensure detailed product documentation—including full product traceability—is performed to individual customer requirements.

When it comes to nuclear construction, precision, reliability, and compliance are non-negotiable. That's why leading contractors and engineers around the world turn to nVent LENTON—a global leader in mechanical rebar splicing systems engineered for the most demanding environments.

FEATURES

Designed for connecting reinforcing bar perpendicular to structural steel sections or plates

Internally taper threaded on one end, with the other end prepared for welding

Machined from weldable grades of steel

Digital model available in nVent BIM Library

SPECIFICATIONS

Finish: Plain

Material: Steel

100% U.S. Domestic Content: Yes

Table 1/2

Catalog Number	Rebar Size, US	Rebar Size, Canada	Diameter 1 (Ø1)	Diameter 2 (Ø2)	Length (L)	Bar Depth (BD)
EL12C2Q	#4	10M	3/4"	0.44"	1.19"	0.58"
EL16C2Q	#5	15M	1"	0.56"	1.38"	0.86"

CatalogNumber	Rebar Size, US	Rebar Size, Canada	Diameter 1(Ø1)	Diameter 2(Ø2)	Length (L)	Bar Depth (BD)
EL20C3JQ	#6	20M	1 1/4"	0.88"	2.16"	1.09"
EL22C3JQ	#7		1 1/4"	3/4"	2.41"	1.26"
EL28C3JQ	#9	30M	1.56"	0.94"	2.69"	1.49"
EL25C3JQ	#8	25M	1.56"	1"	2.53"	1.36"
EL36C3JQ	#11	35M	2"	1.13"	2.97"	1.68"
EL32C3JQ	#10		2"	0.94"	2.88"	1.58"
EL43TC3JQ	#14	45M	2.38"	1.41"	3 3/4"	2.2"
EL57TC3JQ	#18	55M	3.13"	1 3/4"	4 1/2"	2.81"

Table 2/2

Catalog Number	Unit Weight
EL12C2Q	0.1 lb
EL16C2Q	0.2 lb
EL20C3JQ	0.5 lb
EL22C3JQ	0.5 lb
EL28C3JQ	0.9 lb
EL25C3JQ	0.9 lb
EL36C3JQ	1.6 lb
EL32C3JQ	1.6 lb
EL43TC3JQ	2.9 lb

Catalog Number	Unit Weight
EL57TC3JQ	5.5 lb

Designed to Meet: AASHTO;ABNT NBR 8548:1984;ACI 318 Type 1 (125% Specified Yield);ACI 318 Type 2 (Specified Tensile);ACI 349;ACI 359;AS3600

ADDITIONAL PRODUCT DETAILS

Bar dimensions and weights listed may vary by region. Coupler sizes not shown may be available by special order. Contact your nVent LENTON representative for more information.

The design of the weld, the selection of electrode, and other relevant choices depend on the chemical and physical properties of the structural steel to which the couplers are welded. Engineers who design assemblies should adhere to all appropriate regulations.

DIAGRAMS

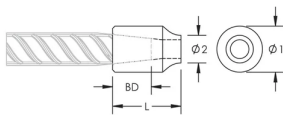

WARNING

nVent products shall be installed and used only as indicated in nVent's product instruction sheets and training materials. Instruction sheets are available at www.nvent.com and from your nVent customer service representative. Improper installation, misuse, misapplication or other failure to completely follow nVent's instructions and warnings may cause product malfunction, property damage, serious bodily injury and death and/or void your warranty.

North America

+1.800.753.9221
Option 1 – Customer Care
Option 2 – Technical
Support

Europe

Netherlands:
+31 800-0200135
France:
+33 800 901 793

Europe

Germany:
800 1890272
Other Countries:
+31 13 5835404

APAC

Shanghai:
+ 86 21 2412 1618/19
Sydney:
+61 2 9751 8500



Our powerful portfolio of brands:

CADDY ERICO HOFFMAN ILSCO SCHROFF TRACHTE