

A2 Standard Coupler, Plain



CERTIFICATIONS



FEATURES

Designed to splice the same diameter bars where the second bar can be rotated and is not restricted in its axial direction

Slim design maintains concrete cover

Installs quickly and easily

SPECIFICATIONS

Finish:	Plain
Coupler Protector:	Standard
Material:	Steel
100% U.S. Domestic Content:	Yes

Table 1/2

Catalog Number	Rebar Size, US	Rebar Size, Canada	Hex Width (W)	Diameter (Ø)	Length (L)	Bar Depth (BD)
EL12A2	#4	10M	0.69"		1.63"	0.58"
EL16A2	#5	15M	0.88"		2.19"	0.86"

CatalogNumber	Rebar Size, US	Rebar Size, Canada	Hex Width (W)	Diameter (Ø)	Length (L)	Bar Depth (BD)
EL20A2	#6	20M	1.06"		2.81"	1.09"
EL22A2	#7		1.19"		3.16"	1.26"
EL25A2	#8	25M		1.38"	3.34"	1.36"
EL28A2	#9	30M		1.5"	3.59"	1.49"
EL36A2	#11	35M		1.88"	3.97"	1.68"
EL32A2	#10			1.75"	3.78"	1.58"
EL38A2	#12			2"	4.13"	1.75"
EL40A2				2.25"	5"	2.17"
EL43TA2	#14	45M		2.25"	5.25"	2.2"
EL50TA2				2.75"	6.41"	2.78"
EL57TA2	#18	55M		3"	6.47"	2.81"

Table 2/2			
Catalog Number	Bar Gap (BG)	Unit Weight	Certifications
EL12A2	0.47"	0.1 lb	LA City Approval, IAPMO®-UES
EL16A2	0.47"	0.3 lb	IAPMO®-UES, LA City Approval
EL20A2	0.63"	0.5 lb	LA City Approval, IAPMO®-UES
EL22A2	0.64"	0.7 lb	LA City Approval, IAPMO®-UES
EL25A2	0.62"	0.9 lb	LA City Approval, IAPMO®-UES
EL28A2	0.61"	1 lb	LA City Approval, IAPMO®-UES

Catalog Number	Bar Gap (BG)	Unit Weight	Certifications
EL36A2	0.61"	1.8 lb	LA City Approval, IAPMO®-UES
EL32A2	0.62"	1.5 lb	LA City Approval, IAPMO®-UES
EL38A2	0.63"	2.1 lb	
EL40A2	0.66"	3.4 lb	LA City Approval, IAPMO®-UES
EL43TA2	0.85"	3.4 lb	LA City Approval, IAPMO®-UES
EL50TA2	0.85"	6.2 lb	IAPMO®-UES, LA City Approval
EL57TA2	0.85"	7.3 lb	LA City Approval, IAPMO®-UES

Designed to Meet: AASHTO;ABNT NBR 8548:1984;ACI 318 Type 1 (125% Specified Yield);ACI 318 Type 2 (Specified Tensile);ACI 349;ACI 359;AS3600

ADDITIONAL PRODUCT DETAILS

Bar dimensions and weights listed may vary by region. Coupler sizes not shown may be available by special order. Contact your nVent LENTON representative for more information.

DIAGRAMS

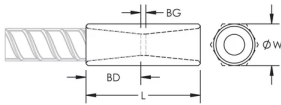

WARNING

nVent products shall be installed and used only as indicated in nVent's product instruction sheets and training materials. Instruction sheets are available at www.nvent.com and from your nVent customer service representative. Improper installation, misuse, misapplication or other failure to completely follow nVent's instructions and warnings may cause product malfunction, property damage, serious bodily injury and death and/or void your warranty.

North America

+1.800.753.9221

Option 1 – Customer Care

Option 2 – Technical

Support

Europe

Netherlands:

+31 800-0200135

France:

+33 800 901 793

Europe

Germany:

800 1890272

Other Countries:

+31 13 5835404

APAC

Shanghai:

+ 86 21 2412 1618/19

Sydney:

+61 2 9751 8500



Our powerful portfolio of brands:

CADDY

ERICO

HOFFMAN

ILSCO

SCHROFF

TRACHTE