

# TCB Threaded Busbar



## CERTIFICATIONS



## FEATURES

Heavy-duty power connection

Circuit breaker, generator and prefabricated power network conductor

Alternative to large and multiple cables

Earth/ground connection

Power distribution

Rounded edges

## SPECIFICATIONS

**Material:** Copper

Table 1/2

Catalog Number	Article Number	Width (W)	Thickness (T)	Length (L)	Thread Size (TS)	Torque (TQ)
TCB12X2-1M	549230	0.47"	0.08"	38.98"	M5	0.96 ft·lbf

CatalogNumber	Article Number	Width (W)	Thickness (T)	Length (L)	Thread Size (TS)	Torque (TQ)
TCB12X4-1M	550200	0.47"	0.16"	38.98"	M5	1.48 ft·lbf
TCB12X4-2M	550190	0.47"	0.16"	78.15"	M5	1.48 ft·lbf
TCB18X4-1M	549200	0.71"	0.16"	39.37"	M8	8.11 ft·lbf
TCB25X4-1M	549210	0.98"	0.16"	39.37"	M6	3.32 ft·lbf
TCB12X5-1M	549220	0.47"	0.2"	38.98"	M5	4.06 ft·lbf

Table 2/2

Catalog Number	Article Number	A	Unit Weight
TCB12X2-1M	549230	0.71"	0.66 lb
TCB12X4-1M	550200	0.71"	0.95 lb
TCB12X4-2M	550190	0.71"	1.87 lb
TCB18X4-1M	549200	0.79"	1.32 lb
TCB25X4-1M	549210	0.79"	1.76 lb
TCB12X5-1M	549220	0.71"	1.1 lb

## DIAGRAMS

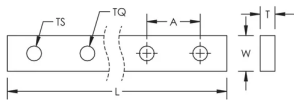

## WARNING

nVent products shall be installed and used only as indicated in nVent's product instruction sheets and training materials. Instruction sheets are available at [www.nvent.com](http://www.nvent.com) and from your nVent customer service representative. Improper installation, misuse, misapplication or other failure to completely follow nVent's instructions and warnings may cause product malfunction, property damage, serious bodily injury and death and/or void your warranty.

#### North America

+1.800.753.9221

Option 1 – Customer Care

Option 2 – Technical

Support

#### Europe

Netherlands:

+31 800-0200135

France:

+33 800 901 793

#### Europe

Germany:

800 1890272

Other Countries:

+31 13 5835404

#### APAC

Shanghai:

+ 86 21 2412 1618/19

Sydney:

+61 2 9751 8500



Our powerful portfolio of brands:

**CADDY**

**ERICO**

**HOFFMAN**

**ILSCO**

**SCHROFF**

**TRACHTE**