

Tip Receptor Mount



FEATURES

Improved performance at tip of blade

Performance tested beyond IEC® 61400-24

Superior receptor product life performance

Less than 12 °C (54 °F) temperature rise after strike of 225 kA

SPECIFICATIONS

Table 1/2

Catalog Number	Material	Finish	Conductor Size	Conductor Type	Thread Size (TS)	Length (L)
WT2TC1MV05.5	Polypropylene, Stainless Steel 316 (EN 1.4401), Copper	Tinned	50 mm ²	Concentric	M10	8.2"

Table 2/2

Catalog Number	Height (H)	Width (W)	A
WT2TC1MV05.5	1.57"	4.2"	5.1"

DIAGRAMS

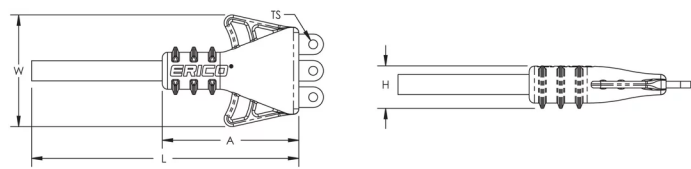

WARNING

nVent products shall be installed and used only as indicated in nVent's product instruction sheets and training materials. Instruction sheets are available at www.nvent.com and from your nVent customer service representative. Improper installation, misuse, misapplication or other failure to completely follow nVent's instructions and warnings may cause product malfunction, property damage, serious bodily injury and death and/or void your warranty.

North America

+1.800.753.9221
Option 1 – Customer Care
Option 2 – Technical
Support

Europe

Netherlands:
+31 800-0200135
France:
+33 800 901 793

Europe

Germany:
800 1890272
Other Countries:
+31 13 5835404

APAC

Shanghai:
+ 86 21 2412 1618/19
Sydney:
+61 2 9751 8500



Our powerful portfolio of brands:

CADDY ERICO HOFFMAN ILSCO SCHROFF TRACHTE