

# Plug Bond Splice Bar Connector, Signal



## CERTIFICATIONS



# BABA

## FEATURES

Designed for application to the rail web

Hammered into a 3/8" (9.5 mm) diameter hole drilled through the rail web and driven from the same side the hole was drilled

Can also be used to connect to the splice bar

## SPECIFICATIONS

Table 1/2

Catalog Number	Material	Finish	Conductor Size	Length (L)	Diameter 1 (Ø1)	Diameter 2 (Ø2)
SBPAW35	Copper Alloy, Cadmium Bronze, Carbon Steel	Electrogalvanized, Tinned, Bare	3/16" Bondstrand	5"	3/16"	0.41"

Table 2/2

Catalog Number	Diameter 3 (Ø3)	Depth 1 (D1)	Depth 2 (D2)
----------------	-----------------	--------------	--------------

SBPAW35	0.41"	1 1/4"	1 1/4"
---------	-------	--------	--------

### ADDITIONAL PRODUCT DETAILS

Plug Bond Grease (T369) recommended when installing.

### DIAGRAMS

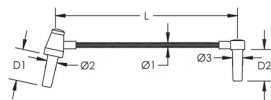

### WARNING

nVent products shall be installed and used only as indicated in nVent's product instruction sheets and training materials. Instruction sheets are available at [www.nvent.com](http://www.nvent.com) and from your nVent customer service representative. Improper installation, misuse, misapplication or other failure to completely follow nVent's instructions and warnings may cause product malfunction, property damage, serious bodily injury and death and/or void your warranty.

⚠ WARNING: This product can expose you to chemicals including cadmium, which is known to the State of California to cause birth defects or other reproductive harm. For more information go to [www.P65Warnings.ca.gov](http://www.P65Warnings.ca.gov).

#### North America

+1.800.753.9221  
Option 1 – Customer Care  
Option 2 – Technical  
Support

#### Europe

Netherlands:  
+31 800-0200135  
France:  
+33 800 901 793

#### Europe

Germany:  
800 1890272  
Other Countries:  
+31 13 5835404

#### APAC

Shanghai:  
+ 86 21 2412 1618/19  
Sydney:  
+61 2 9751 8500



Our powerful portfolio of brands:

CADDY   ERICO   HOFFMAN   ILSCO   SCHROFF   TRACHTE