

# nVent ERICO PermaGround Cast Beam Bonding Clamp

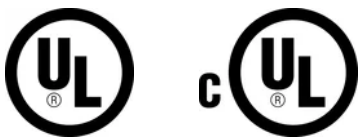

nVent ERICO PermaGround Cast Beam Bonding Clamp is a device used to establish a secure electrical connection between a cable and a flat metal object, like an I-beam or channel iron. It's designed for applications where grounding or bonding of electrical systems is necessary, ensuring the safe flow of electrical current.

## CERTIFICATIONS



## FEATURES

Clamp for bonding cable to flat metal objects such as I-beams, angle irons and channel irons

## SPECIFICATIONS

Table 1/2

Catalog Number	Conductor Size, UL	Main/Run Conductor Range	Material	Finish	Flange Thickness (FT)	Depth (D)
GM-1		4 - 8 AWG	Copper	Bare	0.25	1.087"
LPA559	Class 1 - Class 2 (4/0 Max)		Aluminum	Bare	1/4" Max	2 1/4"
GM-2		4 - 2/0 AWG	Copper	Bare	0.25	1.351"
GM-5		500 - 700 kcmil	Copper	Bare	0.25	1 3/4"

CatalogNumber	ConductorSize, UL	Main/Run Conductor Range	Material	Finish	Flange Thickness (FT)	Depth (D)
LPC559	Class 1 - Class 2 (4/0 Max)		Copper	Bare	1/4" Max	2 1/4"
LPC559L	Class 1 - Class 2 (4/0 Max)		Copper	Tinned	1/4" Max	2 1/4"
GM-3		2/0 - 250 kcmil	Copper	Bare	0.25	1.902"
GH-1		4 - 8 AWG	Copper	Bare	0.25	1.251"
GM-4		500 - 300 kcmil	Copper	Bare	0.25	2.262"

Table 2/2

Catalog Number	Width (W)	Unit Weight	Complies With	Certifications
GM-1	0.9	0.103	UL® 467	
LPA559	1.6"	0.14 lb		E202878- Combined_CoC, E202878- Combined_CoC
GM-2	0.97	0.2	UL® 467	
GM-5	3	0.25	UL® 467	
LPC559	1.6"	0.39 lb		E202878- Combined_CoC, E202878- Combined_CoC
LPC559L	1.6"	0.39 lb		E202878- Combined_CoC, E202878- Combined_CoC
GM-3	1.28	0.371	UL® 467	
GH-1	1.25	0.409	UL® 467	
GM-4	1.4	0.569	UL® 467	

DIAGRAMS

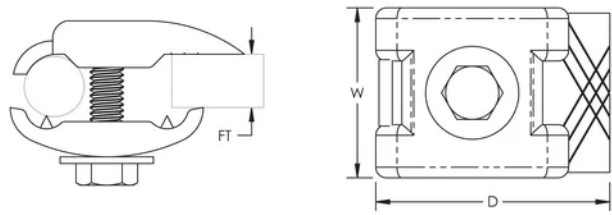

WARNING

nVent products shall be installed and used only as indicated in nVent's product instruction sheets and training materials. Instruction sheets are available at [www.nvent.com](http://www.nvent.com) and from your nVent customer service representative. Improper installation, misuse, misapplication or other failure to completely follow nVent's instructions and warnings may cause product malfunction, property damage, serious bodily injury and death and/or void your warranty.

North America

+1.800.753.9221  
Option 1 – Customer Care  
Option 2 – Technical  
Support

Europe

Netherlands:  
+31 800-0200135  
France:  
+33 800 901 793

Europe

Germany:  
800 1890272  
Other Countries:  
+31 13 5835404

APAC

Shanghai:  
+ 86 21 2412 1618/19  
Sydney:  
+61 2 9751 8500



Our powerful portfolio of brands:

CADDY   ERICO   HOFFMAN   ILSCO   SCHROFF   TRACHTE