

# Industrial Stack Base with Stud, Horizontal Cable Run



## CERTIFICATIONS



## FEATURES

Cast air terminal base for use with horizontal conductor runs

Welded threaded stud for use with expansion anchors

## SPECIFICATIONS

**Material:** Brass  
**Conductor Size, UL:** Class 2 (4/0 Max)

Table 1/2

| Catalog Number | Finish | Thread Size 1 (TS1) | Thread Size 2 (TS2) | Thread Length (TL) | Depth (D) | Height (H) |
|----------------|--------|---------------------|---------------------|--------------------|-----------|------------|
| LPC435LG       | Bare   | 5/8" UNC            | 1/2" UNC            | 1 1/2"             | 1"        | 3 15/16"   |
| LPC435SH       | Bare   | 5/8" UNC            | 1/2" UNC            | 7/8"               | 1"        | 3 15/16"   |

| CatalogNumber | Finish       | Thread Size 1 (TS1) | Thread Size 2 (TS2) | Thread Length (TL) | Depth (D) | Height (H) |
|---------------|--------------|---------------------|---------------------|--------------------|-----------|------------|
| LPLC435SH     | Lead Covered | 5/8" UNC            | 1/2" UNC            | 7/8"               | 1"        | 3 15/16"   |
| LPLC435LG     | Lead Covered | 5/8" UNC            | 1/2" UNC            | 1 1/2"             | 1"        | 3 15/16"   |

Table 2/2

| Catalog Number | Width (W) | Unit Weight | Certifications                                |
|----------------|-----------|-------------|---|
| LPC435LG       | 3"        | 1.2 lb      | E202878-Combined_CoC,<br>E202878-Combined_CoC |
| LPC435SH       | 3"        | 1.2 lb      | E202878-Combined_CoC,<br>E202878-Combined_CoC |
| LPLC435SH      | 3"        | 2.65 lb     |   |
| LPLC435LG      | 3"        | 2.65 lb     |   |

## ADDITIONAL PRODUCT DETAILS

Where applicable, lead covering thickness is a minimum of 1/16" (1.59 mm) and is not included in the stated dimensions.

## DIAGRAMS

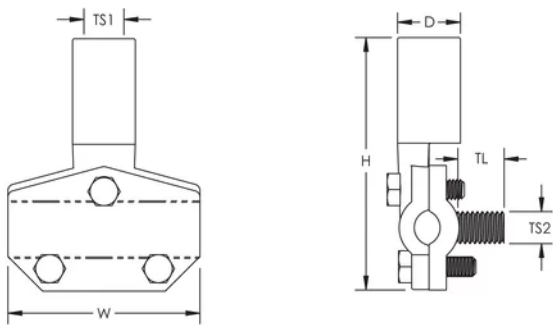

## WARNING

nVent products shall be installed and used only as indicated in nVent's product instruction sheets and training materials. Instruction sheets are available at [www.nvent.com](http://www.nvent.com) and from your nVent customer service representative. Improper installation, misuse, misapplication or other failure to completely follow nVent's instructions and warnings may cause product malfunction, property damage, serious bodily injury and death and/or void your warranty.

**⚠ WARNING:** This product can expose you to chemicals including lead, which is known to the State of California to cause cancer and birth defects or other reproductive harm. For more information go to [www.P65Warnings.ca.gov](http://www.P65Warnings.ca.gov).

#### North America

+1.800.753.9221

Option 1 – Customer Care

Option 2 – Technical

Support

#### Europe

Netherlands:

+31 800-0200135

France:

+33 800 901 793

#### Europe

Germany:

800 1890272

Other Countries:

+31 13 5835404

#### APAC

Shanghai:

+ 86 21 2412 1618/19

Sydney:

+61 2 9751 8500



Our powerful portfolio of brands:

**CADDY**

**ERICO**

**HOFFMAN**

**ILSCO**

**SCHROFF**

**TRACHTE**