

Ground Rod to Lug or Busbar

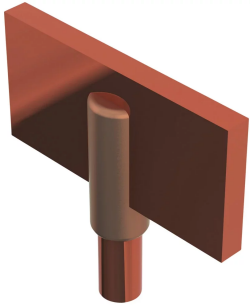

nVent ERICO Cadweld graphite molds are designed and engineered for thousands of connection styles and conductor combinations.

CERTIFICATIONS



DIAGRAMS

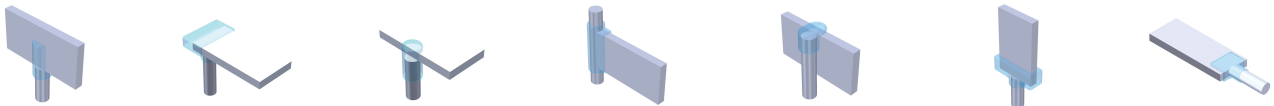

FEATURES

Forms a permanent, low resistance connection

Provides a molecular bond

nVent ERICO Cadweld Exothermic Connections are rated with the same current capacity as the conductor

Portable installation equipment with no external source of power required

Installers can be easily trained to make nVent ERICO Cadweld Exothermic Connections

Connections can be visually inspected

Mold Families LA and LE can be used with straight or offset lugs

SPECIFICATIONS

Table 1/1

Catalog Number	Mold Family	Ground Rod Type	Ground Rod Diameter, Nominal	Ground Rod Diameter, Actual	Lug/Busbar Size	Certifications
LAC18EK	LA (To Ground Rod)	Copper-bonded	3/4"	0.68"	1/4" x 3" and wider	
CMC14EAJ	CM	Steel	1/2"	0.51"	4 mm x 25 mm	
CMC14EAL	CM	Steel	1/2"	0.51"	4 mm x 40 mm	
CMC14EAM	CM	Steel	1/2"	0.51"	4 mm x 50 mm	
CMC14FAM	CM	Steel	1/2"	0.51"	5 mm x 50 mm	
CNC14EAJ	CN	Steel	1/2"	0.51"	4 mm x 25 mm	
CNC14EAM	CN	Steel	1/2"	0.51"	4 mm x 50 mm	
CSE14EG	CS	Steel	1/2"	0.51"	1/4" x 1 1/2"	
CMC16CAJ	CM	Copper-bonded	5/8"	0.56"	3 mm x 25 mm	
CMC16CAM	CM	Copper-bonded	5/8"	0.56"	3 mm x 50 mm	
CMC16EAJ	CM	Copper-bonded	5/8"	0.56"	4 mm x 25 mm	
CMC16EAL	CM	Copper-bonded	5/8"	0.56"	4 mm x 40 mm	
CMC16EH	CM	Copper-bonded	5/8"	0.56"	1/4" x 2"	
CMC16PAJ	CM	Copper-bonded	5/8"	0.56"	6 mm x 25 mm	
CMC16PAL	CM	Copper-bonded	5/8"	0.56"	6 mm x 40 mm	
CMC16PAM	CM	Copper-bonded	5/8"	0.56"	6 mm x 50 mm	
CNC16CAJ	CN	Copper-bonded	5/8"	0.56"	3 mm x 25 mm	

CatalogNumber	Mold Family	Ground Rod Type	Ground Rod Diameter, Nominal	Ground Rod Diameter, Actual	Lug/Busbar Size	Certifications
CNC16CAK	CN	Copper-bonded	5/8"	0.56"	3 mm x 30 mm	
CNC16EAM	CN	Copper-bonded	5/8"	0.56"	4 mm x 50 mm	
CNC16FAL	CN	Copper-bonded	5/8"	0.56"	5 mm x 40 mm	
CPC16BAH	CP	Copper-bonded	5/8"	0.56"	2 mm x 20 mm	
CPC16CAJ	CP	Copper-bonded	5/8"	0.56"	3 mm x 25 mm and wider	
CPC16EAJ	CP	Copper-bonded	5/8"	0.56"	4 mm x 25 mm and wider	
CQR16CAH	CQ	Copper-bonded	5/8"	0.56"	3 mm x 20 mm	
CRC16CE	CR	Copper-bonded	5/8"	0.56"	1/8" x 1"	
CRC16EK	CR	Copper-bonded	5/8"	0.56"	1/4" x 3" and wider	
CRC16FAM	CR	Copper-bonded	5/8"	0.56"	5 mm x 50 mm and wider	
CRC16PAM	CR	Copper-bonded	5/8"	0.56"	6 mm x 50 mm and wider	
CSE16EAJ	CS	Copper-bonded	5/8"	0.56"	4 mm x 25 mm	
CSE16EAM	CS	Copper-bonded	5/8"	0.56"	4 mm x 50 mm	
CMCP160CAJ	CM	Steel	16"	0.63"	3 mm x 25 mm	
CRCP160CAJ	CR	Steel	16"	0.63"	3 mm x 25 mm	
CMC18CAJ	CM	Copper-bonded	3/4"	0.68"	3 mm x 25 mm	
CMC18CAL	CM	Copper-bonded	3/4"	0.68"	3 mm x 40 mm	
CNC18CAJ	CN	Copper-bonded	3/4"	0.68"	3 mm x 25 mm	

CatalogNumber	Mold Family	Ground Rod Type	Ground Rod Diameter, Nominal	Ground Rod Diameter, Actual	Lug/Busbar Size	Certifications
CNC18CAK	CN	Copper-bonded	3/4"	0.68"	3 mm x 30 mm	
CNC18CAL	CN	Copper-bonded	3/4"	0.68"	3 mm x 40 mm	
CNC18EAL	CN	Copper-bonded	3/4"	0.68"	4 mm x 40 mm	
CPC18CAJ	CP	Copper-bonded	3/4"	0.68"	3 mm x 25 mm and wider	
CPC18EAJ	CP	Copper-bonded	3/4"	0.68"	4 mm x 25 mm and wider	
CRC18BAL	CR	Copper-bonded	3/4"	0.68"	2 mm x 40 mm and wider	cUL, UL
CRC18EAL	CR	Copper-bonded	3/4"	0.68"	4 mm x 40 mm and wider	
CRC18EH	CR	Copper-bonded	3/4"	0.68"	1/4" x 2" and wider	
CRD18EK	CR	Copper-bonded	3/4"	0.68"	1/4" x 3" and wider	
CNCP180FAM	CN	Steel	18"	0.71"	5 mm x 50 mm	
CQRP190CAJ	CQ	Steel	19"	0.75"	3 mm x 25 mm	
CMCP200CAJ	CM	Steel	20"	0.79"	3 mm x 25 mm	
CNCP200CAK	CN	Steel	20"	0.79"	3 mm x 30 mm	
CQFP200FAN	CQ	Steel	20"	0.79"	5 mm x 60 mm	
CQRP200PAJ	CQ	Steel	20"	0.79"	6 mm x 25 mm	
CMC22CAJ	CM	Copper-bonded	1"	0.91"	3 mm x 25 mm	
CMD22FAM	CM	Copper-bonded	1"	0.91"	5 mm x 50 mm	

ADDITIONAL PRODUCT DETAILS

For applications such as computer room, tunnel or other low-ventilation areas, specify a smokeless nVent ERICO Cadweld Exolon mold. Add an XL prefix to the standard mold part number when ordering (for example, a TAC2Q2Q becomes XLTAC2Q2Q). Similarly, nVent ERICO Cadweld Exolon welding material is also designated by the XL prefix (for example, 150 becomes XL150).

A gap between conductors may be required. See mold tag for more information.

XX-X-XX-XX-L-M-W		
XX	Mold Family	
X	Price Key	
XX	Ground Rod Code	
XX	Lug/Busbar Size	
L*	Split Crucible	Crucible section is split on molds designed with horizontal opening for easier cleaning
M*	Mold Only	
W*	Wear Plates	Reduce mechanical abrasion of molds at cable entry points

* Empty if none

WARNING

nVent products shall be installed and used only as indicated in nVent's product instruction sheets and training materials. Instruction sheets are available at www.nvent.com and from your nVent customer service representative. Improper installation, misuse, misapplication or other failure to completely follow nVent's instructions and warnings may cause product malfunction, property damage, serious bodily injury and death and/or void your warranty.

North America

+1.800.753.9221
Option 1 – Customer Care
Option 2 – Technical
Support

Europe

Netherlands:
+31 800-0200135
France:
+33 800 901 793

Europe

Germany:
800 1890272
Other Countries:
+31 13 5835404

APAC

Shanghai:
+ 86 21 2412 1618/19
Sydney:
+61 2 9751 8500



Our powerful portfolio of brands:

CADDY ERICO HOFFMAN ILSCO SCHROFF TRACHTE