

Compression Straight Connector



FEATURES

Tin plated for corrosion prevention

Annealed copper eases the crimping operation

Optimized sizes produce the most efficient electrical conductivity while providing superior mechanical resistance to vibration and pull out

Non-tension connectors

Heavy duty PKC-type connectors (DIN46235)

SPECIFICATIONS

Material: Copper

Finish: Tinned

Table 1/1

Catalog Number	Lug/Connector Type	Conductor Size	Length (L)	Tool/Die Type
RKC6T	Standard	6 mm ² Stranded	0.98"	M2M or M2H/RKM2, MLB/RKML
PKC50H	Heavy-Duty DIN46235	50 mm ² Stranded, 1/0 Stranded	2.2"	M2M or M2H/PKM2, M3H or M3B/PKM3, MLB/PKML
RKC50T	Standard	50 mm ² Stranded, 1/0 Stranded	1.97"	M2M or M2H/RKM2, M3H or M3B/RKM3, MLB/RKML
PKC10H	Heavy-Duty DIN46235	10 mm ² Stranded, #7 Stranded	1.18"	M2M or M2H/PKM2, MLB/PKML

Catalog Number	Lug/Connector Type	Conductor Size	Length (L)	Tool/Die Type
PKC6H	Heavy-Duty DIN46235	6 mm ² Stranded	1.18"	M2M or M2H/PKM2, M3H or M3B/PKM3, MLB/PKML
RKC10T	Standard	10 mm ² Stranded, #7 Stranded	1.18"	M2M or M2H/RKM2, MLB/RKML
RKC16T	Standard	16 mm ² Stranded, #5 Stranded	1.38"	M2M or M2H/RKM2, M3H or M3B/RKM3, MLB/RKML
RKC25T	Standard	25 mm ² Stranded, #3 Stranded	1.57"	M2M or M2H/RKM2, M3H or M3B/RKM3, MLB/RKML
RKC35T	Standard	35 mm ² Stranded, #2 Stranded	1.77"	M2M or M2H/RKM2, M3H or M3B/RKM3, MLB/RKML
PKC16H	Heavy-Duty DIN46235	16 mm ² Stranded, #5 Stranded	1.97"	M2M or M2H/PKM2, M3H or M3B/PKM3, MLB/PKML
PKC25H	Heavy-Duty DIN46235	25 mm ² Stranded, #3 Stranded	1.97"	M2M or M2H/PKM2, M3H or M3B/PKM3, MLB/PKML
PKC35H	Heavy-Duty DIN46235	35 mm ² Stranded, #2 Stranded	1.97"	M2M or M2H/PKM2, M3H or M3B/PKM3, MLB/PKML
PKC70H	Heavy-Duty DIN46235	70 mm ² Stranded, 2/0 Stranded	2.2"	M2M or M2H/PKM2, M3H or M3B/PKM3, MLB/PKML
RKC70T	Standard	70 mm ² Stranded, 2/0 Stranded	2.17"	M2M or M2H/RKM2, M3H or M3B/RKM3, MLB/RKML
RKC95T	Standard	95 mm ² Stranded, 4/0 Stranded	2.36"	M2M or M2H/RKM2, M3H or M3B/RKM3, MLB/RKML
RKC120T	Standard	120 mm ² Stranded, 250 kcmil Stranded	2.56"	M2M or M2H/RKM2, M3H or M3B/RKM3, MLB/RKML
PKC120H	Heavy-Duty DIN46235	120 mm ² Stranded, 250 kcmil Stranded	2.76"	M2M or M2H/PKM2, M3H or M3B/PKM3, MLB/PKML
PKC95H	Heavy-Duty DIN46235	95 mm ² Stranded, 4/0 Stranded	2.76"	M2M or M2H/PKM2, M3H or M3B/PKM3, MLB/PKML
RKC150T	Standard	150 mm ² Stranded, 300 kcmil Stranded	2.76"	M2M or M2H/RKM2, M3H or M3B/RKM3, MLB/RKML

Catalog Number	Lug/Connector Type	Conductor Size	Length (L)	Tool/Die Type
RKC185T	Standard	185 mm ² Stranded, 350 kcmil Stranded	2.95"	M2M or M2H/RKM2, M3H or M3B/RKM3, MLB/RKML
PKC150H	Heavy-Duty DIN46235	150 mm ² Stranded, 300 kcmil Stranded	3.15"	M2M or M2H/PKM2, M3H or M3B/PKM3, MLB/PKML
PKC185H	Heavy-Duty DIN46235	185 mm ² Stranded, 350 kcmil Stranded	3.35"	M2M or M2H/PKM2, M3H or M3B/PKM3, MLB/PKML
RKC240T	Standard	240 mm ² Stranded, 500 kcmil Stranded	3.35"	M2M or M2H/RKM2, M3H or M3B/RKM3, MLB/RKML
PKC240H	Heavy-Duty DIN46235	240 mm ² Stranded, 500 kcmil Stranded	3.54"	M2M or M2H/PKM2, M3H or M3B/PKM3
PKC300H	Heavy-Duty DIN46235	300 mm ² Stranded, 600 kcmil Stranded	3.94"	M2M or M2H/PKM2, M3H or M3B/PKM3
RKC300T	Standard	300 mm ² Stranded, 600 kcmil Stranded	3.94"	M2M or M2H/RKM2, M3H or M3B/RKM3
RKC400T	Standard	400 mm ² Stranded, 800 kcmil Stranded	3.94"	M3H or M3B/RKM3
PKC400H	Heavy-Duty DIN46235	400 mm ² Stranded, 800 kcmil Stranded	6.3"	M4FP/PKM4
PKC500H	Heavy-Duty DIN46235	500 mm ² Stranded	6.3"	M4FP/PKM4
PKC625H	Heavy-Duty DIN46235	625 mm ² Stranded	6.3"	M4FP/PKM4

DIAGRAMS

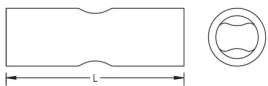

WARNING

nVent products shall be installed and used only as indicated in nVent's product instruction sheets and training materials. Instruction sheets are available at www.nvent.com and from your nVent customer service representative. Improper installation, misuse, misapplication or other failure to completely follow nVent's instructions and warnings may cause product malfunction, property damage, serious bodily injury and death and/or void your warranty.

North America

+1.800.753.9221

Option 1 – Customer Care

Option 2 – Technical

Support

Europe

Netherlands:

+31 800-0200135

France:

+33 800 901 793

Europe

Germany:

800 1890272

Other Countries:

+31 13 5835404

APAC

Shanghai:

+ 86 21 2412 1618/19

Sydney:

+61 2 9751 8500



Our powerful portfolio of brands:

CADDY

ERICO

HOFFMAN

ILSCO

SCHROFF

TRACHTE