

2 Hole Lug, GL Style



FEATURES

Provides an efficient bolting surface for grounding and power applications

Electrolytic grade copper

For use with nVent ERICO Cadweld type GL connections only

SPECIFICATIONS

Material: Copper

Finish: Tinned

Table 1/2

Catalog Number	Type	Height (H)	Length (L)	Width (W)	Thickness (T)	A
B122CE	NEMA®	0.44"	3.19"	1"	0.12"	0.62"
B123CE03	Non-NEMA®	0.44"	2.47"	1"	0.12"	0.62"
B122DE	NEMA®	0.44"	3 1/4"	1"	0.19"	0.62"
B122DE002	NEMA®	0.44"	2.47"	1"	0.19"	0.62"
B122EE	NEMA®	0.44"	3 1/4"	1"	1/4"	0.62"

CatalogNumber	Type	Height (H)	Length (L)	Width (W)	Thickness (T)	A
B122EG	NEMA®	0.44"	3 1/4"	1 1/2"	1/4"	0.62"
B122EG002	Non-NEMA®	0.44"	3 1/4"	3 1/4"	1/4"	0.62"
B123EG03	Non-NEMA®	0.44"	3 1/4"	1 1/2"	1/4"	0.62"

Table 2/2				
Catalog Number	B	Hole Size (HS)	Angle (a)	Equivalent Conductor Size
B122CE	1 3/4"	0.56"	90 °	159.12kcmil
B123CE03	1"	0.44"	90 °	159.12kcmil
B122DE	1 3/4"	0.56"	90 °	238.69kcmil
B122DE002	1 3/4"	0.44"	90 °	238.69kcmil
B122EE	1 3/4"	0.56"	90 °	318.25kcmil
B122EG	1 3/4"	0.56"	90 °	477.38kcmil
B122EG002	1 1/2"	0.69"	45 °	1034.31kcmil
B123EG03	1"	0.44"	90 °	477.38kcmil

ADDITIONAL PRODUCT DETAILS

For sizes not listed, contact us.

DIAGRAMS

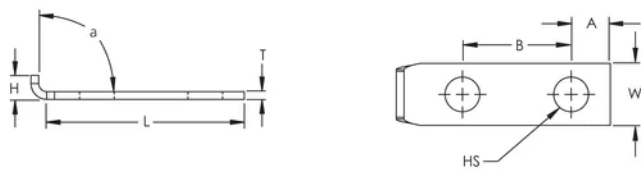

WARNING

nVent products shall be installed and used only as indicated in nVent's product instruction sheets and training materials. Instruction sheets are available at www.nvent.com and from your nVent customer service representative. Improper installation, misuse, misapplication or other failure to completely follow nVent's instructions and warnings may cause product malfunction, property damage, serious bodily injury and death and/or void your warranty.

North America

+1.800.753.9221
Option 1 – Customer Care
Option 2 – Technical
Support

Europe

Netherlands:
+31 800-0200135
France:
+33 800 901 793

Europe

Germany:
800 1890272
Other Countries:
+31 13 5835404

APAC

Shanghai:
+ 86 21 2412 1618/19
Sydney:
+61 2 9751 8500



Our powerful portfolio of brands:

CADDY ERICO HOFFMAN ILSCO SCHROFF TRACHTE