

# 1 Hole Lug, GL Style



## FEATURES

Provides an efficient bolting surface for grounding and power applications

Electrolytic grade copper

For use with nVent ERICO Cadweld type GL connections only

## SPECIFICATIONS

**Material:** Copper

**Type:** NEMA®

**Finish:** Tinned

Table 1/2

Catalog Number	Height (H)	Length (L)	Width (W)	Thickness (T)	A	Hole Size (HS)
B121CE	0.44"	1.44"	1"	0.12"	0.62"	0.56"
B121QQ	0.43"	1.52"	1"	0.13"	0.63"	0.56"
B121DE	0.44"	1.47"	1"	0.19"	0.62"	0.56"
B121SQ	0.43"	1.44"	1"	0.19"	0.63"	0.55"
B121EE	0.44"	1 1/2"	1"	1/4"	0.62"	0.56"

CatalogNumber	Height (H)	Length (L)	Width (W)	Thickness (T)	A	Hole Size (HS)
B121EG	0.44"	1 1/2"	1 1/2"	1/4"	0.62"	0.56"

Table 2/2		
Catalog Number	Angle (a)	Equivalent Conductor Size
B121CE	90 °	159.12kcmil
B121QQ	90 °	159kcmil
B121DE	105 °	238.69kcmil
B121SQ	90 °	239kcmil
B121EE	135 °	318.25kcmil
B121EG	135 °	477.38kcmil

### ADDITIONAL PRODUCT DETAILS

For sizes not listed, contact us.

### DIAGRAMS

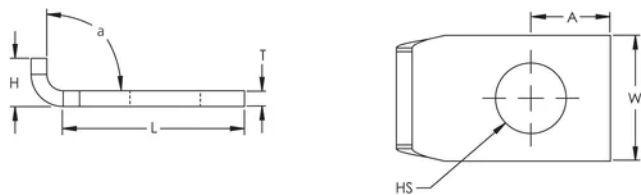

### WARNING

nVent products shall be installed and used only as indicated in nVent's product instruction sheets and training materials. Instruction sheets are available at [www.nvent.com](http://www.nvent.com) and from your nVent customer service representative. Improper installation, misuse, misapplication or other failure to completely follow nVent's instructions and warnings may cause product malfunction, property damage, serious bodily injury and death and/or void your warranty.

#### North America

+1.800.753.9221

Option 1 – Customer Care

Option 2 – Technical

Support

#### Europe

Netherlands:

+31 800-0200135

France:

+33 800 901 793

#### Europe

Germany:

800 1890272

Other Countries:

+31 13 5835404

#### APAC

Shanghai:

+ 86 21 2412 1618/19

Sydney:

+61 2 9751 8500



Our powerful portfolio of brands:

**CADDY**

**ERICO**

**HOFFMAN**

**ILSCO**

**SCHROFF**

**TRACHTE**