

# Universal Structural Bracket, Strut Brace

## Data Solutions



## CERTIFICATIONS



## FEATURES

Used for installations where strut brace is perpendicular to structure

One wrench size fits all required hardware, eliminating the need to change tools

Shear-off head helps ensure correct torque and simplifies inspection

## SPECIFICATIONS

**Finish:** Electrogalvanized

**Material:** Steel

Table 1/2

Catalog Number	Hole Size (HS)	Width (W)	Thickness (T)	A	B	C
CSBUS1	0.5625in	1.6in	0.25in	5.25in	0.5in	1.6in

CatalogNumber	Hole Size (HS)	Width (W)	Thickness (T)	A	B	C
CSBUS2	0.8125in	1.6in	0.25in	5.25in	0.5in	1.6in

Table 2/2		
Catalog Number	D	E
CSBUS1	2in	2.6in
CSBUS2	2in	2.6in

### ADDITIONAL PRODUCT DETAILS

Cut length for strut member is +/- 1" (25 mm) of measured length.

FM Loads					
Part Number	Brace Member	Horizontal Capacity per Installation Angle from Vertical			
		30° - 44°	45° - 59°	60° - 74°	75° - 90°
CSBUS1	12 GA Strut Channel	2,010 lb	2,840 lb	3,420 lb	3,810 lb
CSBUS2	12 GA Strut Channel	2,010 lb	2,840 lb	3,420 lb	3,810 lb

### DIAGRAMS

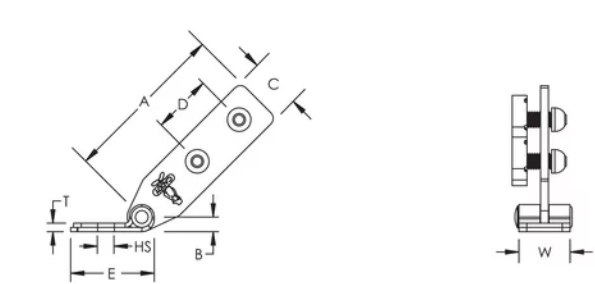

### WARNING

nVent products shall be installed and used only as indicated in nVent's product instruction sheets and training materials. Instruction sheets are available at [www.nvent.com](http://www.nvent.com) and from your nVent customer service representative. Improper installation, misuse, misapplication or other failure to completely follow nVent's instructions and warnings may cause product malfunction, property damage, serious bodily injury and death and/or void your warranty.



Our powerful portfolio of brands:

**CADDY   ERICO   HOFFMAN   ILSCO   SCHROFF   TRACHTE**