

2 Hole Lug, 4.75" x 1.5" x 0.375", 0.563" Hole

Data Solutions

CATALOG NUMBER

B102GG

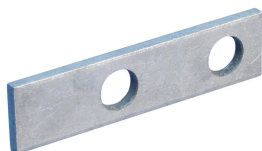

FEATURES

Provides an efficient bolting surface for grounding and power applications

Electrolytic grade copper

For use with nVent ERICO Cadweld type LA connections only

PRODUCT ATTRIBUTES

Material: Copper

Finish: Tinned

Type: NEMA®

Length (L): 4.75in

Width (W): 1.5in

Thickness (T): 0.38in

A: 0.62in

B: 1.75in

Hole Size (HS): 0.56in

Equivalent Conductor Size: 716.06kcmil

ADDITIONAL PRODUCT DETAILS

For sizes not listed, contact us.

DIAGRAMS

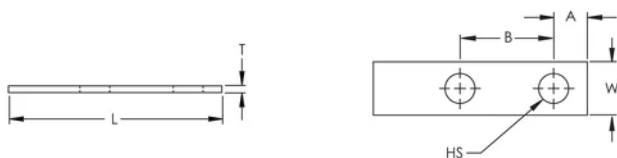

WARNING

nVent products shall be installed and used only as indicated in nVent's product instruction sheets and training materials. Instruction sheets are available at www.nvent.com and from your nVent customer service representative. Improper installation, misuse, misapplication or other failure to completely follow nVent's instructions and warnings may cause product malfunction, property damage, serious bodily injury and death and/or void your warranty.



Our powerful portfolio of brands:

CADDY ERICO HOFFMAN ILSCO SCHROFF TRACHTE