

2 Hole Lug

Data Solutions



FEATURES

Provides an efficient bolting surface for grounding and power applications

Electrolytic grade copper

For use with nVent ERICO Cadweld type LA connections only

SPECIFICATIONS

Material: Copper

Type: NEMA®

Finish: Tinned

Table 1/2

Catalog Number	Length (L)	Width (W)	Thickness (T)	A	B	Hole Size (HS)
B102CE	4in	1in	0.12in	0.62in	1.75in	0.56in
B103CE002	3.5in	1in	0.12in	0.62in	1.75in	0.44in
B102DE	4in	1in	0.19in	0.62in	1.75in	0.56in
B102EE	4.12in	1in	0.25in	0.62in	1.75in	0.56in

CatalogNumber	Length (L)	Width (W)	Thickness (T)	A	B	Hole Size (HS)
B102EG	4.12in	1.5in	0.25in	0.62in	1.75in	0.56in
B102EH	4.12in	2in	0.25in	0.62in	1.75in	0.56in
B102EH001	6in	2in	0.25in	0.62in	1.75in	0.56in
B103EK004	3in	3in	0.25in	1in	1.75in	0.56in
B102GG	4.75in	1.5in	0.38in	0.62in	1.75in	0.56in
B102GH	4.75in	2in	0.38in	0.62in	1.75in	0.56in
B102JH	5.25in	2in	0.5in	0.62in	1.75in	0.56in

Table 2/2

Catalog Number	Equivalent Conductor Size
B102CE	159.12kcmil
B103CE002	159.12kcmil
B102DE	238.69kcmil
B102EE	318.25kcmil
B102EG	477kcmil
B102EH	636.5kcmil
B102EH001	636.5kcmil
B103EK004	954.75kcmil
B102GG	716.06kcmil
B102GH	954.75kcmil

Catalog Number	Equivalent Conductor Size
B102JH	1273kcmil

ADDITIONAL PRODUCT DETAILS

For sizes not listed, contact us.

DIAGRAMS

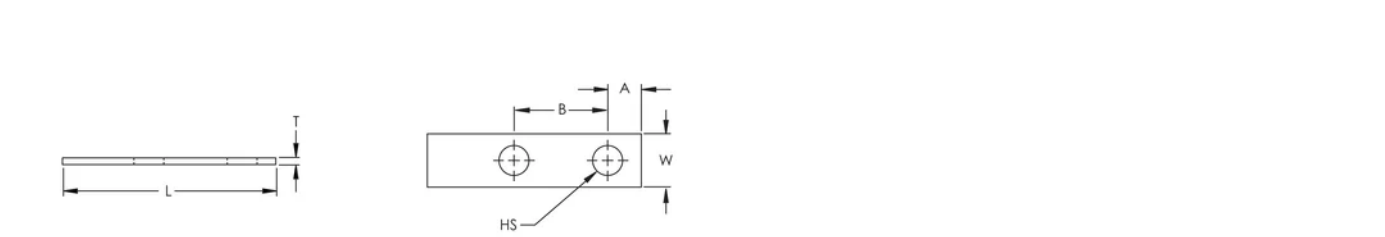

WARNING

nVent products shall be installed and used only as indicated in nVent's product instruction sheets and training materials. Instruction sheets are available at www.nvent.com and from your nVent customer service representative. Improper installation, misuse, misapplication or other failure to completely follow nVent's instructions and warnings may cause product malfunction, property damage, serious bodily injury and death and/or void your warranty.



Our powerful portfolio of brands:

CADDY ERICO HOFFMAN ILSCO SCHROFF TRACHTE