

nVent CADDY Telescoping Recessed Light Mounting Bracket



The nVent CADDY Telescoping Recessed Light Mounting Bracket is an adjustable and flexible solution for installing heavy-duty, commercial recessed lights, such as canned lights, wafer lights, puck lights, and more. The Telescoping Recessed Light Mounting Bracket is engineered for both hard lid ceiling and T-Grid applications. The pre-marked scorelines allow for pinpoint accuracy of light placement within the Telescoping Recessed Light Mounting Bracket. Cutting the Center Plate rings is easy and safe—leaving behind no burrs or sharp edges that could produce small injuries or potentially damage the light.

At nVent CADDY, we are committed to creating products that save time and keep contractors Working Smarter and safer on the job. Due to the design and convenience of the telescoping feature, wiring the light is simple and quick—ensuring less time is spent overhead on a ladder.

CERTIFICATIONS



FEATURES

Designed to be used with the nVent CADDY T-Grid Clip for Recessed Light Mounting Bracket for T-Grid Ceiling applications

For installation of differently sized lights between 4 and 8 in

Increased flexibility for installation with multiple fixture points

Sturdy and reliable bracket plate

Features an additional open slot that contractors can utilize for easy reach-through installations

Bracket is designed for easy visual, removing the need for hand measuring

SPECIFICATIONS

Table 1/1					
Catalog Number	Material	Finish	Length (L)	Width (W)	Height (H)
TBRL24	Steel	Pregalvanized	22.569"	13.2"	0.629"

DIAGRAMS

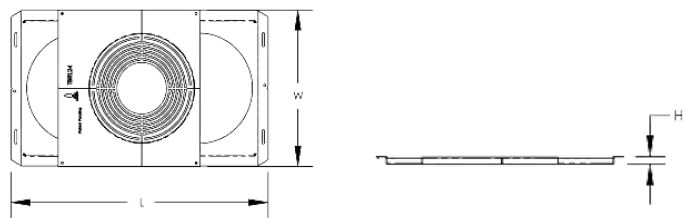

WARNING

nVent products shall be installed and used only as indicated in nVent's product instruction sheets and training materials. Instruction sheets are available at www.nvent.com and from your nVent customer service representative. Improper installation, misuse, misapplication or other failure to completely follow nVent's instructions and warnings may cause product malfunction, property damage, serious bodily injury and death and/or void your warranty.

North America

+1.800.753.9221
Option 1 – Customer Care
Option 2 – Technical
Support

Europe

Netherlands:
+31 800-0200135
France:
+33 800 901 793

Europe

Germany:
800 1890272
Other Countries:
+31 13 5835404

APAC

Shanghai:
+ 86 21 2412 1618/19
Sydney:
+61 2 9751 8500



Our powerful portfolio of brands:

CADDY ERICO HOFFMAN ILSCO SCHROFF TRACHTE

