

nVent CADDY Swift Clip Strut Clamp for Insulated Tube/Pipe



FEATURES

Secures pipe and insulation without a break, providing an uninterrupted vapor barrier seal which eliminates sweating on metal fittings

Snap-in and twist installation requires no tools

Fits directly into vertical and horizontal strut channels

For support and positioning of refrigeration, A/C tubing, PEX piping, conduit and cabling

Compliant with UL® 2043 and suitable for use in air handling (plenum) spaces

SPECIFICATIONS

Material: Polyamide

Working Temperature: -40 to 284 °F

Table 1/1

Catalog Number	Outer Diameter (OD)	Copper Tube Size	Pipe Size	Width (W)
TSMI0062	5/8"	1/2"		1 5/8"
TSMI0087	7/8"	3/4"	1/2"	1 5/8"
TSMI0075	3/4"	5/8"		1 5/8"
TSMI0100	1"		3/4"	1 5/8"

Catalog Number	Outer Diameter (OD)	Copper Tube Size	Pipe Size	Width (W)
TSMI0112	1 1/8"	1"		1 5/8"
TSMI0125	1 1/4"		1"	1 5/8"
TSMI0137	1 3/8"	1 1/4"		1 5/8"
TSMI0150	1 1/2"			1 5/8"
TSMI0162	1 5/8"	1 1/2"		1 5/8"
TSMI0200	2"			1 5/8"
TSMI0212	2 1/8"	2"		1 5/8"

ADDITIONAL PRODUCT DETAILS

Can also be used with PEX piping. For PEX pipe sizes, refer to the Copper Tube Size column.

Clip must be installed with temperature at or above 14 °F (-10 °C).

Part Number	Copper Tube with 3/8" Insulation	Copper Tube with 1/2" Insulation
TSMI0062	-	-
TSMI0075	-	-
TSMI0087	-	-
TSMI0100	1/4"	-
TSMI0112	3/8"	-
TSMI0125	1/2"	1/4"
TSMI0137	5/8"	3/8"
TSMI0150	7/8"	5/8"
TSMI0162	1 1/8"	3/4"
TSMI0200	-	7/8"
TSMI0212	1 3/8"	1 1/8"

DIAGRAMS

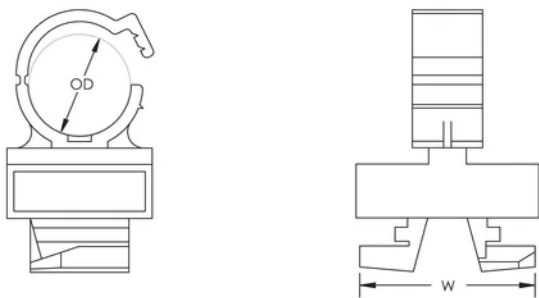

WARNING

nVent products shall be installed and used only as indicated in nVent's product instruction sheets and training materials. Instruction sheets are available at www.nvent.com and from your nVent customer service representative. Improper installation, misuse, misapplication or other failure to completely follow nVent's instructions and warnings may cause product malfunction, property damage, serious bodily injury and death and/or void your warranty.

North America

+1.800.753.9221
Option 1 – Customer Care
Option 2 – Technical
Support

Europe

Netherlands:
+31 800-0200135
France:
+33 800 901 793

Europe

Germany:
800 1890272
Other Countries:
+31 13 5835404

APAC

Shanghai:
+ 86 21 2412 1618/19
Sydney:
+61 2 9751 8500



Our powerful portfolio of brands:

CADDY ERICO HOFFMAN ILSCO SCHROFF TRACHTE

