

nVent CADDY Flared Slip Coupler



The nVent CADDY Flared Slip Couplers are designed for quick and simple conduit rack installations. The integrated flare helps align each piece of conduit to easily join and install prefabricated conduit racks. This design allows the coupler to simply slide over the conduit and have visual confirmation of correct insertion depth through the center viewport. Contractors can enjoy a significantly decreased amount of ladder time for overhead installations.

CERTIFICATIONS



FEATURES

Designed for EMT conduit

Fast and simple installation

Center viewport assists in conduit placement

SPECIFICATIONS

Table 1/1

Catalog Number	Length (L)	Width (W)	Height (H)	Depth (D)	Certifications
SC0050	1.795"	1.043"	1.499"	0.729"	
SC0075	2.185"	1.3"	1.756"	0.945"	UL, cUL
SC0100	2.72"	1.625"	2.075"	1.185"	UL, cUL
SC0125	3.325"	1.93"	2.39"	1.535"	UL, cUL

Catalog Number	Length (L)	Width (W)	Height (H)	Depth (D)	Certifications
SC0150	3.872"	2.388"	2.848"	1.772"	UL, cUL
SC0200	4.187"	2.85"	3.31"	2.234"	UL, cUL
SC0250	4.828"	3.854"	4.385"	2.92"	UL, cUL
SC0300	4.999"	4.41"	4.941"	3.552"	cUL, UL
SC0350	5.479"	5.242"	5.773"	4.057"	cUL, UL
SC0400	5.675"	5.748"	6.279"	4.563"	cUL, UL

DIAGRAMS

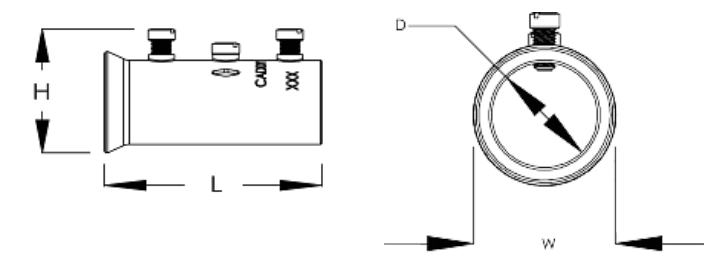

WARNING

nVent products shall be installed and used only as indicated in nVent's product instruction sheets and training materials. Instruction sheets are available at www.nvent.com and from your nVent customer service representative. Improper installation, misuse, misapplication or other failure to completely follow nVent's instructions and warnings may cause product malfunction, property damage, serious bodily injury and death and/or void your warranty.

North America

+1.800.753.9221
Option 1 – Customer Care
Option 2 – Technical Support

Europe

Netherlands:
+31 800-0200135
France:
+33 800 901 793

Europe

Germany:
800 1890272
Other Countries:
+31 13 5835404

APAC

Shanghai:
+ 86 21 2412 1618/19
Sydney:
+61 2 9751 8500



Our powerful portfolio of brands:

CADDY ERICO HOFFMAN ILSCO SCHROFF TRACHTE

