

# MC/AC Cable Support with Shot-Fire Bracket

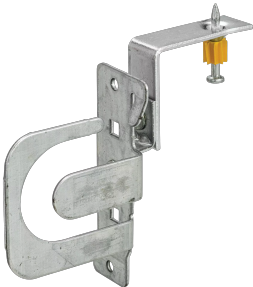

## FEATURES

Neatly isolates, supports and secures MC/AC cables

Properly spaces MC/AC cable to help eliminate bundling and NEC® & CEC derating issues

Results in a "neat and workmanlike" installation

Complete with shot-fire bracket and pre-assembled drive pin from DEWALT®

Quickly and easily attaches to concrete, steel or composite metal decking

Integrated pin installs easily using powder-actuated or single-shot gas-actuated tools

ICC-ES ESR-2024 evaluation report available for drive pin from DEWALT®

## SPECIFICATIONS

**Finish:** Electrogalvanized

**Material:** Steel

Table 1/2

Catalog Number	MC/AC Cable Size	Super Neutral Cable Size	Outer Diameter (OD)	Cable Capacity	Height (H)	Width (W)
MCS100SF	14-3 to 10-2	10-2	0.430" - 0.56"	8	4"	5"
MCS101SF	10-3 to 8-3	12-3 to 10-2	0.560" - 0.69"	7	4"	5"

Table 2/2

Catalog Number	A
----------------	---

MCS100SF	1.4"
MCS101SF	1.4"

## ADDITIONAL PRODUCT DETAILS

Uses Powers Fasteners, Inc. part number 50032.

Pre-assembled drive pin from Powers Fasteners, Inc. works with Powers® C4CZ, Simpson® GCN-MEPKT, SPIT® P1000, P200, P2201, P3500 / PA3500, P35s, P45, P60, P7201, Sniper; Ramset® 721, Cobra, D45 / D60 / D60L, M70, SA270, T3SS, TS750P, TS60P, Viper; Hilti® DX35, DX350 / DX351 / DX36M, DX100 / DX200, DX460, DXA40, DXA41, DXE72 / DX400; Würth® Diva-1, BST-1, BST-2 or equivalent nailers.

## DIAGRAMS

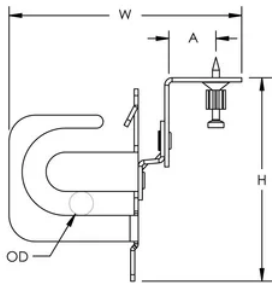

## WARNING

nVent products shall be installed and used only as indicated in nVent's product instruction sheets and training materials. Instruction sheets are available at [www.nvent.com](http://www.nvent.com) and from your nVent customer service representative. Improper installation, misuse, misapplication or other failure to completely follow nVent's instructions and warnings may cause product malfunction, property damage, serious bodily injury and death and/or void your warranty.

### North America

+1.800.753.9221

Option 1 – Customer Care

Option 2 – Technical

Support

### Europe

Netherlands:

+31 800-0200135

France:

+33 800 901 793

### Europe

Germany:

800 1890272

Other Countries:

+31 13 5835404

### APAC

Shanghai:

+ 86 21 2412 1618/19

Sydney:

+61 2 9751 8500



Our powerful portfolio of brands:

**CADDY**

**ERICO**

**HOFFMAN**

**ILSCO**

**SCHROFF**

**TRACHTE**

