

# HangerMate® Horizontal Mount Screw for Steel with Lock Nut



## FEATURES

Convenient design allows fast and easy installation

Eliminates the need for labor-intensive operations, such as pre-punching or drilling of steel components

Only one driver needed for all anchor sizes

Cross-drilled and tapped head permits horizontal mounting of threaded rod systems

## SPECIFICATIONS

Table 1/1

Catalog Number	Material	Finish	Rod Size (RS)	Flange Thickness (FT)	Screw Diameter (Sc)	Screw Length (L)
HMZH476	Steel	Electrogalvanized	3/8"	0.0600" - 1/4"	1/4"	1"

## DIAGRAMS

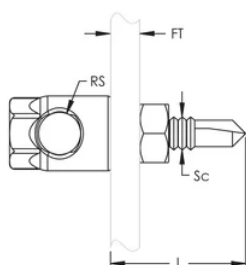

**WARNING**

nVent products shall be installed and used only as indicated in nVent's product instruction sheets and training materials. Instruction sheets are available at [www.nvent.com](http://www.nvent.com) and from your nVent customer service representative. Improper installation, misuse, misapplication or other failure to completely follow nVent's instructions and warnings may cause product malfunction, property damage, serious bodily injury and death and/or void your warranty.

**North America**

+1.800.753.9221  
Option 1 – Customer Care  
Option 2 – Technical  
Support

**Europe**

Netherlands:  
+31 800-0200135  
France:  
+33 800 901 793

**Europe**

Germany:  
800 1890272  
Other Countries:  
+31 13 5835404

**APAC**

Shanghai:  
+ 86 21 2412 1618/19  
Sydney:  
+61 2 9751 8500



Our powerful portfolio of brands:

**CADDY   ERICO   HOFFMAN   ILSCO   SCHROFF   TRACHTE**

