

Branch Line Restraint Pipe Attachment



CERTIFICATIONS



FEATURES

Accepts 3/8" or 1/2" (M10 or M12) threaded rod

Quick grip clamp simplifies measuring and cutting of threaded rod

Eliminates need to cut threaded rod to exact dimensions

Works with rough-cut threaded rod and eliminates pipe-side deburring

Can be installed with threaded rod above or below the service pipe

Shear-off head helps ensure correct torque and simplifies inspection

SPECIFICATIONS

Finish: Electrogalvanized

Material: Steel

Table 1/1

Catalog Number	Pipe Size	Outer Diameter (OD)	Rod Size (RS)	Height (H)	Length (L)	Width (W)
CSBBRP0100E G	1"	1.32"	3/8", 1/2"	2.9"	1.63"	0.88"

CatalogNumber	Pipe Size	Outer Diameter (OD)	Rod Size (RS)	Height (H)	Length (L)	Width (W)
CSBBRP0125E G	1 1/4" Min	1.66"	3/8", 1/2"	3 1/4"	1.97"	0.88"
CSBBRP0150E G	1 1/2"	1.9"	3/8", 1/2"	3 1/2"	2.21"	0.88"
CSBBRP0200E G	2" Min	2.38"	3/8", 1/2"	3.95"	2.69"	0.88"

DIAGRAMS

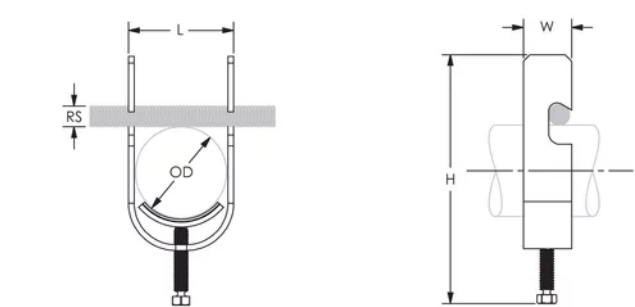

WARNING

nVent products shall be installed and used only as indicated in nVent's product instruction sheets and training materials. Instruction sheets are available at www.nvent.com and from your nVent customer service representative. Improper installation, misuse, misapplication or other failure to completely follow nVent's instructions and warnings may cause product malfunction, property damage, serious bodily injury and death and/or void your warranty.

North America

+1.800.753.9221
Option 1 – Customer Care
Option 2 – Technical Support

Europe

Netherlands:
+31 800-0200135
France:
+33 800 901 793

Europe

Germany:
800 1890272
Other Countries:
+31 13 5835404

APAC

Shanghai:
+ 86 21 2412 1618/19
Sydney:
+61 2 9751 8500



Our powerful portfolio of brands:

CADDY ERICO HOFFMAN ILSCO SCHROFF TRACHTE

