

# 401 Clevis Hanger



## CERTIFICATIONS



## FEATURES

Recommended for the suspension of stationary non-insulated pipe lines

Flared edges help prevent sharp surfaces from coming into contact with the pipe (1/2" to 2" pipe sizes)

Clevis bottom pivots to allow pipe to be fed from either direction

Conforms with Federal Specification WW-H-171 (Type 1), Manufacturers Standardization Society (MSS) SP-58 (Type 1)

## SPECIFICATIONS

**Material:** Steel

Table 1/2

Catalog Number	Finish	Pipe Size	Outer Diameter (OD)	Rod Size (RS)	A	B
4010050EG	Electrogalvanized, Pregalvanized	1/2"	0.84"	3/8"	2 5/16"	1 1/8"
4010075EG	Electrogalvanized, Pregalvanized	3/4"	1.05"	3/8"	2 1/2"	1 1/4"

CatalogNumber	Finish	Pipe Size	Outer Diameter (OD)	Rod Size (RS)	A	B
4010100EG	Electrogalvanized, Pregalvanized	1"	1.31"	3/8"	2 13/16"	1 3/8"
4010125EG	Electrogalvanized, Pregalvanized	1 1/4" Min	1.66"	3/8"	3 1/8"	1 9/16"
4010150EG	Electrogalvanized, Pregalvanized	1 1/2"	1.9"	3/8"	3 11/16"	2 1/16"
4010200EG	Electrogalvanized, Pregalvanized	2" Min	2 3/8"	3/8"	4 5/16"	2 1/2"
4010250EG	Electrogalvanized, Pregalvanized	2 1/2"	2 7/8"	1/2"	5 5/16"	3 1/16"
4010250HD	Hot-Dip Galvanized	2 1/2"	2 7/8"	1/2"	5 1/4"	2 13/16"
4010300EG	Electrogalvanized, Pregalvanized	3"	3 1/2"	1/2"	6 1/16"	3 1/2"
4010300HD	Hot-Dip Galvanized	3"	3 1/2"	1/2"	6"	3 1/4"
4010350EG	Electrogalvanized, Pregalvanized	3 1/2"	4"	1/2"	6 13/16"	4"
4010400EG	Electrogalvanized, Pregalvanized	4"	4 1/2"	5/8"	7 7/16"	4 3/8"
4010400HD	Hot-Dip Galvanized	4"	4 1/2"	5/8"	7 3/4"	4 1/4"
4010500EG	Electrogalvanized, Pregalvanized	5"	5 9/16"	5/8"	9 1/16"	5 1/8"
4010600EG	Electrogalvanized, Pregalvanized	6"	6 5/8"	3/4"	10 9/16"	6"
4010800EG	Electrogalvanized, Pregalvanized	8"	8 5/8"	3/4"	14"	8"
4011000EG	Electrogalvanized, Pregalvanized	10"	10 3/4"	7/8"	16 1/2"	9"

CatalogNumber	Finish	Pipe Size	Outer Diameter (OD)	Rod Size (RS)	A	B
4011200EG	Electrogalvanized, Pregalvanized	12"	12 3/4"	7/8"	18 5/8"	10 3/16"
4011400EG	Electrogalvanized, Pregalvanized	14"	14"	1"	21 3/4"	12 1/8"
4011600EG	Electrogalvanized, Pregalvanized	16"	16"	1"	24"	13 1/2"
4011800EG	Electrogalvanized, Pregalvanized	18"	18"	1 1/8"	26 3/4"	15"
4012000EG	Electrogalvanized, Pregalvanized	20"	20"	1 1/4"	30"	17"

Table 2/2

Catalog Number	C	Static Load (F)	Certifications
4010050EG	3/8"	600lbf	cUL, ITB, UL
4010075EG	3/8"	600lbf	cUL, UL, ITB
4010100EG	3/8"	600lbf	UL, cUL, ITB
4010125EG	3/8"	600lbf	ITB, UL, cUL
4010150EG	11/16"	600lbf	UL, ITB, cUL
4010200EG	7/8"	600lbf	cUL, ITB, UL
4010250EG	1"	1130lbf	cUL, UL, ITB
4010250HD	11/16"	1130lbf	UL, cUL
4010300EG	1 1/8"	1130lbf	UL, cUL, ITB
4010300HD	7/8"	1130lbf	cUL, UL

Catalog Number	C	Static Load (F)	Certifications
4010350EG	1 5/16"	1130lbf	UL, cUL
4010400EG	1 3/8"	1130lbf	ITB, cUL, UL
4010400HD	1 3/4"	1130lbf	UL, cUL
4010500EG	1 5/8"	1430lbf	UL, cUL, ITB
4010600EG	1 7/8"	1940lbf	UL, ITB, cUL
4010800EG	3 1/8"	2000lbf	UL, cUL, ITB
4011000EG	2 9/16"	3600lbf	ITB
4011200EG	3 1/16"	3800lbf	ITB
4011400EG	4 3/8"	4200lbf	ITB
4011600EG	4 5/8"	4600lbf	ITB
4011800EG	5 1/8"	4800lbf	ITB
4012000EG	6"	4800lbf	ITB

## DIAGRAMS

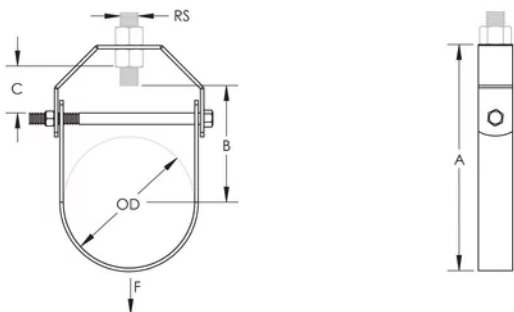

## WARNING

nVent products shall be installed and used only as indicated in nVent's product instruction sheets and training materials. Instruction sheets are available at [www.nvent.com](http://www.nvent.com) and from your nVent customer service representative. Improper installation, misuse, misapplication or other failure to completely follow nVent's instructions and warnings may cause

product malfunction, property damage, serious bodily injury and death and/or void your warranty.

**North America**

+1.800.753.9221  
Option 1 – Customer Care  
Option 2 – Technical  
Support

**Europe**

Netherlands:  
+31 800-0200135  
France:  
+33 800 901 793

**Europe**

Germany:  
800 1890272  
Other Countries:  
+31 13 5835404

**APAC**

Shanghai:  
+ 86 21 2412 1618/19  
Sydney:  
+61 2 9751 8500



Our powerful portfolio of brands:

**CADDY   ERICO   HOFFMAN   ILSCO   SCHROFF   TRACHTE**

