

360 Adjustable Center-Load Beam Clamp Kit



FEATURES

Includes Series 26 Beam Clamp Extension Piece

SPECIFICATIONS

Material: Steel;Cast Iron

Finish: Plain

Table 1/1

Catalog Number	Rod Size (RS)	Pipe Size	MRI	Static Load (F)
3600037PL	3/8"	2" Max	7/8"	600lb
3600050PL	1/2"	3 1/2" Max	15/16"	1130lb
3600062PL	5/8"	5" Max	1 3/8"	1365lb
3600075PL	3/4"		1 3/8"	1365lb
3600087PL	7/8"		1 1/4"	1365lb

ADDITIONAL PRODUCT DETAILS

Reduced hanger spacing is required when supporting 10" and 12" pipe.

Install in accordance with applicable code.

Part Number	A-2" B	A-3" B	A-4" B	A-5" B	A-6" B	A-7" B
3600037PL	5 5/16"	5 1/16"	4 15/16"	4 11/16"	5 1/8"	3 9/16"
3600050PL	5 5/16"	5 1/16"	4 15/16"	4 11/16"	5 1/8"	3 9/16"
3600062PL	5 1/2"	5 1/4"	5 1/8"	4 7/8"	5 5/16"	3 3/4"
3600075PL	5 1/2"	5 1/4"	5 1/8"	4 7/8"	5 5/16"	3 3/4"
3600087PL	5 3/4"	5 1/2"	5 3/8"	5 1/8"	5 9/16"	4"

DIAGRAMS

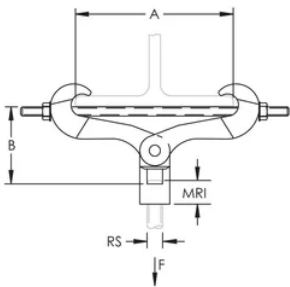

WARNING

nVent products shall be installed and used only as indicated in nVent's product instruction sheets and training materials. Instruction sheets are available at www.nvent.com and from your nVent customer service representative. Improper installation, misuse, misapplication or other failure to completely follow nVent's instructions and warnings may cause product malfunction, property damage, serious bodily injury and death and/or void your warranty.

North America

+1.800.753.9221
Option 1 – Customer Care
Option 2 – Technical
Support

Europe

Netherlands:
+31 800-0200135
France:
+33 800 901 793

Europe

Germany:
800 1890272
Other Countries:
+31 13 5835404

APAC

Shanghai:
+ 86 21 2412 1618/19
Sydney:
+61 2 9751 8500



Our powerful portfolio of brands:

CADDY ERICO HOFFMAN ILSCO SCHROFF TRACHTE

