

150M Standard U-Bolt

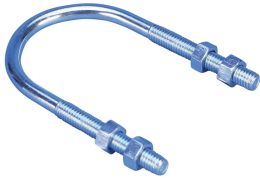

FEATURES

Pipe support for general piping applications

Comes complete with 4 nuts (2 installed on each end)

Conforms with Federal Specification WW-H-171 (Type 24), Manufacturers Standardization Society ANSI®/MSS-SP-58 (Type 24)

SPECIFICATIONS

Finish: Electrogalvanized

Material: Steel

Table 1/2

Catalog Number	Pipe Size	Outer Diameter (OD)	Rod Size (RS)	Screw Length (L)	A
150M0100EG	1"	1.31"	1/4"	2 3/8"	3 11/16"
150M0125EG	1 1/4" Min	1.66"	3/8"	2 3/8"	4 1/8"
150M0150EG	1 1/2"	1.9"	3/8"	2 1/2"	4 5/16"
150M0200EG	2" Min	2 3/8"	3/8"	2 1/2"	4 13/16"
150M0250EG	2 1/2"	2 7/8"	1/2"	3"	5 3/4"

Catalog Number	Pipe Size	Outer Diameter (OD)	Rod Size (RS)	Screw Length (L)	A
150M0300EG	3"	3 1/2"	1/2"	3"	6 5/16"
150M0400EG	4"	4 1/2"	1/2"	3"	7 5/16"
150M0500EG	5"	5 9/16"	1/2"	3"	8 5/16"
150M0600EG	6"	6 5/8"	5/8"	3 3/4"	10 1/8"
150M0800EG	8"	8 5/8"	5/8"	3 3/4"	12 1/8"
150M1000EG	10"	10 3/4"	3/4"	4"	14 9/16"
150M1200EG	12"	12 3/4"	7/8"	4 1/4"	16 15/16"

Table 2/2

Catalog Number	B	Static Load (F)
150M0100EG	1 9/16"	435lb
150M0125EG	2 1/16"	1090lb
150M0150EG	2 1/4"	1090lb
150M0200EG	2 3/4"	1090lb
150M0250EG	3 3/8"	2020lb
150M0300EG	4"	2020lb
150M0400EG	5"	2020lb
150M0500EG	6 1/16"	2020lb
150M0600EG	7 1/4"	3230lb
150M0800EG	9 1/4"	3230lb

Catalog Number	B	Static Load (F)
150M1000EG	11 1/2"	4830lb
150M1200EG	13 5/8"	6730lb

DIAGRAMS

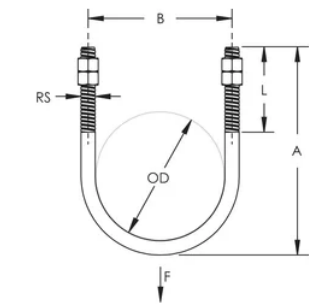

WARNING

nVent products shall be installed and used only as indicated in nVent's product instruction sheets and training materials. Instruction sheets are available at www.nvent.com and from your nVent customer service representative. Improper installation, misuse, misapplication or other failure to completely follow nVent's instructions and warnings may cause product malfunction, property damage, serious bodily injury and death and/or void your warranty.

North America

+1.800.753.9221
Option 1 – Customer Care
Option 2 – Technical
Support

Europe

Netherlands:
+31 800-0200135
France:
+33 800 901 793

Europe

Germany:
800 1890272
Other Countries:
+31 13 5835404

APAC

Shanghai:
+ 86 21 2412 1618/19
Sydney:
+61 2 9751 8500



Our powerful portfolio of brands:

CADDY ERICO HOFFMAN ILSCO SCHROFF TRACHTE

