

# Drive Pin Grommet



Grommets hold the wedge pins in place during assembly. One spare grommet is included with each package of couplers and wedge pins. Replacement grommets are made available as a convenience, should any get lost on the jobsite.

## FEATURES

Easily replaced when worn

## SPECIFICATIONS

Table 1/2

| Catalog Number | Article Number | Rebar Size, Metric | Rebar Size, US | Rebar Size, Canada | Diameter 1 (Ø1) | Diameter 2 (Ø2) |
|----------------|----------------|--------------------|----------------|--------------------|-----------------|-----------------|
| ML520          | 145800         | 12 mm, 16 mm       | #4, #5         | 10M, 15M           | 25 mm           | 13 mm           |
| ML521          | 145820         | 20 mm              | #6             | 20M                | 29 mm           | 16 mm           |

Table 2/2

| Catalog Number | Article Number | Thickness (T) | Unit Weight |
|----------------|----------------|---------------|-------------|
| ML520          | 145800         | 7 mm          | 0.05 kg     |
| ML521          | 145820         | 8 mm          | 0.05 kg     |

## ADDITIONAL PRODUCT DETAILS

Prior to installation, please read and understand the detailed instructions and safety notices provided in the nVent LENTON Quick Wedge Operator's Manual.

## DIAGRAMS

---

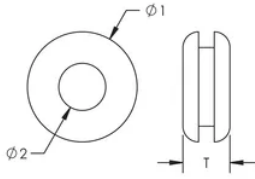

## WARNING

---

nVent products shall be installed and used only as indicated in nVent's product instruction sheets and training materials. Instruction sheets are available at [www.nvent.com](http://www.nvent.com) and from your nVent customer service representative. Improper installation, misuse, misapplication or other failure to completely follow nVent's instructions and warnings may cause product malfunction, property damage, serious bodily injury and death and/or void your warranty.

### North America

+1.800.753.9221

Option 1 – Customer Care

Option 2 – Technical

Support

### Europe

Netherlands:

+31 800-0200135

France:

+33 800 901 793

### Europe

Germany:

800 1890272

Other Countries:

+31 13 5835404

### APAC

Shanghai:

+ 86 21 2412 1618/19

Sydney:

+61 2 9751 8500



Our powerful portfolio of brands:

**CADDY**

**ERICO**

**HOFFMAN**

**ILSCO**

**SCHROFF**

**TRACHTE**