

# nVent ERIFLEX Flexbus Pre-assembled Supports

The nVent ERIFLEX Flexbus Pre-assembled Supports is a versatile, and user-friendly solution designed to complement your Flexbus installations. This innovative system is composed of a pre-assembled support and an aluminum profile, allowing it to accommodate multiple conductor configurations. Whether you need flat or on-edge positions, side-by-side or on top, this support system can be mounted directly to cable trays or on walls and ceilings.

The Flexbus Pre-assembled Supports are pre-mounted, guaranteeing substantial time savings during installation. By opting for these ready-to-go supports, you can reduce the total installation time for a Flexbus connection by approximately 20%.

This version of the Flexbus Supports features a single part number, with rails pre-cut to size and all components (inserts, threaded rods, bolts, and plastic modules) already mounted on the aluminum rail. No assembly is required. Simply mount the support on a cable tray or directly to the wall or ceiling. For standard Flexbus conductor routing, using these pre-assembled brackets significantly reduces installation time, making your setup process smoother and more efficient.

Engineered for reliability and safety, the nVent ERIFLEX Flexbus Pre-assembled Supports have been short-circuit tested and provides strong mechanical resistance to electromagnetic forces. It supports various neutral systems such as 3P or 3P+N and allows for easy routing in case of phase inversion or neutral rotation.



## CERTIFICATIONS



## FEATURES

Save even more installation time with Flexbus Pre-assembled Supports

Adjustable clip adapts to different conductor thicknesses with open and closed positions

Strong mechanical resistance and short-circuit tested as per IEC 61914 standards, withstanding up to 67kA rms and 147kA Peak

Suitable for 3P, 3P+N, and conductors in flat or on-edge configurations

Can be mounted on ceilings or walls

Designed to fit different types of cable trays

Can be mounted horizontally or vertically

## SPECIFICATIONS

|                                          |                                                                 |
|------------------------------------------|-----------------------------------------------------------------|
| <b>Insulation Voltage:</b>               | 1000;1500                                                       |
| <b>Dielectric Strength, IEC 61439.1:</b> | 3500 VAC @ 1 min                                                |
| <b>Finish:</b>                           | Electrogalvanized                                               |
| <b>Material:</b>                         | Glass Fibre Reinforced Polyamide;Steel                          |
| <b>Complies With:</b>                    | IEC® 60695-2-11 (Glow Wire Test 960 °C);IEC® 61439.1;IEC® 61914 |
| <b>Halogen Free Rating:</b>              | IEC® 60754-1                                                    |
| <b>Low Smoke Rating:</b>                 | ISO 5659-2                                                      |
| <b>Flammability Rating:</b>              | UL® 94V-0                                                       |
| <b>Working Temperature:</b>              | -40 to 130 °C                                                   |

Table 1/2

| Catalog Number      | Article Number | Depth (D) | Width (W) | Height (H) | Conductor Size                       | Number of Phases |
|---------------------|----------------|-----------|-----------|------------|--------------------------------------|------------------|
| FLEXSUEDG100<br>T1  | 508604         | 78mm      | 375mm     | 176mm      | 800 mm², 960 mm², 1280 mm², 1810 mm² | 3                |
| FLEXSUEDG100<br>TN1 | 508606         | 78mm      | 475mm     | 176mm      | 800 mm², 960 mm², 1280 mm², 1810 mm² | 3                |
| FLEXSUEDG50T<br>1   | 508600         | 78mm      | 337.5mm   | 126mm      | 220 mm², 360 mm², 545 mm², 640 mm²   | 3                |
| FLEXSUEDG50T<br>N1  | 508602         | 78mm      | 425mm     | 126mm      | 220 mm², 360 mm², 545 mm², 640 mm²   | 3                |
| FLEXSUFLA100<br>T1  | 508612         | 78mm      | 487.5mm   | 130mm      | 800 mm², 960 mm², 1280 mm², 1810 mm² | 3                |
| FLEXSUFLA100<br>TN1 | 508614         | 78mm      | 625mm     | 130mm      | 800 mm², 960 mm², 1280 mm², 1810 mm² | 3                |

| CatalogNumber       | Article Number | Depth (D) | Width (W) | Height (H) | Conductor Size                                                                          | Number of Phases |
|---------------------|----------------|-----------|-----------|------------|-----------------------------------------------------------------------------------------|------------------|
| FLEXSUFLA50T<br>1   | 508608         | 78mm      | 337.5mm   | 126mm      | 220 mm <sup>2</sup> , 360 mm <sup>2</sup> , 545 mm <sup>2</sup> , 640 mm <sup>2</sup>   | 3                |
| FLEXSUFLA50T<br>N1  | 508610         | 78mm      | 425mm     | 126mm      | 220 mm <sup>2</sup> , 360 mm <sup>2</sup> , 545 mm <sup>2</sup> , 640 mm <sup>2</sup>   | 3                |
| FLEXSUEDG100<br>T2  | 508605         | 78mm      | 375mm     | 340mm      | 800 mm <sup>2</sup> , 960 mm <sup>2</sup> , 1280 mm <sup>2</sup> , 1810 mm <sup>2</sup> | 3                |
| FLEXSUEDG100<br>TN2 | 508607         | 78mm      | 475mm     | 340mm      | 800 mm <sup>2</sup> , 960 mm <sup>2</sup> , 1280 mm <sup>2</sup> , 1810 mm <sup>2</sup> | 3                |
| FLEXSUEDG50T<br>2   | 508601         | 78mm      | 337.5mm   | 240mm      | 220 mm <sup>2</sup> , 360 mm <sup>2</sup> , 545 mm <sup>2</sup> , 640 mm <sup>2</sup>   | 3                |
| FLEXSUEDG50T<br>N2  | 508603         | 78mm      | 425mm     | 240mm      | 220 mm <sup>2</sup> , 360 mm <sup>2</sup> , 545 mm <sup>2</sup> , 640 mm <sup>2</sup>   | 3                |
| FLEXSUFLA100<br>T2  | 508613         | 78mm      | 487.5mm   | 248mm      | 800 mm <sup>2</sup> , 960 mm <sup>2</sup> , 1280 mm <sup>2</sup> , 1810 mm <sup>2</sup> | 3                |
| FLEXSUFLA100<br>TN2 | 508615         | 78mm      | 625mm     | 248mm      | 800 mm <sup>2</sup> , 960 mm <sup>2</sup> , 1280 mm <sup>2</sup> , 1810 mm <sup>2</sup> | 3                |
| FLEXSUFLA50T<br>2   | 508609         | 78mm      | 337.5mm   | 240mm      | 220 mm <sup>2</sup> , 360 mm <sup>2</sup> , 545 mm <sup>2</sup> , 640 mm <sup>2</sup>   | 3                |
| FLEXSUFLA50T<br>N2  | 508611         | 78mm      | 425mm     | 240mm      | 220 mm <sup>2</sup> , 360 mm <sup>2</sup> , 545 mm <sup>2</sup> , 640 mm <sup>2</sup>   | 3                |

Table 2/2

| Catalog Number  | Article Number | Conductor Quantity | Orientation | Unit Weight |
|-----------------|----------------|--------------------|-------------|-------------|
| FLEXSUEDG100T1  | 508604         | 1                  | On Edge     | 1.87 kg     |
| FLEXSUEDG100TN1 | 508606         | 1                  | On Edge     | 2.44 kg     |

| Catalog Number  | Article Number | Conductor Quantity | Orientation | Unit Weight |
|-----------------|----------------|--------------------|-------------|-------------|
| FLEXSUEDG50T1   | 508600         | 1                  | On Edge     | 1.4 kg      |
| FLEXSUEDG50TN1  | 508602         | 1                  | On Edge     | 1.77 kg     |
| FLEXSUFLA100T1  | 508612         | 1                  | Flat        | 1.93 kg     |
| FLEXSUFLA100TN1 | 508614         | 1                  | Flat        | 2.49 kg     |
| FLEXSUFLA50T1   | 508608         | 1                  | Flat        | 1.34 kg     |
| FLEXSUFLA50TN1  | 508610         | 1                  | Flat        | 1.69 kg     |
| FLEXSUEDG100T2  | 508605         | 2                  | On Edge     | 3.46 kg     |
| FLEXSUEDG100TN2 | 508607         | 2                  | On Edge     | 4.54 kg     |
| FLEXSUEDG50T2   | 508601         | 2                  | On Edge     | 2.49 kg     |
| FLEXSUEDG50TN2  | 508603         | 2                  | On Edge     | 3.17 kg     |
| FLEXSUFLA100T2  | 508613         | 2                  | Flat        | 3.48 kg     |
| FLEXSUFLA100TN2 | 508615         | 2                  | Flat        | 4.52 kg     |
| FLEXSUFLA50T2   | 508609         | 2                  | Flat        | 2.37 kg     |
| FLEXSUFLA50TN2  | 508611         | 2                  | Flat        | 3.01 kg     |

**Installation Standard:** AS 3008;BS 7671;CEI 64-8;CSN;DIN VDE 0100;HD 384;IEC® 60364

## ADDITIONAL PRODUCT DETAILS

When using a cable tray, we recommend installing a Flexbus Support at each end to protect the Flexbus Conductor from potential sharp edges.

For easier installation of the Flexbus Conductors on cable trays, we suggest using cantilever systems to provide easy and direct access during the installation phases.

DIAGRAMS

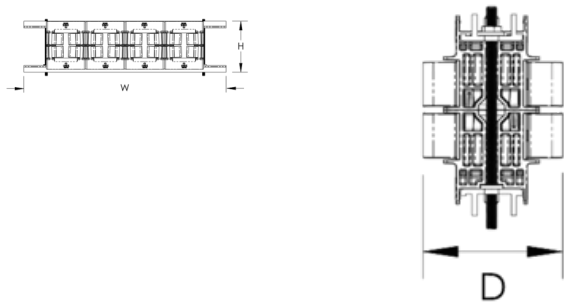

WARNING

nVent products shall be installed and used only as indicated in nVent's product instruction sheets and training materials. Instruction sheets are available at [www.nvent.com](http://www.nvent.com) and from your nVent customer service representative. Improper installation, misuse, misapplication or other failure to completely follow nVent's instructions and warnings may cause product malfunction, property damage, serious bodily injury and death and/or void your warranty.

North America

+1.800.753.9221  
Option 1 – Customer Care  
Option 2 – Technical  
Support

Europe

Netherlands:  
+31 800-0200135  
France:  
+33 800 901 793

Europe

Germany:  
800 1890272  
Other Countries:  
+31 13 5835404

APAC

Shanghai:  
+ 86 21 2412 1618/19  
Sydney:  
+61 2 9751 8500



Our powerful portfolio of brands:

CADDY   ERICO   HOFFMAN   ILSCO   SCHROFF   TRACHTE