

# SK Single Piece Strut Clamp for Conduit



## CERTIFICATIONS



## FEATURES

One piece break apart strut clamp for EMT and Rigid conduit

Includes thread impression and captured screw

## SPECIFICATIONS

**Finish:** Electrogalvanized

**Material:** Steel

Table 1/1

Catalog Number	Article Number	Outer Diameter (OD)	Width (W)	Static Load
SK85I	190090	17.9 - 21.3 mm	32 mm	890N
SK125I	190000	23.4 - 26.7 mm	32 mm	890N
SK165I	190010	29.5 - 33.4 mm	32 mm	890N

Catalog Number	Article Number	Outer Diameter (OD)	Width (W)	Static Load
SK205I	190020	38.4 - 42.2 mm	32 mm	890N
SK245I	190030	44.2 - 48.3 mm	32 mm	890N
SK325I	190040	55.8 - 60.3 mm	32 mm	890N
SK405I	190050	73 mm	32 mm	1560N
SK485I	190060	88.9 mm	32 mm	1560N
SK565I		101.6 mm	32 mm	1560N
SK645I	190080	114.3 mm	32 mm	1560N

## DIAGRAMS

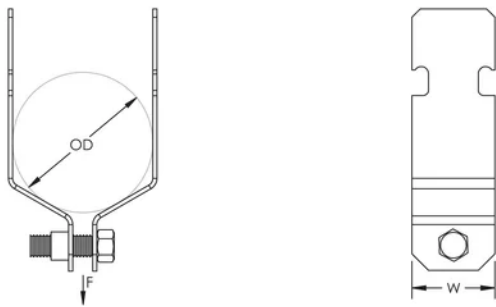

## WARNING

nVent products shall be installed and used only as indicated in nVent's product instruction sheets and training materials. Instruction sheets are available at [www.nvent.com](http://www.nvent.com) and from your nVent customer service representative. Improper installation, misuse, misapplication or other failure to completely follow nVent's instructions and warnings may cause product malfunction, property damage, serious bodily injury and death and/or void your warranty.

#### North America

+1.800.753.9221

Option 1 – Customer Care

Option 2 – Technical

Support

#### Europe

Netherlands:

+31 800-0200135

France:

+33 800 901 793

#### Europe

Germany:

800 1890272

Other Countries:

+31 13 5835404

#### APAC

Shanghai:

+ 86 21 2412 1618/19

Sydney:

+61 2 9751 8500



Our powerful portfolio of brands:

**CADDY**

**ERICO**

**HOFFMAN**

**ILSCO**

**SCHROFF**

**TRACHTE**

