

P14 Position Coupler, Male and Nut Only, Worldwide Design

Used in segmental pour and closure pour applications. Male and female components are sold separately.



FEATURES

Designed to splice two curved, bent or straight bars, when neither bar can be rotated and where the ongoing bar is free to move in its axial direction

SPECIFICATIONS

Finish: Plain
Coupler Adjustment: Standard
Material: Steel

Table 1/2

Catalog Number	Rebar Size, Metric	Rebar Size, US	Rebar Size, Canada	Diameter (Ø)	Length (L)	A
EL10P14LMN	10 mm	#3		20 mm	69mm	49 mm
EL12P14LMN	12 mm	#4	10M	20 mm	72mm	48 mm
EL14P14LMN	14 mm			20 mm	76mm	50 mm
EL16P14LMN	16 mm	#5	15M	25 mm	81mm	54 mm
EL18P14LMN	18 mm			25 mm	88mm	60 mm

CatalogNumber	Rebar Size, Metric	Rebar Size, US	Rebar Size, Canada	Diameter (Ø)	Length (L)	A
EL20P14LMN	20 mm	#6	20M	30 mm	108mm	72 mm
EL22P14LMN	22 mm	#7		35 mm	114mm	76 mm
EL25P14LMN	25 mm	#8	25M	35 mm	120mm	78 mm
EL28P14LMN	28 mm	#9	30M	40 mm	124mm	81 mm
EL32P14LMN	32 mm	#10		45 mm	138mm	91 mm
EL36P14LMN	36 mm	#11	35M	50 mm	146mm	97 mm
EL40P14LMN	40 mm			55 mm	155mm	104 mm

Table 2/2

Catalog Number	Bar Depth (BD)	Thread Size (TS)	Unit Weight
EL10P14LMN	18mm	M18	0.16 kg
EL12P14LMN	19mm	M18	0.16 kg
EL14P14LMN	21mm	M18	0.16 kg
EL16P14LMN	24mm	M22	0.26 kg
EL18P14LMN	29mm	M24	0.31 kg
EL20P14LMN	35mm	M26	0.46 kg
EL22P14LMN	37mm	M31	0.69 kg
EL25P14LMN	40mm	M34	0.77 kg
EL28P14LMN	42mm	M37	0.99 kg
EL32P14LMN	45mm	M42	1.48 kg

Catalog Number	Bar Depth (BD)	Thread Size (TS)	Unit Weight
EL36P14LMN	52mm	M46	1.86 kg
EL40P14LMN	57mm	M53	2.41 kg

ADDITIONAL PRODUCT DETAILS

Bar dimensions and weights listed may vary by region. Coupler sizes not shown may be available by special order. Contact your nVent LENTON representative for more information.

DIAGRAMS

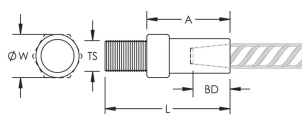

WARNING

nVent products shall be installed and used only as indicated in nVent's product instruction sheets and training materials. Instruction sheets are available at www.nvent.com and from your nVent customer service representative. Improper installation, misuse, misapplication or other failure to completely follow nVent's instructions and warnings may cause product malfunction, property damage, serious bodily injury and death and/or void your warranty.

North America

+1.800.753.9221
Option 1 – Customer Care
Option 2 – Technical
Support

Europe

Netherlands:
+31 800-0200135
France:
+33 800 901 793

Europe

Germany:
800 1890272
Other Countries:
+31 13 5835404

APAC

Shanghai:
+ 86 21 2412 1618/19
Sydney:
+61 2 9751 8500



Our powerful portfolio of brands:

CADDY ERICO HOFFMAN ILSCO SCHROFF TRACHTE