

# Early Streamer Emission Terminal to ER-Series Mast Adaptor



## FEATURES

INTCPTSIER1 connects nVent ERICO System 1000 air terminals to ER stainless steel upper mast sections

INTCPTSIER2 connects nVent ERICO System 1000 air terminals to ER stainless steel middle mast sections

## SPECIFICATIONS

**Material:** Stainless Steel 304 (EN 1.4301)

Table 1/1

Catalog Number	Thread Size 1 (TS1)	Thread Size 2 (TS2)	Diameter (Ø)	Height (H)	Unit Weight
INTCPTSIER1	3/4" UNC	M25	38.1 mm	65 mm	0.24 kg
INTCPTSIER2	1 1/16" UNC	M25	38.1 mm	65 mm	0.28 kg

## DIAGRAMS

---

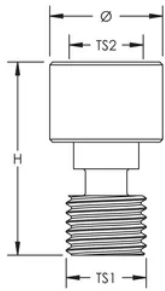

## WARNING

---

nVent products shall be installed and used only as indicated in nVent's product instruction sheets and training materials. Instruction sheets are available at [www.nvent.com](http://www.nvent.com) and from your nVent customer service representative. Improper installation, misuse, misapplication or other failure to completely follow nVent's instructions and warnings may cause product malfunction, property damage, serious bodily injury and death and/or void your warranty.

### North America

+1.800.753.9221

Option 1 – Customer Care

Option 2 – Technical

Support

### Europe

Netherlands:

+31 800-0200135

France:

+33 800 901 793

### Europe

Germany:

800 1890272

Other Countries:

+31 13 5835404

### APAC

Shanghai:

+ 86 21 2412 1618/19

Sydney:

+61 2 9751 8500



Our powerful portfolio of brands:

**CADDY**

**ERICO**

**HOFFMAN**

**ILSCO**

**SCHROFF**

**TRACHTE**