

# nVent ERICO PermaGround Cast Beam Bonding Clamp

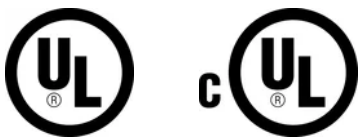

nVent ERICO PermaGround Cast Beam Bonding Clamp is a device used to establish a secure electrical connection between a cable and a flat metal object, like an I-beam or channel iron. It's designed for applications where grounding or bonding of electrical systems is necessary, ensuring the safe flow of electrical current.

## CERTIFICATIONS



## FEATURES

Clamp for bonding cable to flat metal objects such as I-beams, angle irons and channel irons

## SPECIFICATIONS

**Finish:** Bare

Table 1/1

Catalog Number	Conductor Size, UL	Material	Flange Thickness (FT)	Depth (D)	Width (W)	Unit Weight
LPA559	Class 1 - Class 2 (4/0 Max)	Aluminum	6.35 mm Max	57.15mm	40.6 mm	0.06 kg
LPC559	Class 1 - Class 2 (4/0 Max)	Copper	6.35 mm Max	57.15mm	40.6 mm	0.17 kg

DIAGRAMS

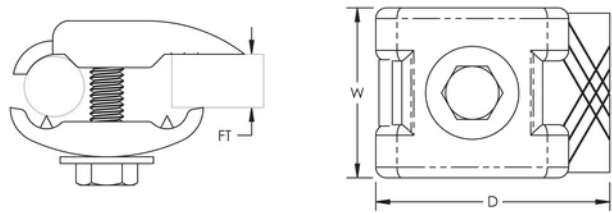

WARNING

nVent products shall be installed and used only as indicated in nVent's product instruction sheets and training materials. Instruction sheets are available at [www.nvent.com](http://www.nvent.com) and from your nVent customer service representative. Improper installation, misuse, misapplication or other failure to completely follow nVent's instructions and warnings may cause product malfunction, property damage, serious bodily injury and death and/or void your warranty.

North America

+1.800.753.9221  
Option 1 – Customer Care  
Option 2 – Technical  
Support

Europe

Netherlands:  
+31 800-0200135  
France:  
+33 800 901 793

Europe

Germany:  
800 1890272  
Other Countries:  
+31 13 5835404

APAC

Shanghai:  
+ 86 21 2412 1618/19  
Sydney:  
+61 2 9751 8500



Our powerful portfolio of brands:

CADDY   ERICO   HOFFMAN   ILSCO   SCHROFF   TRACHTE