

nVent ERICO Ericontact Insertion Mandrel



FEATURES

Enables insertion of nVent ERICO Ericontact Single Rail Contact Bushing and nVent ERICO Ericontact Double Rail Contact Bushing into a calibrated drill hole

Ensures the proper insertion of a long-lasting, quality connection

Suitable for HSKE and ASKE nVent ERICO Ericontact Insertion Tools

SPECIFICATIONS

Table 1/1

Catalog Number	Article Number	Material	Length (L)	Diameter (Ø)	Thread Size (TS)
MDRL	715215	Steel	63mm	9 mm	M9

ADDITIONAL PRODUCT DETAILS

MDRL is suitable for 19 mm and 22 mm nVent ERICO Ericontact sizes. MDRL135 and MDRL8 are for other nVent ERICO Ericontact types and require adaptors.

DIAGRAMS

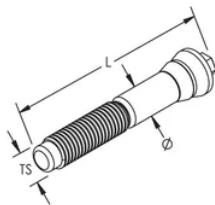

WARNING

nVent products shall be installed and used only as indicated in nVent's product instruction sheets and training materials. Instruction sheets are available at www.nvent.com and from your nVent customer service representative. Improper installation, misuse, misapplication or other failure to completely follow nVent's instructions and warnings may cause product malfunction, property damage, serious bodily injury and death and/or void your warranty.

North America

+1.800.753.9221

Option 1 – Customer Care

Option 2 – Technical

Support

Europe

Netherlands:

+31 800-0200135

France:

+33 800 901 793

Europe

Germany:

800 1890272

Other Countries:

+31 13 5835404

APAC

Shanghai:

+ 86 21 2412 1618/19

Sydney:

+61 2 9751 8500



Our powerful portfolio of brands:

CADDY

ERICO

HOFFMAN

ILSCO

SCHROFF

TRACHTE