

Compression Straight Lug, Bimetallic



FEATURES

Attaches aluminum cable to the rail web

Designed for electrical current carrying connections to rails

Permanent aluminium to copper assembly (press-forming), protected from corrosion using high quality inhibitor (green resin applied on edge of copper insert) applied during manufacturing stage

For connections of aluminium cables to DIN 48201, part 1

For round stranded and pre-rounded, sector-shaped conductors

Markings help ensure correct crimping

SPECIFICATIONS

Table 1/2

Catalog Number	Article Number	Material	Conductor Size	Hole Size (HS)	Length (L)	Width (W)
ALCUKS24012	717015	Aluminum, Copper	240 mm ² Stranded, 500 kcmil Stranded	13 mm	116mm	45 mm

Table 2/2

Catalog Number	Article Number	Tool/Die Type
ALCUKS24012	717015	M2M or M2H/RKM2, M3H or M3B/RKM3, MLB/RKML

DIAGRAMS

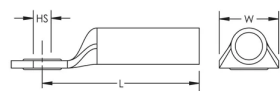

WARNING

nVent products shall be installed and used only as indicated in nVent's product instruction sheets and training materials. Instruction sheets are available at www.nvent.com and from your nVent customer service representative. Improper installation, misuse, misapplication or other failure to completely follow nVent's instructions and warnings may cause product malfunction, property damage, serious bodily injury and death and/or void your warranty.

North America

+1.800.753.9221
Option 1 – Customer Care
Option 2 – Technical
Support

Europe

Netherlands:
+31 800-0200135
France:
+33 800 901 793

Europe

Germany:
800 1890272
Other Countries:
+31 13 5835404

APAC

Shanghai:
+ 86 21 2412 1618/19
Sydney:
+61 2 9751 8500



Our powerful portfolio of brands:

CADDY ERICO HOFFMAN ILSCO SCHROFF TRACHTE