

PBF Two Hole Base Plate for Threaded Rod



FEATURES

Light duty with two holes and one nut/adaptor

SPECIFICATIONS

Table 1/2

Catalog Number	Article Number	Material	Finish	Rod Size (RS)	Length (L)	Width (W)
PBRM8M10L70 S6	587175	Stainless Steel 316 (EN 1.4401)		8, 10	70mm	33 mm
PBRM10L80	587135	Steel	Electrogalvaniz ed	10	80mm	30 mm
PBRM8M10L80	587145	Steel	Electrogalvaniz ed	8, 10	80mm	30 mm
PBRM10L120	587160	Steel	Electrogalvaniz ed	10	120mm	40 mm
PBRM12L120	587165	Steel	Electrogalvaniz ed	12	120mm	40 mm
PBRM8M10L12 0	587140	Steel	Electrogalvaniz ed	8, 10	120mm	40 mm

Table 2/2

Catalog Number	Article Number	Thickness (T)	A	B	C
----------------	----------------	---------------	---	---	---

PBRM8M10L70S6	587175	2 mm	48 mm	10 mm	8 mm
PBRM10L80	587135	3 mm	50 mm	18 mm	9 mm
PBRM8M10L80	587145	3 mm	50 mm	18 mm	9 mm
PBRM10L120	587160	4 mm	81 mm	18 mm	11 mm
PBRM12L120	587165	4 mm	81 mm	18 mm	11 mm
PBRM8M10L120	587140	4 mm	81 mm	18 mm	11 mm

DIAGRAMS

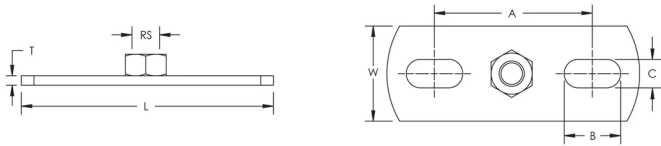

WARNING

nVent products shall be installed and used only as indicated in nVent's product instruction sheets and training materials. Instruction sheets are available at www.nvent.com and from your nVent customer service representative. Improper installation, misuse, misapplication or other failure to completely follow nVent's instructions and warnings may cause product malfunction, property damage, serious bodily injury and death and/or void your warranty.

North America

+1.800.753.9221
Option 1 – Customer Care
Option 2 – Technical
Support

Europe

Netherlands:
+31 800-0200135
France:
+33 800 901 793

Europe

Germany:
800 1890272
Other Countries:
+31 13 5835404

APAC

Shanghai:
+ 86 21 2412 1618/19
Sydney:
+61 2 9751 8500



Our powerful portfolio of brands:

CADDY ERICO HOFFMAN ILSCO SCHROFF TRACHTE

