

Heavy Duty Pipe Clamp



FEATURES

For high static requirements in industrial construction

Suitable for fix point applications

SPECIFICATIONS

Finish: Painted;Red Oxide

Material: Steel

Table 1/2

Catalog Number	Article Number	Outer Diameter (OD)	NB/DN	Hole Size (HS)	Screw Diameter (Sc)	Screw Length (L)
SSG022RO	574600	20.5 - 22 mm	15	6.6 mm	6 mm	20mm
SSG028RO	574610	26.5 - 28 mm	20	6.6 mm	6 mm	20mm
SSG035RO	574620	33 - 35 mm	25	11 mm	10 mm	40mm
SSG043RO	574630	40 - 43 mm	32	11 mm	10 mm	40mm
SSG049RO	574640	48 - 49 mm	40	11 mm	10 mm	40mm
SSG061RO	574650	57.0 - 60.3 mm	50	11 mm	10 mm	40mm

CatalogNumber	Article Number	Outer Diameter (OD)	NB/DN	Hole Size (HS)	ScrewDiameter (Sc)	Screw Length (L)
SSG077RO	574660	75 - 77 mm	65	11 mm	10 mm	40mm
SSG090RO	574670	88 - 90 mm	80	11 mm	10 mm	40mm
SSG115RO	574680	110 - 115 mm	100	18 mm	16 mm	60mm
SSG141RO	574685	139 - 141 mm	125	18 mm	16 mm	60mm
SSG170RO	574690	165 - 170 mm	150	18 mm	16 mm	60mm
SSG0359RO	574725	355 - 363 mm		22 mm	20 mm	80mm
SSG222RO	574700	216 - 222 mm	200	22 mm	20 mm	80mm
SSG276RO	574710	267 - 276 mm	250	22 mm	20 mm	80mm
SSG327RO	574720	321 - 327 mm	300	22 mm	20 mm	80mm
SSG410RO	574730	403 - 410 mm	400	26 mm	24 mm	80mm

Table 2/2

Catalog Number	Article Number	Static Load	Width (W)	Thickness (T)	A
SSG022RO	574600	1000N	23 mm	3 mm	46 mm
SSG028RO	574610	1000N	23 mm	3 mm	52 mm
SSG035RO	574620	1000N	40 mm	4 mm	71 mm
SSG043RO	574630	1000N	40 mm	4 mm	79 mm
SSG049RO	574640	1000N	40 mm	4 mm	85 mm
SSG061RO	574650	1800N	40 mm	4 mm	97 mm
SSG077RO	574660	1400N	40 mm	4 mm	113 mm

Catalog Number	Article Number	Static Load	Width (W)	Thickness (T)	A
SSG090R0	574670	1200N	40 mm	4 mm	126 mm
SSG115R0	574680	2900N	50 mm	6 mm	167 mm
SSG141R0	574685	2500N	50 mm	6 mm	193 mm
SSG170R0	574690	2200N	50 mm	6 mm	222 mm
SSG0359R0	574725	2600N	60 mm	8 mm	427 mm
SSG222R0	574700	3600N	60 mm	8 mm	290 mm
SSG276R0	574710	3100N	60 mm	8 mm	344 mm
SSG327R0	574720	2800N	60 mm	8 mm	395 mm
SSG410R0	574730	4100N	70 mm	10 mm	492 mm

ADDITIONAL PRODUCT DETAILS

Static load refers to a complete set of Heavy Duty Pipe Clamps held in place with indicated screws per ISO 4014 and corresponding hex nuts per ISO 4032 (for further information, please refer to Standard SSG 7075E).

DIAGRAMS

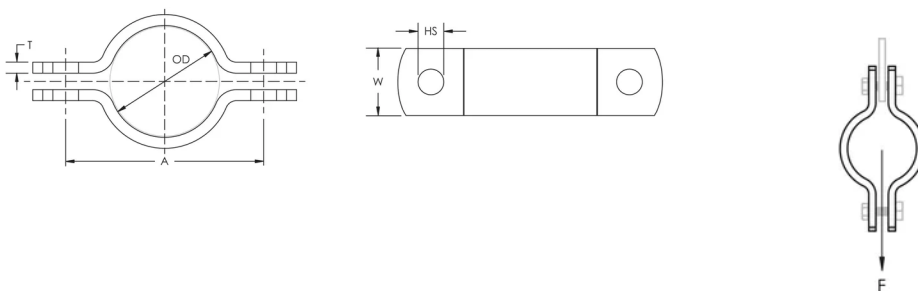

WARNING

nVent products shall be installed and used only as indicated in nVent's product instruction sheets and training materials. Instruction sheets are available at www.nvent.com and from your nVent customer service representative. Improper installation, misuse, misapplication or other failure to completely follow nVent's instructions and warnings may cause product malfunction, property damage, serious bodily injury and death and/or void your warranty.

North America

+1.800.753.9221

Option 1 – Customer Care

Option 2 – Technical

Support

Europe

Netherlands:

+31 800-0200135

France:

+33 800 901 793

Europe

Germany:

800 1890272

Other Countries:

+31 13 5835404

APAC

Shanghai:

+ 86 21 2412 1618/19

Sydney:

+61 2 9751 8500



Our powerful portfolio of brands:

CADDY

ERICO

HOFFMAN

ILSCO

SCHROFF

TRACHTE

