

Flexible Plastic Conduit and Pipe Clamp



FEATURES

Push-in installation of conduit

Flexible clamping design accommodates multiple conduit sizes using one clamp

Compatible with different structural attachment components to accommodate a variety of structures including concrete, brick, plywood, cable tray, spring steel fasteners and threaded rod

Snap-together clips can be easily assembled to limit the number of fixing points to structure

Low profile allows for installations in tight spaces

Non-flame propagating per IEC 61386-25

Passed 650°C glowing/hot-wire wire test per EN 60695-2

Suitable for insulated and non-insulated pipe applications

Push-in installation of conduit

Halogen free

UV-stabilized

Compliance to AS3500

Withstands up to 40kg of extraction force

SPECIFICATIONS

Material: Polypropylene

Temperature: -10 to 85 °C

Table 1/1

Catalog Number	Article Number	Outer Diameter (OD)	A	B
----------------	----------------	---------------------	---	---

SCFC1620	800020	16 - 20 mm	32 mm	16 - 18 mm
SCFC2025	800021	20 - 25 mm	32 mm	18.0 - 20.5 mm
SCFC2532	800022	25 - 32 mm	32 mm	20.5 - 24 mm
SCFC3240	800023	32 - 40 mm	32 mm	24 - 28 mm
SCFC4050	800024	40 - 50 mm	32 mm	28 - 33 mm

DIAGRAMS

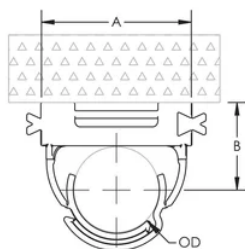

WARNING

nVent products shall be installed and used only as indicated in nVent's product instruction sheets and training materials. Instruction sheets are available at www.nvent.com and from your nVent customer service representative. Improper installation, misuse, misapplication or other failure to completely follow nVent's instructions and warnings may cause product malfunction, property damage, serious bodily injury and death and/or void your warranty.

North America

+1.800.753.9221

Option 1 – Customer Care

Option 2 – Technical

Support

Europe

Netherlands:

+31 800-0200135

France:

+33 800 901 793

Europe

Germany:

800 1890272

Other Countries:

+31 13 5835404

APAC

Shanghai:

+ 86 21 2412 1618/19

Sydney:

+61 2 9751 8500



Our powerful portfolio of brands:

CADDY

ERICO

HOFFMAN

ILSCO

SCHROFF

TRACHTE

