

Basic Plastic Conduit Clip



FEATURES

Push-in installation of conduit

Compatible with plastic Push-In Insert or with a simple screw to easily accommodate a variety of structures including concrete, brick, metal decks and plywood

Snap-together clips can be easily assembled to limit the number of fixing points to structure

Non-flame propagating per IEC 61386-25

Passed 650°C glowing/hot-wire wire test per EN 60695-2

Halogen free

UV-stabilized

SPECIFICATIONS

Material: Polypropylene

Temperature: -10 to 85 °C

Table 1/1

| Catalog Number | Article Number | Outer Diameter (OD) | A | B | C |
|----------------|----------------|---------------------|-------|-------|-------|
| SCBC16 | 800012 | 16 mm | 21 mm | 25 mm | 18 mm |
| SCBC20 | 800013 | 20 mm | 26 mm | 29 mm | 19 mm |
| SCBC25 | 800014 | 25 mm | 32 mm | 34 mm | 22 mm |

| Catalog Number | Article Number | Outer Diameter (OD) | A | B | C |
|----------------|----------------|---------------------|-------|-------|-------|
| SCBC32 | 800015 | 32 mm | 40 mm | 41 mm | 26 mm |
| SCBC40 | 800016 | 40 mm | 50 mm | 49 mm | 30 mm |
| SCBC50 | 800017 | 50 mm | 62 mm | 59 mm | 35 mm |

DIAGRAMS

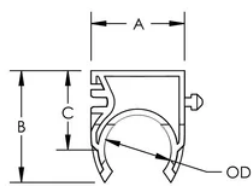

WARNING

nVent products shall be installed and used only as indicated in nVent's product instruction sheets and training materials. Instruction sheets are available at www.nvent.com and from your nVent customer service representative. Improper installation, misuse, misapplication or other failure to completely follow nVent's instructions and warnings may cause product malfunction, property damage, serious bodily injury and death and/or void your warranty.

North America

+1.800.753.9221
 Option 1 – Customer Care
 Option 2 – Technical Support

Europe

Netherlands:
 +31 800-0200135
 France:
 +33 800 901 793

Europe

Germany:
 800 1890272
 Other Countries:
 +31 13 5835404

APAC

Shanghai:
 + 86 21 2412 1618/19
 Sydney:
 +61 2 9751 8500



Our powerful portfolio of brands:

CADDY ERICO HOFFMAN ILSCO SCHROFF TRACHTE

