

# 406 Clevis Hanger, Stainless Steel



## CERTIFICATIONS



## FEATURES

Recommended for the suspension of stationary non-insulated stainless steel pipe lines

Conforms with U.S. Federal Specification WW-H-171 (Type 1), Manufacturers Standardization Society (MSS) SP-58 (Type 1)

## SPECIFICATIONS

**Material:** Stainless Steel 304 (EN 1.4301)

Table 1/2

Catalog Number	NB/DN	Outer Diameter (OD)	Rod Size (RS)	A	B	C
4060050S4	15	21 mm	M10	54 mm	26.4 mm	6.2 mm
4060075S4	20	27 mm	M10	60 mm	29.8 mm	10.2 mm
4060100S4	25	34 mm	M10	71 mm	37.4 mm	14.2 mm

CatalogNumber	NB/DN	Outer Diameter (OD)	Rod Size (RS)	A	B	C
4060125S4	32	43 mm	M10	84 mm	46 mm	17.7 mm
4060150S4	40	48 mm	M10	101 mm	60 mm	27.7 mm
4060200S4	50	76 mm	M12	114 mm	66.7 mm	28.7 mm
4060250S4	65	76 mm	M12	134 mm	76.2 mm	27.7 mm
4060300S4	80	89 mm	M12	153 mm	87.3 mm	22.2 mm
4060350S4	90	101.6 mm	M12	165 mm	93 mm	35 mm
4060400S4	100	114 mm	M16	197 mm	117.6 mm	45 mm
4060500S4	125	140 mm	M16	248 mm	143.2 mm	54.9 mm
4060600S4	150	165 mm	M20	299 mm	178.7 mm	68.8 mm
4060800S4	200	219 mm	M20	356 mm	204 mm	80 mm
4061000S4	250	273 mm	M20	419 mm	229.5 mm	65.7 mm
4061200S4	300	324 mm	M20	473 mm	258.1 mm	78.4 mm

Table 2/2

Catalog Number	Static Load	Certifications
4060050S4	2700N	
4060075S4	2700N	
4060100S4	2700N	
4060125S4	2700N	
4060150S4	2700N	

Catalog Number	Static Load	Certifications
4060200S4	5000N	
4060250S4	5000N	FM Approved, Pipe Hanger Components
4060300S4	5000N	FM Approved, Pipe Hanger Components
4060350S4	5000N	FM Approved, Pipe Hanger Components
4060400S4	5000N	FM Approved, Pipe Hanger Components
4060500S4	6400N	FM Approved, Pipe Hanger Components
4060600S4	8600N	FM Approved, Pipe Hanger Components
4060800S4	8900N	FM Approved, Pipe Hanger Components
4061000S4	16000N	
4061200S4	17000N	

## DIAGRAMS

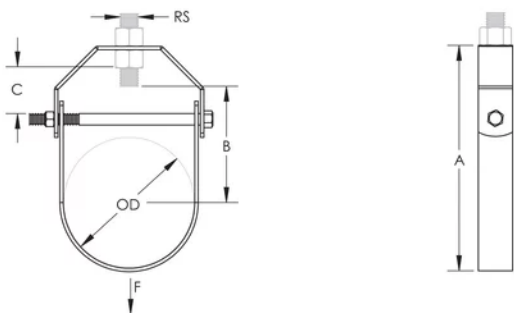

## WARNING

nVent products shall be installed and used only as indicated in nVent's product instruction sheets and training materials. Instruction sheets are available at [www.nvent.com](http://www.nvent.com) and from your nVent customer service representative. Improper installation, misuse, misapplication or other failure to completely follow nVent's instructions and warnings may cause product malfunction, property damage, serious bodily injury and death and/or void your warranty.

#### North America

+1.800.753.9221

Option 1 – Customer Care

Option 2 – Technical

Support

#### Europe

Netherlands:

+31 800-0200135

France:

+33 800 901 793

#### Europe

Germany:

800 1890272

Other Countries:

+31 13 5835404

#### APAC

Shanghai:

+ 86 21 2412 1618/19

Sydney:

+61 2 9751 8500



Our powerful portfolio of brands:

**CADDY**

**ERICO**

**HOFFMAN**

**ILSCO**

**SCHROFF**

**TRACHTE**

