

# Graphite Plate



## FEATURES

Used to prevent burn-through and leakage in the welding process

See specific nVent ERICO Cadweld mold requirements for the required graphite plate

## SPECIFICATIONS

**Material:** Graphite

Table 1/1

Catalog Number	Width (W)	Depth (D)	Height (H)	Hole Quantity	Hole Size (HS)
A170A04	152.4 mm	101.6mm	19.05 mm	0	
A170A11	50.8 mm	50.8mm	19.05 mm	0	
A170A44	177.8 mm	76.2mm	25.4 mm	0	
DFWFT	152.4 mm	50.8mm	50.8 mm	0	
A170A15	88.9 mm	88.9mm	15.9 mm	4	14.3 mm

DIAGRAMS

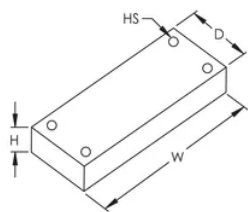

WARNING

nVent products shall be installed and used only as indicated in nVent's product instruction sheets and training materials. Instruction sheets are available at [www.nvent.com](http://www.nvent.com) and from your nVent customer service representative. Improper installation, misuse, misapplication or other failure to completely follow nVent's instructions and warnings may cause product malfunction, property damage, serious bodily injury and death and/or void your warranty.

North America

+1.800.753.9221  
Option 1 – Customer Care  
Option 2 – Technical  
Support

Europe

Netherlands:  
+31 800-0200135  
France:  
+33 800 901 793

Europe

Germany:  
800 1890272  
Other Countries:  
+31 13 5835404

APAC

Shanghai:  
+ 86 21 2412 1618/19  
Sydney:  
+61 2 9751 8500



Our powerful portfolio of brands:

CADDY   ERICO   HOFFMAN   ILSCO   SCHROFF   TRACHTE